

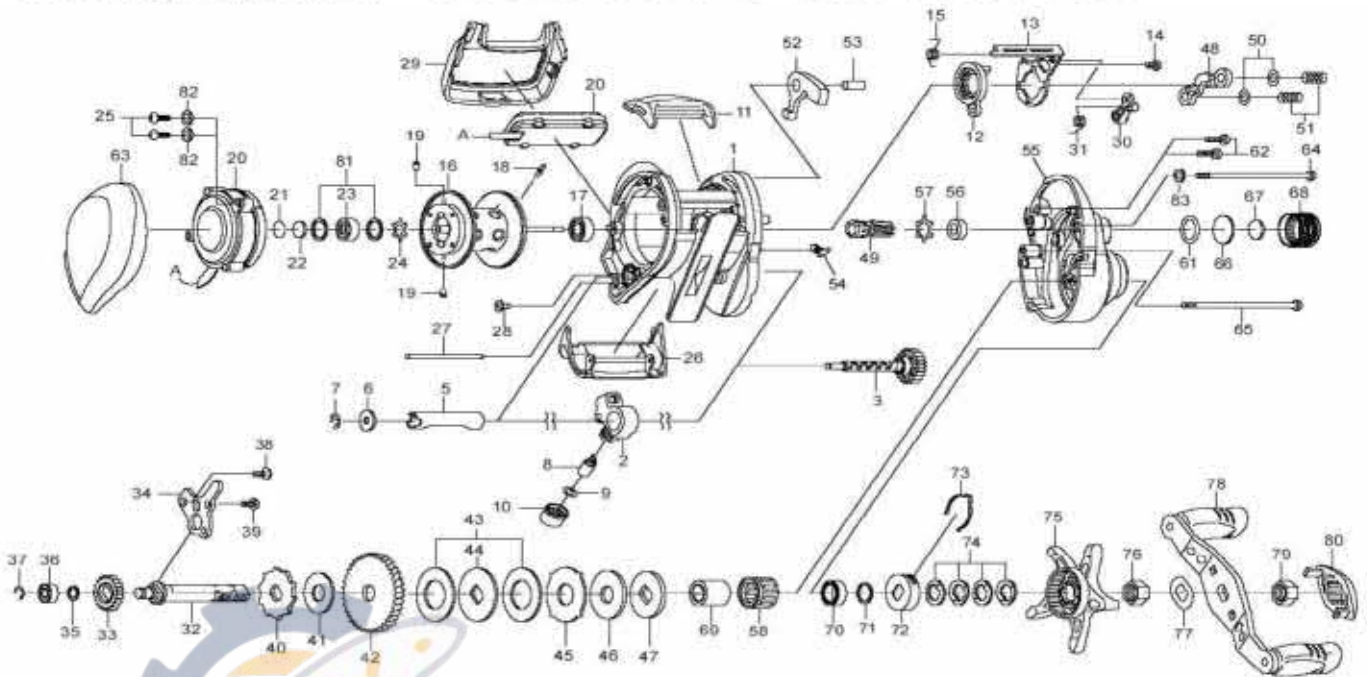

Please order by parts number, not key number
Veuillez indiquer le numéro de la pièce (Non "Key" No.)

CONVENTIONAL REEL **ACCUDEPTH ICV15**



Key No.	Parts No.	Parts Name	Key No.	Parts No.	Parts Name
1	H13-8103	FRAME	42	H13-9601	DRIVE GEAR
2	H00-1703	LEVELWIND	43	F79-6102	EARED WASHER(A)
3	G93-9901	WORM SHAFT	44	H19-0001	DRAG DISC WASHER(A)
4	G05-1701	WORM SHAFT BUSHING	45	F79-6303	DRAG LIP WASHER
5	G93-4201	WORM SHIELD	46	H19-7601	EARED WASHER(B)
6	F65-5501	WORM SHAFT WASHER	47	B36-0306	DRAG DISC WASHER(B)
7	320-5901	WORM SHAFT RETAINER	48	G93-3501	YOKE
8	F51-6501	LEVELWIND PAWL	49	H13-9701	PINION GEAR
9	373-1300	LEVELWIND WASHER	50	B41-1706	YOKE WASHER
10	F40-2801	LEVELWIND NUT	51	G85-0301	YOKE SPRING
11	G93-1802	CLUTCH LEVER	52	H13-9801	CLUTCH CAM LEVER
12	G93-1601	CLUTCH CAM	53	G08-2301	CLUTCH CAM LEVER PAWL
13	G93-1901	CLUTCH CAM PLATE	54	E16-9504	LINE HOLDER
14	G19-3701	CLUTCH CAM PLATE SCREW	55	H14-0006	R/S PLATE
15	G93-1701	CLUTCH CAM SPRING	56	H14-0201	BUSHING
16	H13-8303	SPOOL	57	H18-0501	BUSHING RETAINER
17	G49-8503	SPOOL BALL BEARING	58	F55-2704	ONE-WAY CLUTCH
18	H14-4301	SPOOL PAWL	61	B05-5201	MECHANICAL BRAKE O RING
19	B35-2901	BRAKE COLLAR	62	G27-0901	R/S PLATE SCREW(A)
20	H36-5007	IC MODULE	63	H14-0305	L/S PLATE
21	375-7404	L/S BUSHING WASHER(A)	64	H56-7301	R/S PLATE SCREW(B)
22	375-7411	L/S BUSHING WASHER(B)	65	H56-7401	R/S PLATE SCREW(C)
23	E08-8005	L/S BALL BEARING	66	375-7501	MECHANICAL BRAKE WASHER(A)
24	H36-5601	L/S BUSHING RETAINER	67	B17-5503	MECHANICAL BRAKE WASHER(B)
25	G11-5001	IC MODULE SCREW	68	H21-3602	BRAKE ADJ KNOB
26	H13-9401	FINGER COVER	69	G93-4802	CLUTCH COLLAR
27	H00-2401	PAWL	70	B86-1704	HANDLE BUSHING
28	G93-9301	PAWL SCREW	71	B55-3801	HANDLE BUSHING WASHER
29	H13-9303	PALMING PLATE	72	F02-8201	DRAG HOLDER
30	G93-2001	KICK LEVER	73	F03-2401	DRAG HOLDER LEAF SPRING
31	G93-2101	KICK LEVER SPRING	74	150-8901	DRAG SPRING WASHER
32	H13-9501	DRIVE SHAFT	75	H00-2115	STAR DRAG
33	G93-2201	WORM SHAFT GEAR	76	F84-9903	DRAG NUT
34	G93-2401	DRIVE SHAFT PLATE	77	150-9001	HANDLE WASHER
35	E09-6501	WORM SHAFT GEAR WASHER	78	H49-0501	HANDLE
36	E35-1501	DRIVE SHAFT BUSHING	79	F84-9903	HANDLE NUT
37	320-8002	DRIVE SHAFT RETAINER	80	G96-9902	HANDLE CAP
38	G19-3701	DRIVE SHAFT PLATE SCREW(A)	81	375-3003	L/S BUSHING WASHER(C)
39	G17-1402	DRIVE SHAFT PLATE SCREW(A)	82	B53-6104	IC MODULE SCREW WASHER
40	G93-4301	RATCHET	83	B53-6104	R/S PLATE SCREW(B) WASHER
41	G93-4401	DRIVE GEAR WASHER			