

# Daiwa

COMMITTED TO TOTAL QUALITY

## SPINNING REEL

# EMCAST Plus 5500/6000

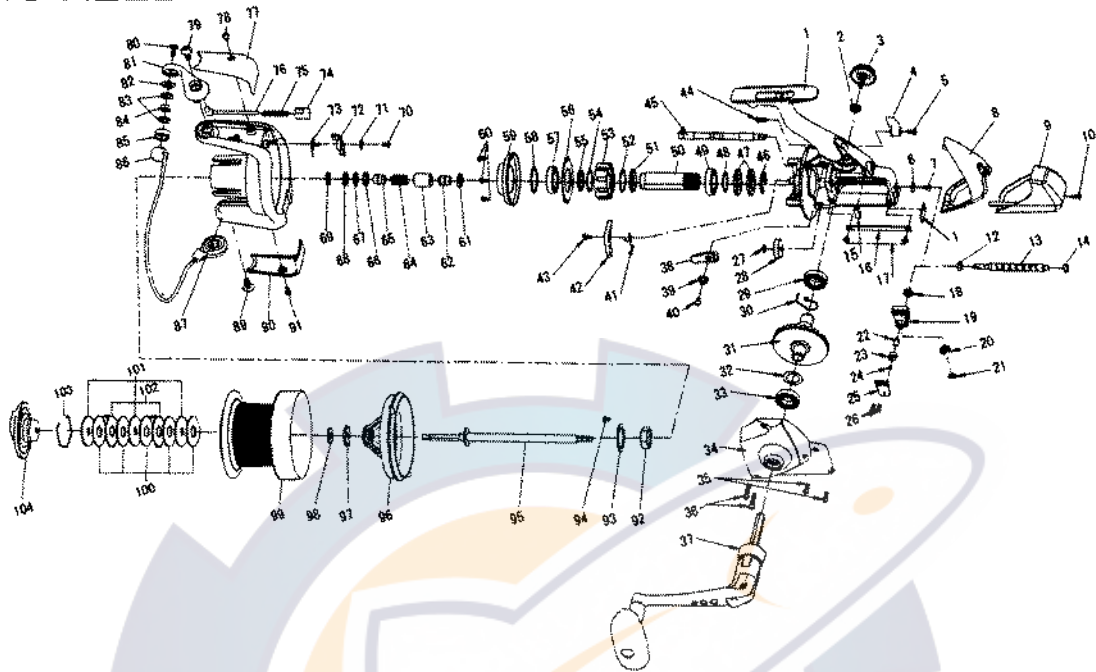

Key No.	Parts No.	Parts Name
1	W36-0001	BODY
2	W36-0101	HANDLE WASHER
3	W36-0201	HANDLE SCREW
4	W36-0301	A/R LEVER
5	W36-0401	A/R LEVER SCREW
6	W36-0501	BALL BEARING RET
7	W36-0601	BALL BEARING SCREW
8	W36-0701	REAR COVER A
9	W36-0801	REAR COVER B
10	W36-0901	REAR COVER SCREW A
11	W36-1001	WORM SHAFT RET A
12	W36-1101	WORM SHAFT BUSH
13	W36-1201	WORM SHAFT
14	W36-1301	BALL BEARING A
15	W36-1401	A/R CAM SPRING
16	W36-1501	STABILIZER BAR
17	W36-1601	STABILIZER BAR SCREW
18	W36-1701	BALL BEARING B
19	W36-1801	OSC SLIDER
20	W36-1901	BALL BEARING C
21	W36-2001	BEARING RET B
22	W36-2101	OSC PAWL
23	W36-2201	OSC PAWL COLLAR
24	W36-2301	OSC PAWL WASHER
25	W36-2401	OSC SLIDER COVER
26	W36-2501	OSC SLIDER COVER SCREW
27	W36-2601	WORM SHAFT RET B
28	W36-2701	WORM SHAFT GEAR
29	W42-9301	BALL BEARING D
30	W36-2901	A/R PAWL SPRING A
31	W36-3001	DRIVE GEAR
32	W36-3101	DRIVE GEAR WASHER
33	W42-9301	BALL BEARING E
34	W36-3201	SIDE COVER
35	W36-3301	SIDE COVER SCREW A
36	W36-3401	SIDE COVER SCREW B
37	W36-3501	HANDLE
38	W36-3601	A/R PAWL A
39	W36-3701	A/R PAWL COLLAR
40	W36-3801	A/R PAWL RET
41	W36-3901	A/R PAWL SPRING B
42	W36-4001	A/R PAWL B
43	W36-4101	A/R PAWL B SCREW
44	W36-4201	REAR COVER SCREW B
45	W36-4301	A/R CAM
46	W36-4401	PINION RET
49	W36-4701	BALL BEARING F
50	W36-4801	PINION GEAR
51	W36-4901	PINION COLLAR
52	W36-5001	PINION WASHER
53	W36-5101	ROLLER CLUTCH
54	W36-5201	ROLLER CLUTCH WASHER
55	W36-5301	ROLLER CLUTCH COLLAR
56	W36-5401	ROLLER CLUTCH RET

Key No.	Parts No.	Parts Name
57	W42-9201	BALL BEARING G
58	W36-5501	BALL BEARING RET WASHER
59	W36-5601	BEARING RET
60	W36-5701	BEARING RET SCREW
61	W36-5801	BALL BEARING H
62	W36-5901	BALL BEARING COLLAR A
63	W36-6001	SPACING SLEEVE
64	W36-6101	MAIN SHAFT SPRING A
65	W36-6201	BALL BEARING COLLAR B
66	W36-5801	BALL BEARING I
67	W36-6301	BALL BEARING WASHER A
68	W36-6401	BALL BEARING WASHER B
69	W36-6501	MAIN SHAFT SPRING B
70	W36-6601	BAIL TRIP LEVER SCREW
71	W31-1801	BAIL TRIP LEVER WASHER
72	W36-6801	BAIL TRIP LEVER
73	W36-6901	BAIL TRIP LEVER SPRING
74	W36-7001	BAIL SPRING HOLDER
75	W36-7101	BAIL SPRING
76	W36-7201	BAIL SPRING SHAFT
77	W36-7301	BAIL SPRING COVER
78	W36-7401	BAIL SPRING COVER SCREW
79	W36-7501	BAIL ARM SCREW
80	W36-7601	LINE ROLLER SCREW
81	W36-7701	BAIL ARM
82	W30-6201	LINE ROLLER WASHER B
83	W30-6101	LINE ROLLER WASHER A
84	W42-9401	BALL BEARING J
85	W36-8101	LINE ROLLER
86	W36-8201	BAIL
87	W36-8301	ROTOR
89	W36-8401	BAIL HOLDER SCREW
90	W36-8501	BAIL HOLDER COVER
91	W36-8601	BAIL HOLDER COVER SCREW
92	W36-8701	ROTOR NUT
93	W36-8801	ROTOR NUT HOLD PLT
94	W36-8901	ROTOR NUT HOLD PLT SCREW
95	W36-9001	MAIN SHAFT
96	W36-9101	LINE GUARD
97	W36-9201	CLICK GEAR
98	W36-9301	CLICK GEAR WASHER
99-103	W36-9402	SPOOL
99-103	W36-9404	SPOOL (EXTRA)
100	W36-9601	DRAG WASHER
101	W36-9701	KEY WASHER
102	W36-9801	EARED WASHER
103	W36-9901	DRAG WASHER RET
104	W36-9501	DRAG KNOB

**SPECIAL PART FOR ECP6000**

Key No.	Parts No.	Parts Name
99-103	W36-9412	SPOOL
99-103	W36-9414	SPOOL (EXTRA)