

Please order by parts number, not key number
 Veuillez indiquer le numéro de la pièce (Non "Key" No.)

DAIWA BAITCASTING REEL

LAGUNA 100H/100HS

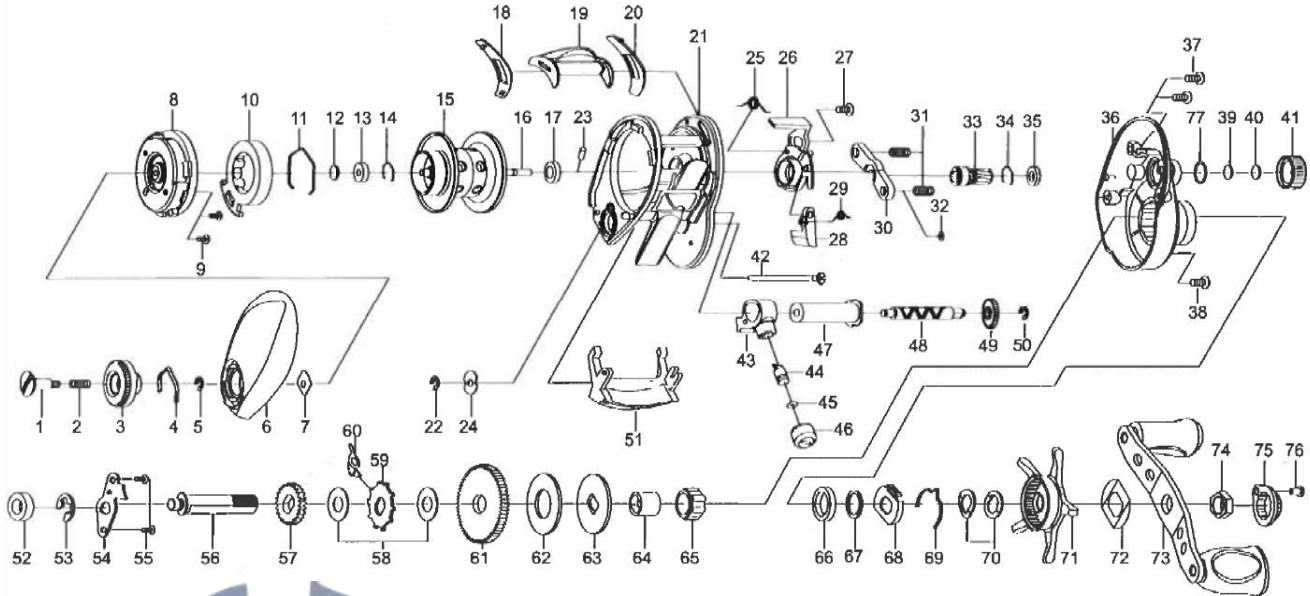

Key No.	Parts No.	Parts Name	Key No.	Parts No.	Parts Name
1	460-5420	Set plate screw (S)	48	470-1900	Worm shaft
2	510-4450	Set plate spring	49	240-2180	Worm shaft gear
3	550-1610	Brake adjusting knob (S)	50	200-0530	Gear retainer
4	510-5060	Brake click spring	51	550-1600	Front plate
5	200-0530	Brake dial retainer (A)	52	140-1280	Ball Bearing (C)
6	230-2270	Left side plate	53	200-0580	Drive gear shaft retainer (B)
7	410-1911	Brake dial retainer (B)	54	410-2210	Drive gear shaft retainer (A)
8	220-2931	Left set plate	55	460-4600	Drive shaft retainer screw
9	460-3220	Left set plate screw	56	470-1890	Drive shaft
10	240-1952	Magnet holder	57	240-2190	Drive Gear A
11	430-1070	Magnet holder ret	58	540-6840	Spacer (F)
12	540-5990	Spacer(A)	59	240-2530	Anti-reverse ratchet
13	140-1400	Ball bearing (A)	60	530-0840	Anti-reverse pawl
14	430-1061	Bearing retainer	61	250-1310	Drive gear
15-17,23	700-9160	Spool assembly	62	540-6870	Drag washer
18	410-2150	Spacer (B)	63	540-6900	Key washer
19	090-0260	Clutch lever	64	150-2180	Gear shaft collar
20	410-2140	Spacer (C)	65	140-1810	Roller Clutch
21	110-0940	Frame assembly	66	140-1830	Ball Bearing (D)
22	200-0530	Worm shaft retainer	67	540-1480	Spacing washer
23	400-2250	Spool Pin	68	410-2220	Click leaf spring holder
24	540-6060	Worm shaft washer	69	510-4760	Leaf spring (A)
25	510-5040	Clutch cam spring (A)	70	540-6390	Drag spring washer
26	170-1280	Clutch cam	71	320-1150	Star drag
27	460-5440	clutch cam screw	72	510-3260	Leaf spring (B)
28	330-2820	Clutch trip plate	73	700-8390	Handle assembly (S)
29	510-5050	Clutch cam spring (B)	74	380-0770	Handle nut
30	410-1890	Pinion yoke	75	180-2470	Handle nut plate (S)
31	510-4430	Yoke spring	76	460-0450	Handle nut plate screw
32	540-6020	Washer (B)	77	430-1080	O Ring
33	260-1670	Pinion gear			
34	430-1061	Bearing retainer			
35	140-1820	Ball bearing (B)			
36	230-2260	Right side plate			
37	460-1570	R/S plt screw			
38	460-5450	R/S plt screw (A)			
39	540-6850	Spacer (D)			
40	540-4340	Spacer (E)			
41	380-1660	Cast control cap (S)			
42	400-2531	Long screw			
43	490-1080	Line guide			
44	400-2540	Line guide pawl			
45	540-3980	Washer (C)			
46	380-0780	Nut			
47	270-0720	Level wind guard			

LAGUNA 100HS SPECIAL PARTS		
Key No.	Parts No.	Parts Name
1	460-5410	Set plate screw
3	550-1611	Brake adjusting knob (G)
15-17,23	700-9170	Spool assembly
19	090-0261	Clutch lever (G)
33	260-1680	Pinion gear
36	230-2261	Right side plate
41	380-1661	Cast control cap
51	550-1601	Front plate
61	250-1320	Drive gear
73	700-8400	Handle assembly (G)
75	180-2471	Handle nut plate (G)