

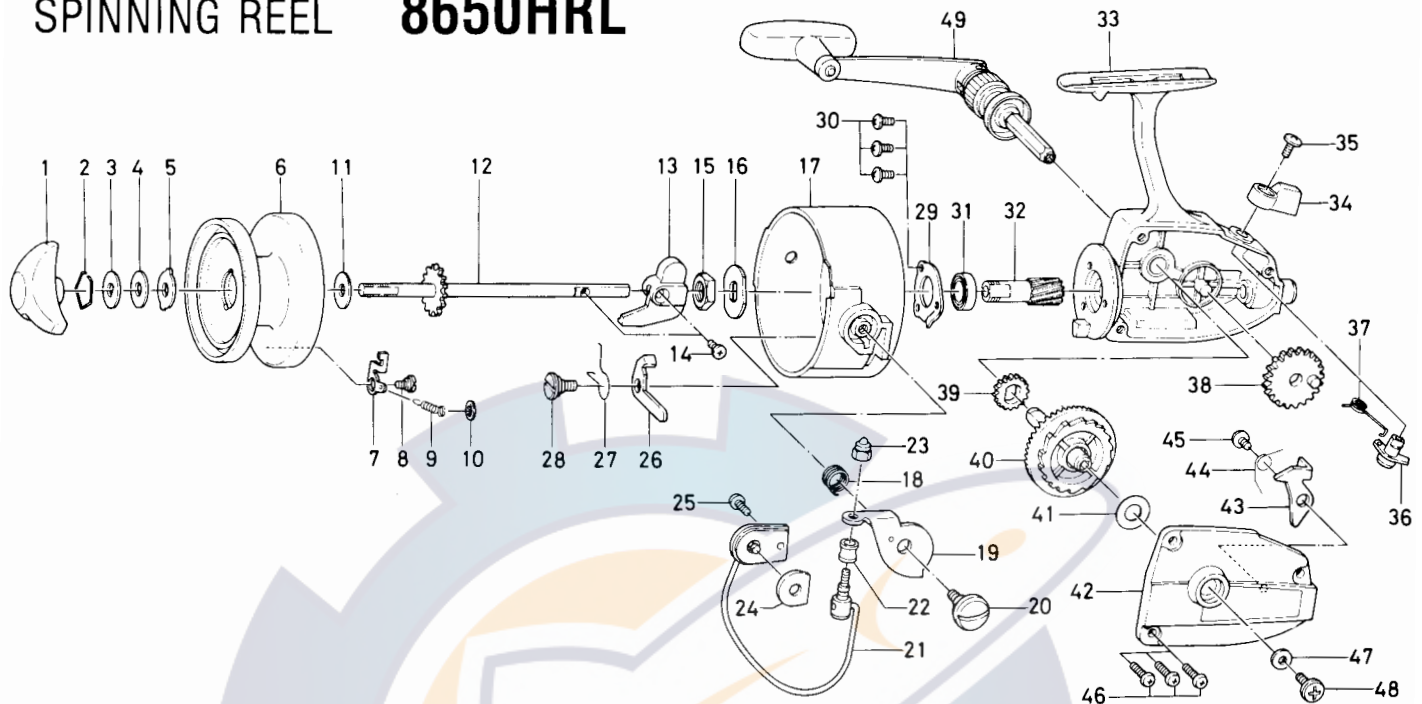

SPINNING REEL 8650HRL



Key No. 2 ~ 10
6-734-2701

Spool assembly \$3.95

| Key No. | Parts No. | Parts Name | Price Per Piece | Key No. | Parts No. | Parts Name | Price Per Piece |
|---------|------------|----------------------------------|-----------------|---------|------------|--------------------------------|-----------------|
| 1 | 6-005-1805 | Drag knob | \$1.50 | 26 | 6-570-6821 | Bail kick lever | \$.80 |
| 2 | 6-170-4001 | Drag washer retainer | .15 | 27 | 6-140-6231 | Bail kick lever spring | .15 |
| 3 | 6-372-0801 | Drag D washer | .45 | 28 | 6-363-1501 | Bail kick lever screw | .25 |
| 4 | 6-370-6901 | Disc washer | .15 | 29 | 6-351-6102 | Ball bearing ret. washer screw | .15 |
| 5 | 6-372-4701 | Drag A washer | .15 | 30 | 6-320-6201 | Ball bearing ret. washer | .45 |
| 6 | 6-734-2601 | Spool | See Assy. | 31 | 6-635-5001 | Ball bearing | 5.90 |
| 7 | 6-030-6802 | Spool click claw | .25 | 32 | 6-401-4901 | Pinion gear | 1.75 |
| 8 | 6-363-8401 | Spool click claw screw | .20 | 33 | 6-700-0425 | Body | 5.50 |
| 9 | 6-140-2221 | Spool click claw spring | .15 | 34 | 6-540-3711 | Anti-reverse lever | .35 |
| 10 | 6-320-9701 | Spool click claw spring retainer | .15 | 35 | 6-350-1931 | Anti-reverse lever screw | .15 |
| 11 | 6-371-2731 | Spool washer | .15 | 36 | 6-460-6821 | Anti-reverse cam | .20 |
| 12 | 6-710-0711 | Main shaft | 1.00 | 37 | 6-142-2801 | Anti-reverse cam spring | .15 |
| 13 | 6-480-6911 | Oscillating slider | .45 | 38 | 6-412-1411 | Oscillating gear | 1.00 |
| 14 | 6-351-8901 | Oscillating slider screw | .15 | 39 | 6-401-1701 | Oscillating pinion | .80 |
| 15 | 6-340-8301 | Rotor nut | .20 | 40 | 6-412-1501 | Drive gear | 2.95 |
| 16 | 6-372-4901 | Rotor retaining washer | .25 | 41 | 6-370-7510 | Drive gear washer | .15 |
| 17 | 6-201-7311 | Rotor | 4.15 | 42 | 6-705-0213 | Body cover | 2.20 |
| 18 | 6-141-2801 | Bail spring | .15 | 43 | 6-110-8511 | Anti-reverse claw | .20 |
| 19 | 6-230-8411 | Arm lever | .60 | 44 | 6-142-8001 | Anti-reverse claw spring | .15 |
| 20 | 6-361-6413 | Arm lever screw | .70 | 45 | 6-350-2621 | Anti-reverse claw screw | .15 |
| 21 | 6-725-2821 | Bail | 2.85 | 46 | 6-351-8501 | Body cover screw | .15 |
| 22 | 6-250-2801 | Line roller | .45 | 47 | 6-371-9521 | Handle washer | .15 |
| 23 | 6-340-8501 | Bail nut | .45 | 48 | 6-351-3631 | Handle screw | .25 |
| 24 | 6-210-4301 | Balancer | .35 | 49 | 6-745-0541 | Handle | 4.80 |
| 25 | 6-351-6401 | Bail holder screw | .15 | | | | |