



## Rod Holder Instructions Item 200067 (2990)

Tools needed:

7/16" Wrench

Phillips Screw Driver or Drill/Driver with Phillips bit

1. Attach rod holder bracket to fish house frame bracket using the machine screws. The washer and nylock nut go on the backside. The bracket can also be mounted to any flat surface. Substitute wood screws (not included) for the machine screws when attaching to a wooden surface.

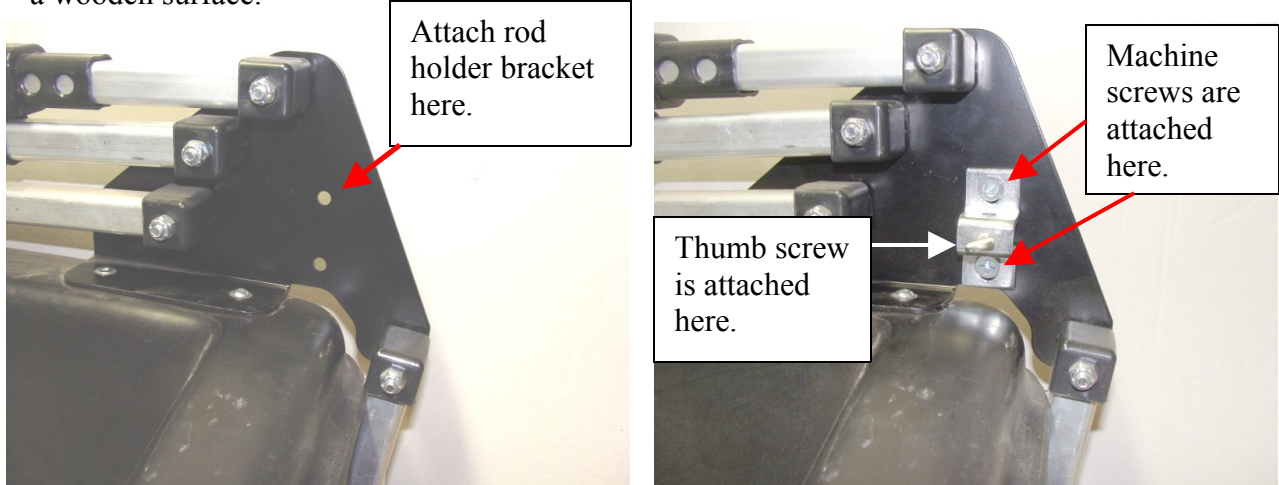

2. Insert rod holder into bracket. Adjust the tension of the rod holder with the thumb screw. The tension at the joint may also be adjusted by tightening or loosening the machine screw. Installation is complete.

