

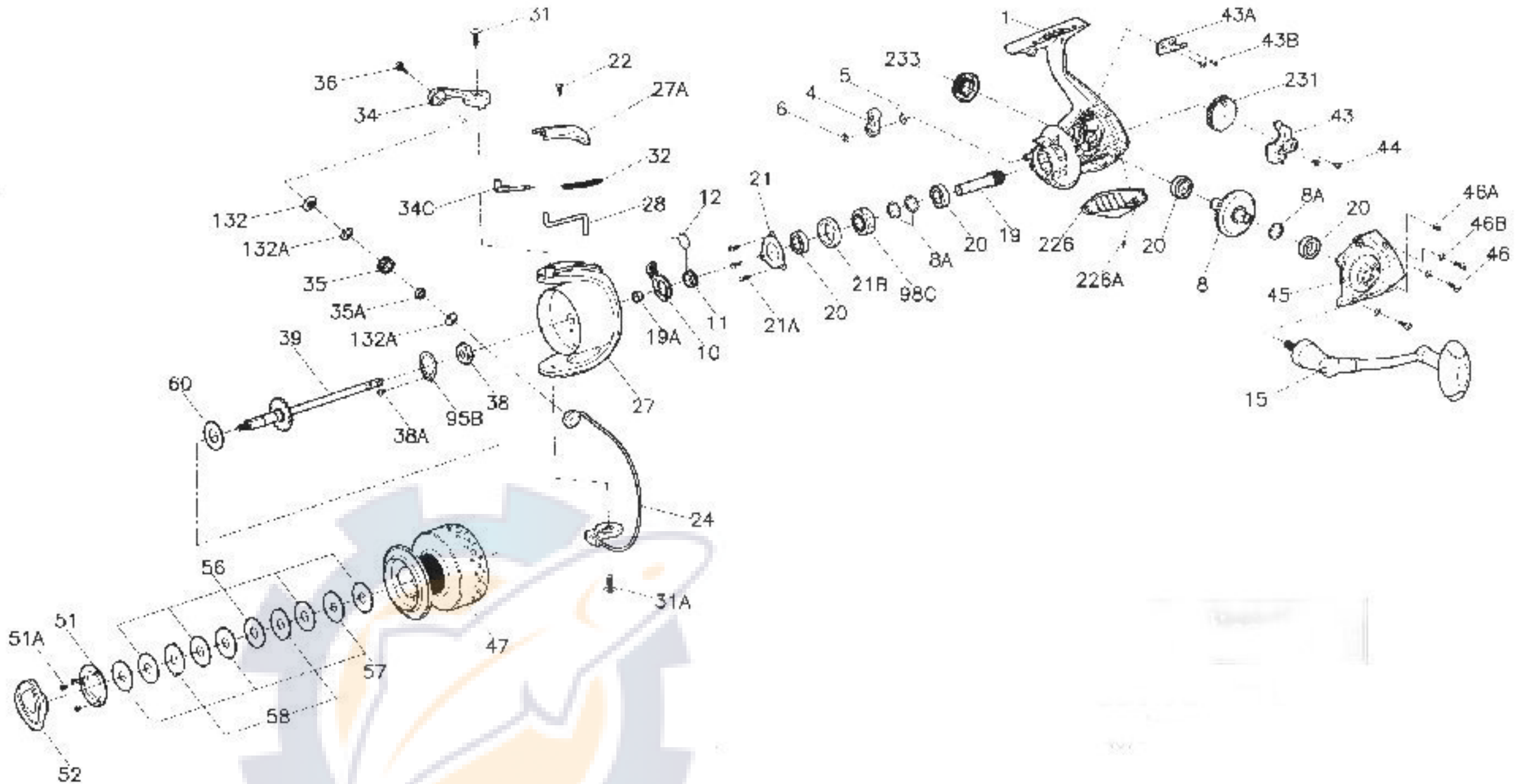

# PARTS LIST FOR MODEL SG6000



## Penn Reel Parts list for:

## Model: SG6000 Sargus Spinning Series

KEY NO	PART NO.	DESCRIPTION
1	1-6000SG	HOUSING
4	4-5000SG	A/R DOG
5	5-5000SG	A/R DOG SPRING
6	6-5000SG	RETAINING CLIP
8	8-5000SG	MAIN GEAR ASSEMBLY
8A	8A-5000SG	MAIN GEAR SHIM
10	10-5000SG	A/R HOLDER
11	11-5000SG	BUSHING
12	12-5000SG	A/R BUSHING SPRING
15	15-5000SG	HANDLE ASSEMBLY
19	19-5000SG	PINION GEAR
19A	19A-5000SG	PINION BUSHING (2 REQUIRED)
20	20-5000SG	BALL BEARING (4 REQUIRED)
21	21-5000SG	BEARING RETAINER
21A	21A-5000SG	BEARING RETAINER SCREW (3 REQUIRED)
21B	21B-5000SG	COLLAR
22	22-5000SG	BAIL ARM COVER SCREW
24	24-6000SG	BAIL WIRE
27	27-6000SG	ROTOR CUP
27A	27A-5000SG	BAIL PIVOT COVER
28	28-5000SG	TRIP LEVER
31	31-5000SG	BAIL ARM SCREW
31A	31A-5000SG	BAIL CAM SCREW
32	32-5000SG	BAIL SPRING
34	34-5000SG	BAIL ARM
34C	34C-5000SG	PIVOT ARM
36	36-5000SG	LINE ROLLER
35A	35A-3000SG	LINE ROLLER BEARING

KEY NO	PART NO.	DESCRIPTION
36	36-5000SG	BAIL STUD SCREW
38	38-5000SG	ROTOR NUT
38A	38A-5000SG	ROTOR LOCKING PLATE SCREW
39	39-5000SG	SPOOL SHAFT
43	43-5000SG	CROSSWIND BLOCK
43A	43A-5000SG	CROSSWIND BLOCK PLATE
43B	43B-5000SG	CROSSWIND BLOCK PLATE SCREW
44	44-5000SG	CROSSWIND BLOCK SCREW
45	45-6000SG	HOUSING COVER
46	46-5000SG	HOUSING COVER SCREW (3 REQUIRED)
46A	46A-3000SG	HOUSING COVER SCREW A
46B	46B-5000SG	HOUSING COVER WASHER (3 REQUIRED)
47	47-6000SG	SPOOL ASSEMBLY
51	51-5000SG	RETAINING SPACER
51A	51A-3000SG	RETAINING SCREW (3 REQUIRED)
52	52-5000SG	DRAG KNOB
56	56-5000SG	DRAG WASHER HT100 (3 REQUIRED)
57	57-5000SG	KEYED DRAG WASHER (2 REQUIRED)
58	58-5000SG	EARRED DRAG WASHER
60	60-5000SG	THRUST WASHER
95B	95B-5000SG	ROTOR LOCKING PLATE
98C	98C-5000SG	CLUTCH/SLEEVE ASSEMBLY
132	132-5000SG	ROLLER WASHER
132A	132A-3000SG	LINE ROLLER WASHER
226	226-5000SG	REAR COVER
226A	226A-3000SG	REAR COVER SCREW
231	231-5000SG	CROSSWIND BEARING
233	233-5000SG	BEARING COVER