

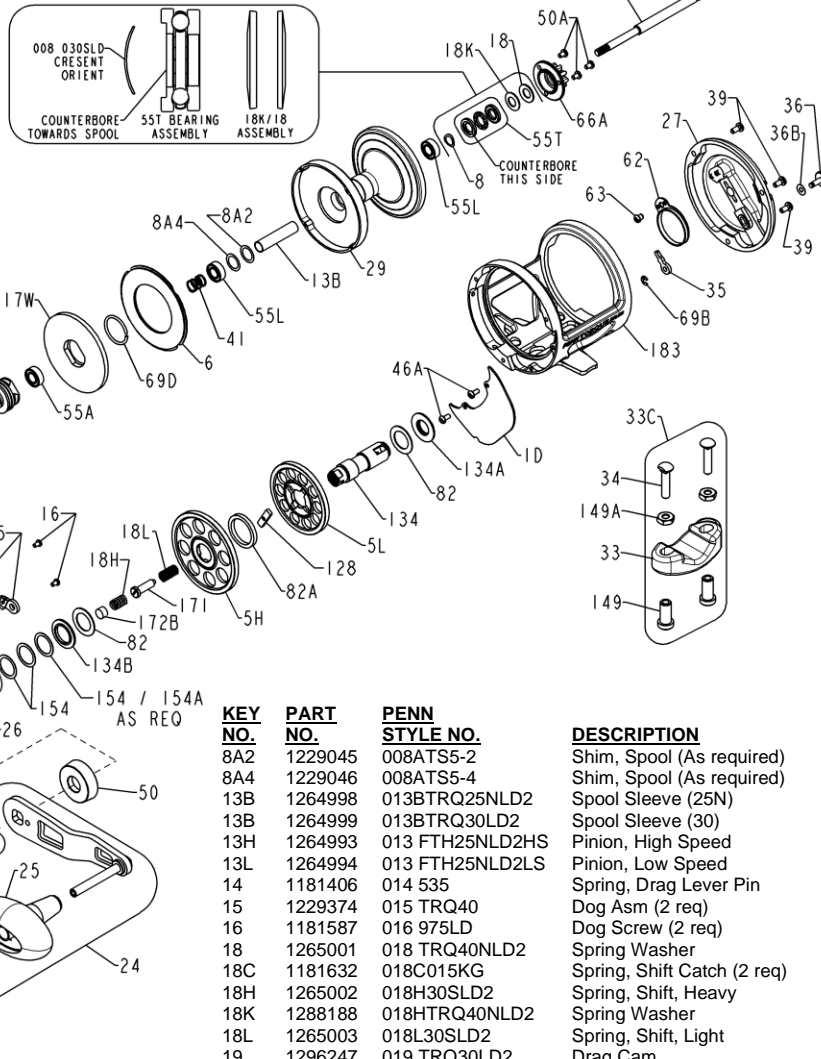

MODELS TRQ25NLD2G (Gold), 1206028 & TRQ25NLD2S (Silver), 1501852

TRQ30LD2G (Gold), 1206069 & TRQ30LD2S (Silver), 1501853

MODEL SHOWN IS TRQ30LD2



| KEY NO. | PART NO. | PENN STYLE NO.  | DESCRIPTION             |
|---------|----------|-----------------|-------------------------|
| 1       | 1264961  | 001 TRQ30LD2G   | R.S. Plate Asm (Gold)   |
| 1       | 1500548  | 001 TRQ30LD2S   | R.S. Plate Asm (Silver) |
| 1D      | 1264968  | 001DTRQ30LD2G   | Gear Cover (Gold)       |
| 1D      | 1500540  | 001DTRQ30LD2S   | Gear Cover (Silver)     |
| 2       | 1264971  | 002 TRQ30LD2B   | Quadrant                |
| 2A      | 1264976  | 002ATRQ30LD2    | Drag Lever Ratchet      |
| 4       | 1264978  | 004 TRQ15LD2    | Washer, Drag Lever      |
| 5H      | 1264981  | 005 FTH25NLD2HS | Gear, High Speed Main   |
| 5L      | 1264982  | 005 FTH25NLD2LS | Gear, Low Speed Main    |
| 6       | 1264986  | 006 TRQ30LD2    | Drag Washer             |
| 8       | 1257843  | 008 030SLD      | Washer, Crescent        |

| KEY NO. | PART NO. | PENN STYLE NO.  | DESCRIPTION                 |
|---------|----------|-----------------|-----------------------------|
| 8A2     | 1229045  | 008ATS5-2       | Shim, Spool (As required)   |
| 8A4     | 1229046  | 008ATS5-4       | Shim, Spool (As required)   |
| 13B     | 1264998  | 013BTRQ25NLD2   | Spool Sleeve (25N)          |
| 13B     | 1264999  | 013BTRQ30LD2    | Spool Sleeve (30)           |
| 13H     | 1264993  | 013 FTH25NLD2HS | Pinion, High Speed          |
| 13L     | 1264994  | 013 FTH25NLD2LS | Pinion, Low Speed           |
| 14      | 1181406  | 014 535         | Spring, Drag Lever Pin      |
| 15      | 1229374  | 015 TRQ40       | Dog Asm (2 req)             |
| 16      | 1181587  | 016 975LD       | Dog Screw (2 req)           |
| 18      | 1265001  | 018 TRQ40NLD2   | Spring Washer               |
| 18C     | 1181632  | 018C015KG       | Spring, Shift Catch (2 req) |
| 18H     | 1265002  | 018H30SLD2      | Spring, Shift, Heavy        |
| 18K     | 1288188  | 018HTRQ40NLD2   | Spring Washer               |
| 18L     | 1265003  | 018L30SLD2      | Spring, Shift, Light        |
| 19      | 1296247  | 019 TRQ30LD2    | Drag Cam                    |
| 21      | 1265005  | 021 TRQ30LD2G   | Drag Lever (Gold)           |
| 21      | 1265006  | 021 TRQ30LD2S   | Drag Lever (Silver)         |
| 21A     | 1265011  | 021ATRQ30LD2    | Lever/Quadrant Spacer       |
| 23      | 1229458  | 023 012VS       | Handle Screw                |
| 23L     | 1191283  | 023L750         | Handle Knob Screw           |
| 23W     | 1286986  | 023WTRQ40NLD2   | Handle Nut Washer           |
| 24      | 1277509  | 024 TRQ30LD2G   | Handle Asm (Gold)           |
| 24      | 1500021  | 024 TRQ30LD2S   | Handle Asm (Silver)         |
| 24C     | 1191335  | 024C066         | Handle Knob Cap             |
| 25      | 1240293  | 025 TRQ40       | Handle Knob                 |
| 26      | 1265023  | 026 TRQ40NLD2   | Ball Bearing (2 req)        |
| 26N     | 1435256  | 026NS025        | Ball Bearing                |
| 27      | 1265032  | 027 TRQ30LD2G   | Plate, L.S. (Gold)          |
| 27      | 1500639  | 027 TRQ30LD2S   | Plate, L.S. (Silver)        |
| 29      | 1265039  | 029 TRQ25NLD2G  | Spool (25N) (Gold)          |
| 29      | 1500629  | 029 TRQ25NLD2S  | Spool (25N) (Silver)        |

| KEY NO. | PART NO. | PENN STYLE NO. | DESCRIPTION              |
|---------|----------|----------------|--------------------------|
| 29      | 1265041  | 029 TRQ30LD2G  | Spool (30) (Gold)        |
| 29      | 1500631  | 029 TRQ30LD2S  | Spool (30) (Silver)      |
| 32      | 1265049  | 032 TRQ15LD2S  | Screw, Flat Head         |
| 33      | 1290729  | 033 TRQ        | Rod Clamp                |
| 33C     | 1290731  | 033CTRQ40NLD2  | Rod Clamp Kit            |
| 34      | 1182788  | 034 045        | Screw, Rod Clamp (2 req) |
| 35      | 1188656  | 035 20         | Click Tongue             |
| 36      | 1265053  | 036 TRQ40NLD2S | Click Button             |
| 36B     | 1188651  | 036B20         | Spacer, Click Button     |
| 38      | 1293254  | 038 TRQ40SN    | Screw, Locking (3 req)   |
| 38A     | 1265055  | 038 TRQ40NLD2S | Screw (2 req)            |
| 39      | 1293255  | 039 TRQ40SN    | Screw, Locking (3 req)   |
| 39S     | 1183261  | 039S965        | Screw, Cover (4 req)     |
| 41      | 1265056  | 041 TRQ40NLD2  | Spring, Drag             |
| 46A     | 1183585  | 046A4300       | Screw, Cover (2 req)     |
| 50      | 1265058  | 050 TRQ15LD2G  | Gear Shield (Gold)       |
| 50      | 1500545  | 050 TRQ15LD2S  | Gear Shield (Silver)     |
| 50A     | 1183767  | 050 716        | Screw, Ratchet (3 req)   |
| 52      | 1183840  | 052 910        | Retaining E-Ring (2 req) |
| 55A     | 1238912  | 055A50SLD      | Ball Bearing             |
| 55L     | 1286985  | 055L020        | Ball Bearing (2 req)     |
| 55T     | 1238913  | 055T30SLD      | Bearing Assembly         |
| 62      | 1184026  | 062 209        | Click Spring             |
| 62A     | 1236596  | 062 TRQ40      | Spring, Strike Button    |
| 63      | 1184048  | 063 209        | Screw, Click Spring      |
| 66A     | 1265059  | 066AFTHLD      | Click Ratchet            |
| 67      | 1184105  | 067 030VS      | Retaining E-Ring, Shift  |
| 69B     | 1184125  | 069B050        | Retaining E-Ring, Click  |
| 69D     | 1265060  | 069DFTH15LD    | Retaining Ring, Drag     |
| 71      | 1265063  | 071 TRQ25NLD2  | Spindle (Assembly)(25N)  |
| 71      | 1265065  | 071 TRQ30LD2   | Spindle (Assembly)(30)   |
| 82      | 1265070  | 082 TRQ40NLD2  | Washer, Teflon (2 req)   |
| 82A     | 1265071  | 082A30SLD2     | Washer, Gear Separating  |
| 91A     | 1277514  | 091ATRQ40NLD2  | Handle Knob Washer       |
| 98      | 1265073  | 098 FTH40NLD2  | Dog Ratchet              |
| 110A    | 1230438  | 110A012VS      | Handle Screw Lock Ring   |
| 110B    | 1264940  | 110BTRQ40NLD2S | Shifter Base             |
| 110C    | 1264941  | 110C012VSS     | Shift Button Ring        |
| 117     | 1265076  | 117 TRQ40NLD2  | Drive Plate Hub          |
| 117S    | 1265080  | 117STRQ40NLD2  | Drag Cover Seal          |
| 117W    | 1265082  | 117WTRQ30LD2   | Drag Washer              |
| 128     | 1265084  | 128 30SLD2     | Shift Key                |
| 133     | 1230583  | 133 12VS       | Retaining Plate          |
| 134     | 1265085  | 134 30SLD2     | Gear Stud                |
| 134A    | 1265086  | 134A30SLD2     | Gear Stud Nut            |
| 134B    | 1265087  | 134B30SLD2     | Gear Spacer              |
| 141     | 1265088  | 141 TRQ15LD2   | Cam Follower             |
| 141B    | 1265089  | 141BTRQ15LD2   | Spring, Preset Knob      |
| 144     | 1265091  | 144 TRQ15LD2S  | Preset Knob              |
| 149     | 1184702  | 149 045        | Rod Clamp Nut (2 req)    |
| 149A    | 1184706  | 149 200        | Hex Nut (2 req)          |
| 154     | 1265092  | 154 TRQ40NLD2  | Shim, .010 (2 + As Req)  |
| 154A    | 1306668  | 154ATRQ40NLD2  | Shim, .004 (As required) |
| 156     | 1265094  | 156 TRQ30LD2   | Drag Cover               |
| 161     | 1265097  | 161 TRQ40NLD2  | Pin, Free Locating       |
| 161A    | 1265098  | 161ATRQ15LD2   | Pin, Lever Click         |
| 161B    | 1265099  | 161BTRQ40NLD2  | Strike Button            |
| 162     | 1318280  | 162 TRQ40NLD2  | Spring, Free Button      |
| 171     | 1265101  | 171 30SLD2     | Shift Plunger (Screw)    |
| 172     | 1265104  | 172 012VSG     | Shift Button (Gold)      |
| 172     | 1500539  | 172 012VSS     | Shift Button (Silver)    |
| 172B    | 1184831  | 172B030VS      | Shift Spacer             |
| 173     | 1192384  | 173 012VS      | Shifter Catch (2 req)    |
| 173A    | 1230664  | 173A012VS      | Shift Catch Holder       |
| 183     | 1265111  | 183 TRQ25NLD2G | Frame (25N) (Gold)       |
| 183     | 1500547  | 183 TRQ25NLD2S | Frame (25N) (Silver)     |
| 183     | 1265114  | 183 TRQ30LD2G  | Frame (30) (Gold)        |
| 183     | 1500640  | 183 TRQ30LD2S  | Frame (30) (Silver)      |
| 195     | 1184955  | 195 040        | Gear Stud Ret. E-Ring    |