

SHIMANO

CATANA S A-RB

CAT-1000RC

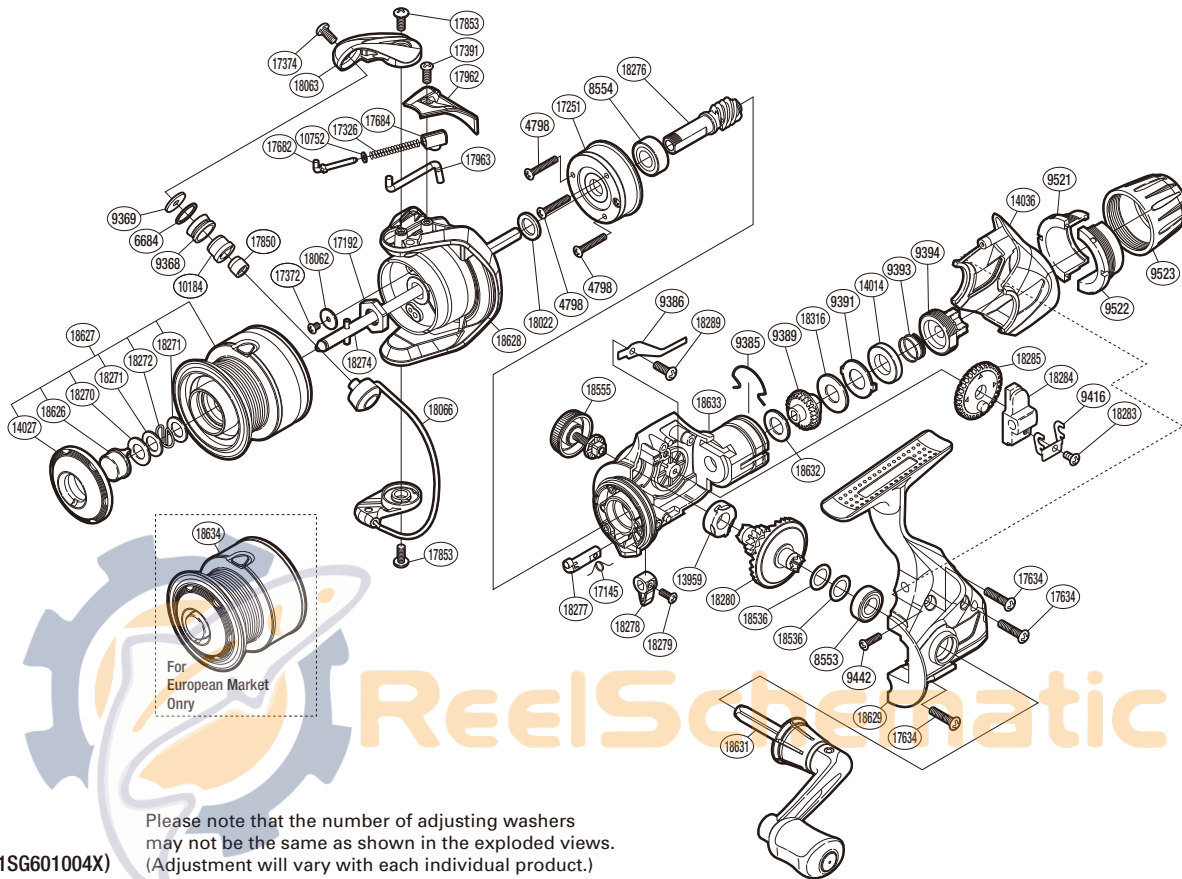

Please note that the number of adjusting washers may not be the same as shown in the exploded views. (Adjustment will vary with each individual product.)

(51SG601004X)

| Part No. | Description | Part No. | Description | Part No. | Description |
|----------|-----------------------------|----------|-------------------------|----------|----------------------|
| RD 4798 | Screw | RD14036 | Rear Protector | RD18274 | Main Shaft |
| RD 6684 | Line Roller Spacer | RD17145 | Anti-Reverse Cam Spring | RD18276 | Pinion Gear |
| RD 8553 | Ball Bearing | RD17192 | Rotor Nut | RD18277 | Anti-Reverse Cam |
| RD 8554 | Ball Bearing | RD17251 | Roller Clutch Assembly | RD18278 | Anti-Reverse Lever |
| RD 9368 | Line Roller | RD17326 | Bail Spring | RD18279 | Screw |
| RD 9369 | Washer | RD17372 | Screw | RD18280 | Drive Gear |
| RD 9385 | Hold Click Spring | RD17374 | Screw | RD18283 | Screw |
| RD 9386 | Drag Click | RD17391 | Screw | RD18284 | Oscillating Slider |
| RD 9389 | Drag Shaft | RD17634 | Screw | RD18285 | Oscillating Gear |
| RD 9391 | Eared Washer | RD17682 | Bail Spring Guide A | RD18289 | Screw |
| RD 9393 | Drag Coil Spring | RD17684 | Bail Spring Seat | RD18316 | Drag Washer |
| RD 9394 | Pressure Screw | RD17850 | Line Roller Collar | RD18536 | Washer |
| RD 9416 | Oscillating Slider Retainer | RD17853 | Screw | RD18555 | Handle Screw Cap |
| RD 9442 | Screw | RD17962 | Bail Spring Cover | RD18626 | Push Button |
| RD 9521 | Drag Programmer B1 | RD17963 | Bail Trip Lever | RD18627 | Spool Assembly |
| RD 9522 | Drag Programmer B2 | RD18022 | Washer | RD18628 | Rotor |
| RD 9523 | Drag Programmer A | RD18062 | Washer | RD18629 | Side Cover |
| RD10184 | Line Roller Bushing | RD18063 | Bail Arm | RD18631 | Handle Assembly |
| RD10752 | Bail Spring Guide A Support | RD18066 | Bail Assembly | RD18632 | Drag Washer |
| RD13959 | Drive Gear Bushing | RD18270 | Washer | RD18633 | Body |
| RD14014 | Drag Collar | RD18271 | Washer | | |
| RD14027 | Push Button Collar | RD18272 | Locking Spring | RD18634 | Spare Spool Assembly |