

SHIMANO

CITICA

CI-200IHG

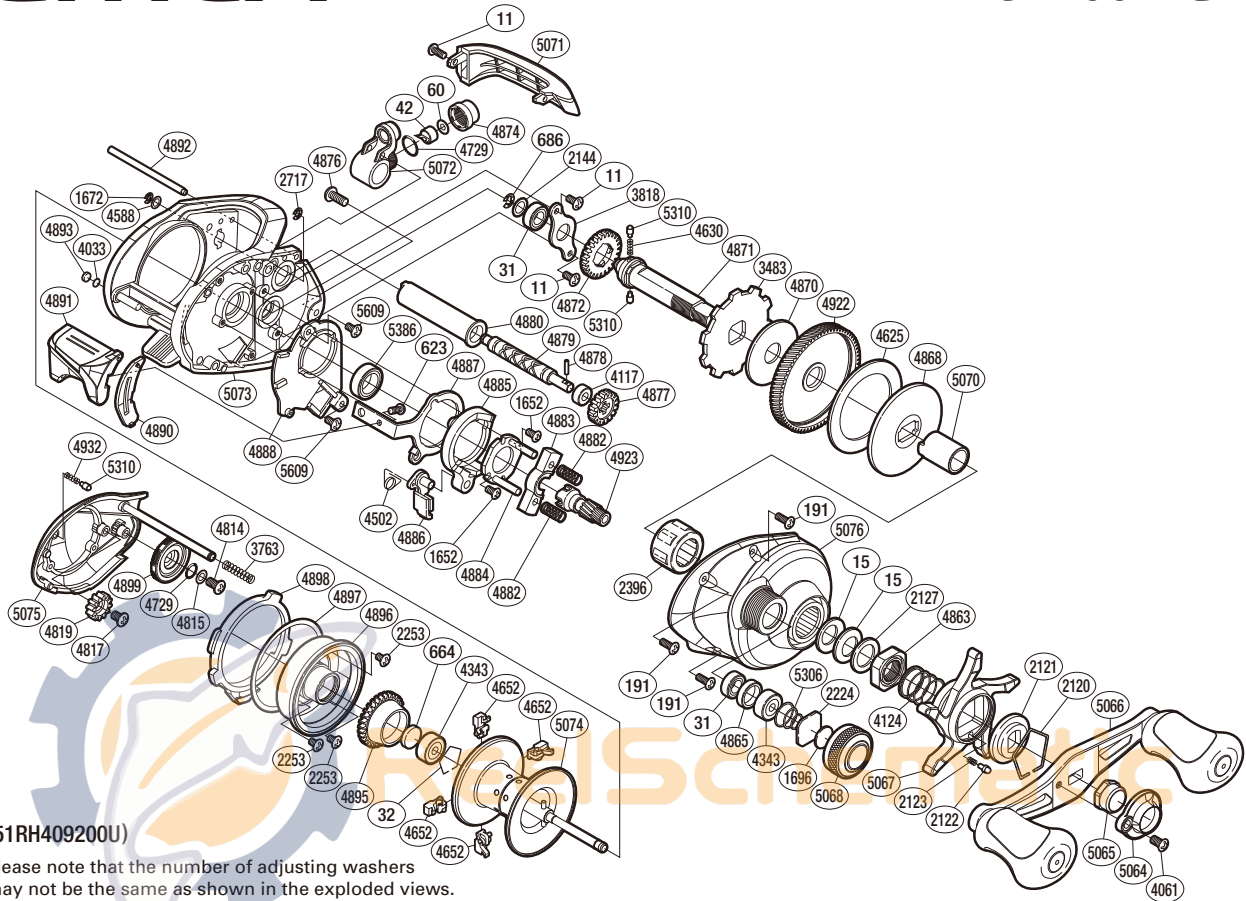

(51RH409200U)

Please note that the number of adjusting washers may not be the same as shown in the exploded views. (Adjustment will vary with each individual product.)

| Part No. | Description | Part No. | Description | Part No. | Description |
|----------|-----------------------|----------|--------------------------|----------|--------------------------|
| BNT0011 | Screw | BNT4502 | Clutch Pawl Spring | BNT4892 | Stabilizer Bar |
| BNT0015 | Drag Spring Washer | BNT4588 | Washer | BNT4893 | Anti-Thrust Washer |
| BNT0031 | Ball Bearing | BNT4625 | Drag Washer | BNT4895 | Brake Ring Gear |
| BNT0032 | Bearing Retainer | BNT4630 | Idle Gear Spring | BNT4896 | Brake Case |
| BNT0042 | Line Guide Pawl | BNT4652 | Brake Shoe | BNT4897 | Washer |
| BNT0060 | Spacer | BNT4729 | O Ring | BNT4898 | Side Plate Cam Lever |
| BNT0191 | Screw | BNT4814 | Screw | BNT4899 | Brake Dial |
| BNT0623 | Screw | BNT4815 | Washer | BNT4922 | Drive Gear |
| BNT0664 | Spacer B | BNT4817 | Screw | BNT4923 | Pinion Gear |
| BNT0686 | E Lock | BNT4819 | Idle Gear | BNT4932 | Click Spring |
| BNT1652 | Screw | BNT4863 | Star Drag Nut | BNT5064 | Handle Nut Plate |
| BNT1672 | E Lock | BNT4865 | Bearing Spacer | BNT5065 | Handle Nut |
| BNT1696 | Cast Control Spacer | BNT4868 | Key Washer | BNT5066 | Handle Assembly |
| BNT2120 | Click Plate Retainer | BNT4870 | Drag Washer | BNT5067 | Star Drag |
| BNT2121 | Star Drag Click Plate | BNT4871 | Drive Shaft | BNT5068 | Cast Control Cap |
| BNT2122 | Click Pin | BNT4872 | Idle Gear | BNT5070 | Roller Clutch Inner Tube |
| BNT2123 | Click Spring | BNT4874 | Pawl Cap | BNT5071 | Level Wind Protector |
| BNT2127 | Star Drag Spacer | BNT4876 | Screw | BNT5072 | Line Guide |
| BNT2144 | Washer | BNT4877 | Idle Gear | BNT5073 | One-Piece Frame |
| BNT2224 | Spool Tension Spacer | BNT4878 | Worm Shaft Pin | BNT5074 | Spool Assembly |
| BNT2253 | Screw | BNT4879 | Worm Shaft | BNT5075 | Left Side Plate |
| BNT2396 | Roller Clutch Bearing | BNT4880 | Level Wind Guard | BNT5076 | Right Side Plate |
| BNT2717 | E Lock | BNT4882 | Yoke Spring | BNT5306 | Spool Tension Spring |
| BNT3483 | Anti-Reverse Ratchet | BNT4883 | Yoke | BNT5310 | Idle Gear Pin |
| BNT3763 | Side Plate Spring | BNT4884 | Clutch Cam Retainer | BNT5386 | Ball Bearing |
| BNT3818 | Drive Shaft Retainer | BNT4885 | Clutch Cam | BNT5609 | Screw |
| BNT4033 | Washer | BNT4886 | Clutch Pawl | | |
| BNT4061 | Screw | BNT4887 | Clutch Plate | BNT4652 | Brake Shoe (accessory) |
| BNT4117 | Bushing | BNT4888 | Clutch Guard | | |
| BNT4124 | Star Drag Spring | BNT4890 | Clutch Bar Guide | | |
| BNT4343 | Ball Bearing | BNT4891 | Quick-Fire II Clutch Bar | BNT4692 | B-100 Oil (accessory) |