

1989 REPAIR MANUAL

Shimano American Corporation, One Shimano Dr.
Irvine, CA 92718

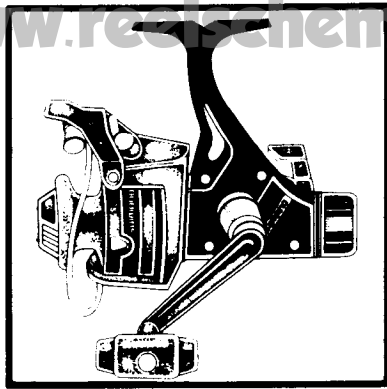

EXPLODED PARTS VIEW FX100

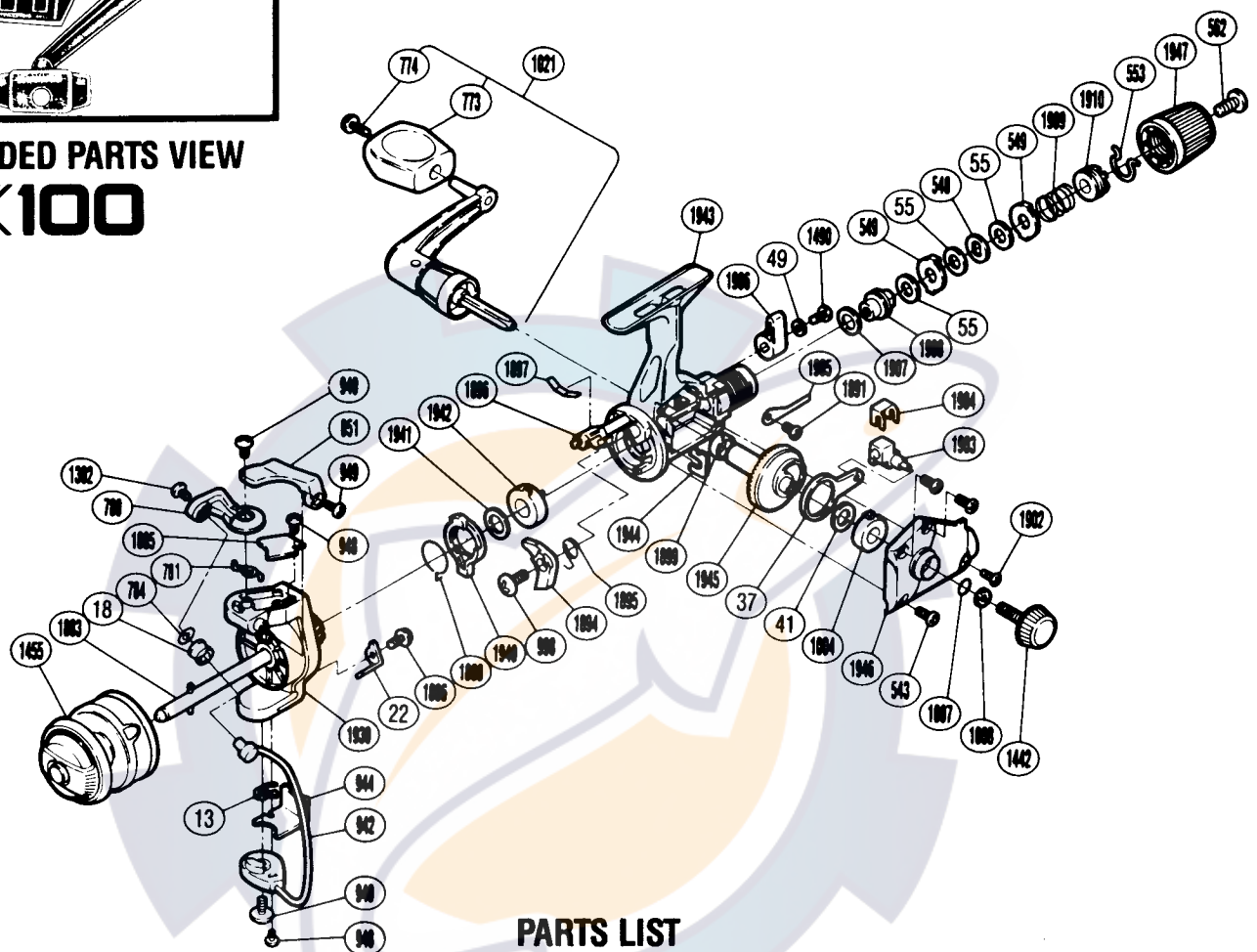

PARTS LIST

PART #	DESCRIPTION	PART #	DESCRIPTION	PART #	DESCRIPTION
RD 0013	(Trip) Lever Spring	RD 0944	Bail Trip Cover	RD 1897	Anti-Reverse Cam Spring
RD 0018	Line Roller	RD 0948	Bail Trip Cover Screw	RD 1899	Bushing B
RD 0022	(Bail) Trip Lever	RD 0949	Trigger Screw	RD 1902	Side Cover Screw (B)
RD 0037	Oscillating Arm	RD 0998	Anti-Reverse Pawl Screw	RD 1903	Oscillating Block
RD 0041	Drive Gear Washer	RD 1004	Bushing A	RD 1904	Oscillating Block Retainer
RD 0049	Lock Washer	RD 1007	Lock Washer Retainer	RD 1905	Drag Click
RD 0055	Drag Washer "C(1)" (Black)	RD 1008	Handle Lock Washer	RD 1906	Anti-Reverse Lever
RD 0543	Side Cover Screw (B)	RD 1021	Handle Assembly	RD 1907	Drag Washer "E"
RD 0548	Key Washer "A"	RD 1302	Line Roller Screw	RD 1908	Drag Shaft
RD 0549	Eared Washer "B"	RD 1442	Handle Screw Cap	RD 1909	Drag Coil Spring
RD 0553	Hold Click Spring	RD 1455	Spool Assembly	RD 1910	Pressure Screw
RD 0562	Drag Programmer Screw	RD 1490	Anti-Reverse Lever Screw	RD 1939	Rotor
RD 0773	Handle Knob	RD 1883	Main Shaft	RD 1940	Anti-Reverse Lock Out
RD 0774	Handle Knob Screw	RD 1885	Bail Spring Cover	RD 1941	Bushing Washer
RD 0780	Bail Arm	RD 1886	Trip Lever Screw	RD 1942	Bushing
RD 0781	Bail Spring	RD 1888	Anti-Reverse Lock Out Spring	RD 1943	Body
RD 0784	Line Roller Washer	RD 1891	Multi Purpose Screw	RD 1944	Rotor Lock
RD 0851	Quick-Fire II Trigger	RD 1894	Anti-Reverse Pawl	RD 1945	Drive Gear
RD 0940	Bail Trip Cam Screw	RD 1895	Anti-Reverse Pawl Spring	RD 1946	Side Cover
RD 0942	Bail Assembly	RD 1896	Anti-Reverse Cam	RD 1947	Drag Knob

Prices and specifications subject to change without notice.

OCTOBER, 1988