

When you need reliable accessories to complete your fishing kit think 'Alvey'. All our products are factory checked and manufactured using the latest injection moulding techniques. Our accessories are all UV stabilised and will resist harsh sunlight so that you get maximum use from your Alvey purchase. No matter what your requirement there is an Alvey fishing accessory to suit your application.



tackle boxes (clear lid)

Variety of designs. Stackable with clear lids that allow you to see your tackle. (5 compartment layouts available.)
Tackle not included.

fish measure stick



Size 38cm and 80cm available. Legal sizes of most common varieties for each state are shown on the back of the ruler.

fish scaler



Strong plastic scaler that won't rust or cut your hands like a metal scaler.

junior & senior tackle boxes



Versatile bakelite tackle boxes, ideal for beach, hiking or bushwalking.

reel lube



Top quality anti-corrosive and water resistant grease for all your reels.

rod buckets



Heavy duty leather or moulded rubber, plain or with gimbal bar for boat rods. Worn around your waist these buckets support the butt of the rod and make fishing a lot more comfortable.

hook disgorger



A slender plastic implement that every angler should have to remove the hooks that some fish always manage to swallow.

hand casters



HC10 holds 700m of 38kg line.

6 sizes available from 10cm to 25cm.

surf kit

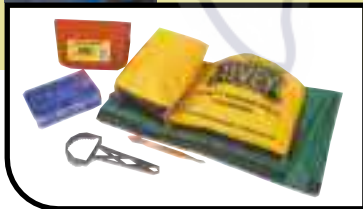

A comprehensive Alvey accessory kit for all your surf fishing requirements.

line casting plugs

7grms weight, ideal for learning to cast with safety in mind.

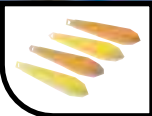

new alvey line



Fine diameter line made in Australia to suit sidecast reels.

purpose built alvey rods

Alvey reels require rods which are correctly set up in order to attain maximum efficiency from your reel.

The following points must be noted when purchasing a rod to suit your reel:

- Low winch fitting (About 15 to 20cm from the end of rod)
- To avoid restricting the line coils when casting, your first runner must be half way up the rod.
- An open runner centres line and takes tension off your finger when winding in. See Page 9.

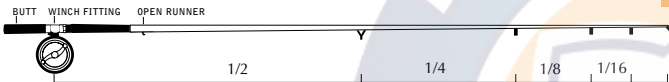

To ensure you purchase the correct rod for your Alvey reel, consider a purpose built Alvey rod. These imported rods have been designed by Alvey and will guarantee best performance from your reel.

Rod (*Open Runner)	Purpose	Material	Length	Line Class
Rod 400	Junior/Beginner	Solid glass-2 Piece	1.5m (5')	3kg
* Rod 450	Freshwater/Estuary	Hollow glass-2 Piece	1.8m (6')	3kg
* Rod 500	General Purpose	Hollow glass-2 Piece	2.1m (7')	3kg
* Rod 600	Estuary/Light Surf	Hollow glass-2 Piece	3.2m (10'6")	5kg
* Light Surf Custom	Estuary/Light Surf	Superior Hollow glass Hi Quality fittings-2 Piece	3.6m (12')	5kg
* Rod 650	Surf	Hollow glass-2 Piece	3.9m (13')	7kg
* Surf Champion Custom	Surf	Superior Hollow Glass Hi Quality fittings-2 Piece	3.6m (12')	7kg
Rod 925	Boat	Solid Glass-1 Piece	1.8m (6')	24kg

Rods pictured top to bottom:

- Rod 450
- Surf Champion Custom
- Rod 650

maintenance/spare parts

maintenance

When servicing your Alvey reel use the following picture as a guide to grease and lubrication points.

(Note: All graphite Alvey reels with drag do not require oiling of the drag washers)

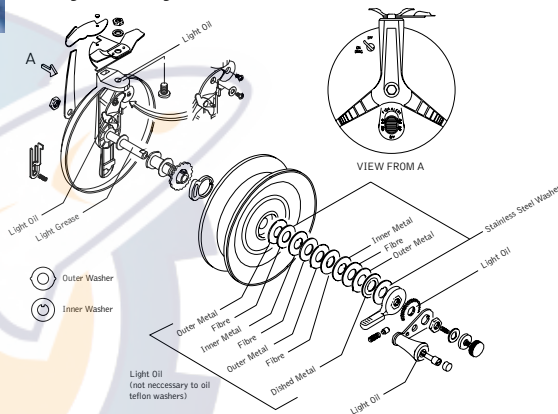

spare parts

Alvey Products are of the highest quality and will give you many years of trouble free service. However, should you require parts they are available through your local tackle shop. Many Parts are interchangeable between models.



alvey rods maintenance/spare parts

clothing

jacket

Super, light weight, lined spray jackets with zipper. Very warm, yet comfortable to wear (logo front and back).

beanie



long sleeve polo (khaki or navy)



short sleeve polo

These very smart short sleeved collared shirts are extremely versatile and can be worn to casual functions or when fishing (Blue with white shirt, logo front and back)



caps (suede or cotton)



merchandise

bottle opener, patch, stubbie cooler, keyring, better fisherman booklet

56 page full colour booklet on 'How to become a better fisherman'.



Available in a range of colours and styles, these great new embroidered caps really look the part!

order form

product	size	quantity	price inc. GST	total
Alvey Cap - cotton	One size fits all		\$ 8.80	\$
Alvey Cap - suede & brushed cotton	One size fits all		\$ 16.50	\$
Alvey Beanie	One size fits all		\$ 9.90	\$
Alvey Short Sleeve Polo (Aust. Made)	(cm) 95 100 105 110 115		\$ 28.00	\$
Alvey Long Sleeve Polo (Aust. Made)			\$ 38.00	\$
Alvey Spray Jacket (Aust. Made)			\$ 69.00	\$
Alvey Shark stubbie opener (Aust. Made)			\$ 3.50	\$
Alvey patch (Aust. Made)	Superior		\$ 5.50	\$
Alvey stubbie cooler	80 Years		\$ 6.00	\$
Alvey Reel 3D Pewter Key Ring (Aust. Made)			\$ 11.00	\$
'Fisherman's Cookbook' (Aust. Made)			\$ 10.00	\$
*How to become a better fisherman' booklet (including bonus hook dispenser)				\$ 4.00
*postage and handling per order (incl. GST)				\$ 8.00
Prices apply within Australia only. Overseas customers please write/fax for quote				total

merchandise

Name: _____
Address: _____

P/C: _____

Tick appropriate box: Bankcard Visa MasterCard

Name on card _____

Signature _____

Expiry Date / / _____

No stamp required
if posted in Australia



Delivery Address:
PO Box 105
GOODNA QLD 4300



Alvey Reels (Australia)
Reply Paid 105
GOODNA QLD 4300

reel profiles

		
500A5 Standard	625B Shallow	600A5 Standard
		
6500BC V Standard	725C52 Boat reel spool	651C5 Deep spool

reel profiles

spooling a reel



Right

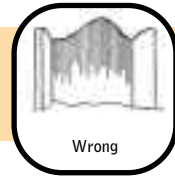

Wrong

Fishing line is not included within the price of the reels. All specifications and information contained herein was correct at the time of print, variations may occur in the future. Alvey Reels (Australia) does not accept any responsibility for any loss or damage incurred by any person directly or indirectly due to the reliance on such information and the users of such information do so at their own risk.



ALVEY REELS (AUSTRALIA)
FOUNDED 1920
P.O. Box 105, Goodna
Queensland 4300, Australia
Tel: 07-3271 2844
Fax: 07-3271 2451
International:
Tel: 61 7-3271 2844
Fax: 61-7 3271 2451
Email: info@alvey.com.au

ALVEY
SAGE WINGS

GREAT



WORLD-RECORD
Fisherman Caught with the
Largest Salmon Ever
18 ft. in length
48 lbs.

WORK  **FISH**
American Seafood Fishermen's Union

FISH AND I VOTE

