

# BAITCASTING REEL – BW2L, EL2L, PS2L-2B, PS2L-5B

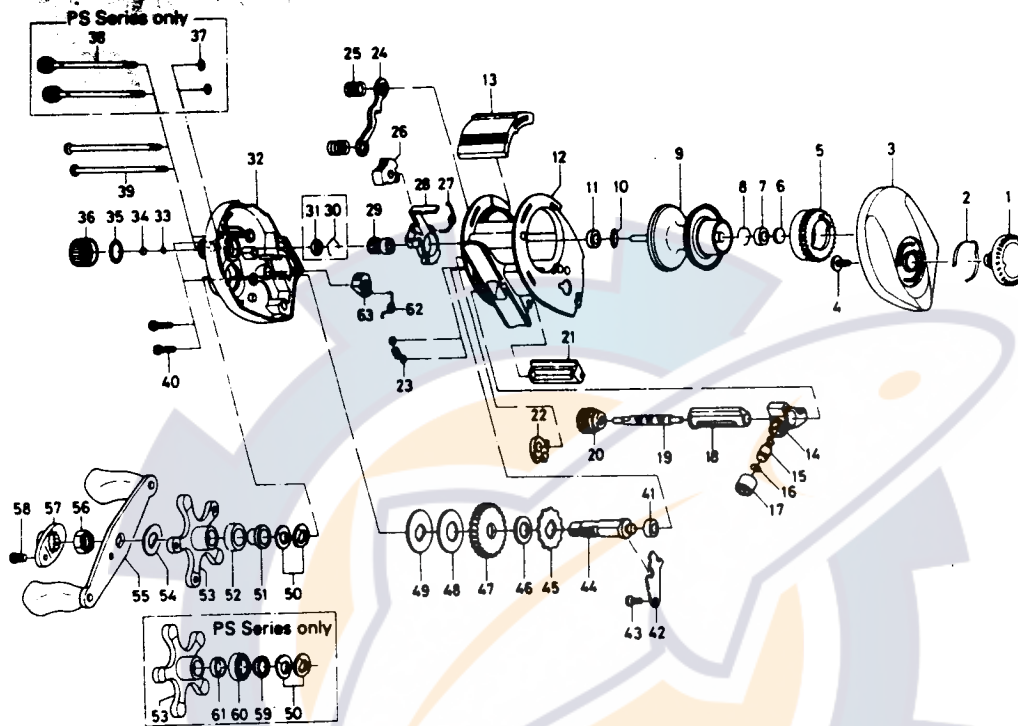

Key No.	Part No.	Part Name	Price
<b>EL2L Special Parts:</b>			
1	F06-0102	Brake adjusting knob	2.60
3	F12-3704	Right side plate	8.80
11	B35-8601	Ball bearing	8.75
12	F12-1102	Frame assembly	8.50
21	F05-3902	Line guard	1.45
32	F06-1812	Left side plate	8.10
53	E23-8702	Star drag	2.50
55	E30-5203	Handle assembly	5.95
<b>PS2L-2B Special Parts:</b>			
1	F06-0402	Brake adjusting knob	4.25
3	F12-3702	Right side plate	9.85
9	F06-0603	Spool assembly	14.50
11	B35-8601	Ball bearing A	8.75
12	F12-1102	Frame assembly	8.50
13	F06-0201	Clutch lever	2.60
21	F05-3902	Line guard	1.45
32	F06-1811	Left side plate	4.30
37	B85-3101	"O" ring B	.60
38	B91-1712	Left side plate screw	3.40
53	F06-0301	Star drag	5.65
55	E30-5203	Handle assembly	5.95
58	351-1803	Handle nut plate screw	.45
59	E20-8501	Spacing sleeve A	1.15
60	E15-4001	Ball bearing B	6.85
61	B97-4901	Spacing sleeve B	.95

Key No.	Part No.	Part Name	Price
<b>PS2L-5B Special Parts:</b>			
1	F06-0902	Brake adjusting knob	4.25
3	F12-3703	Right side plate	11.35
7	B35-8601	Ball bearing A	8.75
9	F06-0603	Spool assembly	14.50
11	B35-8601	Ball bearing A	8.75
12	F12-1102	Frame assembly	8.50
13	F06-0201	Clutch lever	2.60
21	F05-3902	Line guard	1.45
30	E21-9701	Bearing retainer	.50
31	E24-8501	Ball bearing B	8.65
32	F06-1808	Left side plate	11.10
37	B85-3101	"O" ring B	.60
38	B91-1712	Left side plate screw	3.40
41	B35-8601	Ball bearing A	8.75
53	F08-0303	Star drag	5.65
58	351-1803	Handle nut plate screw	.45
59	E20-8501	Spacing sleeve A	1.15
60	E15-4001	Ball bearing C	6.85
61	B97-4901	Spacing sleeve B	.95