

BALLISTIC 2000SH/2500SH/3000SH/4000SH

Please order by parts number, not key number
Veuillez indiquer le numéro de la pièce (Non "Key" No.)

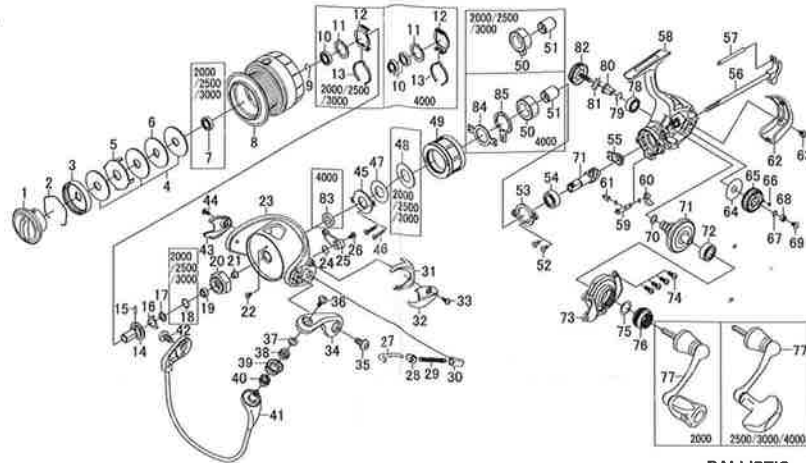

Key No.	BALLISTIC 2000SH Parts No.	Parts Name	Désignation des pièces	BALLISTIC 2500SH Parts No.	BALLISTIC 3000SH Parts No.	BALLISTIC 4000SH Parts No.
1	6H763801	Drag Knob	Bouton de réglage du frein	6H760101	6H760101	6H764501
2	6F742501	Drag Washer Retainer	Clips de rondelle de frein	6F742501	6F742501	6F710001
3	6F908701	Drag Knob Click Plate	Hauteur bruiteur de coulon de réglage du frein de bobine	6F908701	6F908701	6F895302
4	6F635001	Drag Washer	Rondelle de frein	6H761101	6H761101	6F627101
5	6F635201	Eared Washer	Rondelle à oreilles	6H761301	6H761301	6F755701
6	6H627701	Key Washer	Rondelle fixe	6H761201	6H761201	6F644702
7	6E306801	Ball Bearing (A)	Roulement à billes (A)	6E306801	6E306801	-
2-8	6H763601	Spool Assembly	Bobine complète	6H759901	6H760201	6H764301
9	6G472401	Bearing Retainer (A)	Rondelle de retenue du roulement à billes (A)	6G472401	6G472401	6G525101
10	6E306801	Ball Bearing (B)	Roulement à billes (B)	6E306801	6E306801	6B861704
11	6F625500	Washer (A)	Rondelle (A)	6F625500	6F625500	6F643500
12	6H416001	Click Leaf Spring Holder	Support de ressort de réglage du cliquet	6H416001	6H416001	6G694001
13	6H416102	Spool Click Leaf Spring	Pessort de réglage de bobine	6H416102	6H416102	6F709002
14	6H601301	Spool Metal	Douille de bobine	6H601301	6H601301	6H641501
15	6G375001	Pin	Clavette	6G375001	6G375001	6G224101
16	6H415801	Bearing Retainer (B)	Rondelle de retenue du roulement à billes (B)	6H415801	6H415801	6H107301
17	6H415701	Packing	Emballage	6H415701	6H415701	6H505001
18	6G466103	Washer (B)	Rondelle (B)	6G466103	6G466103	-
19	6G466201	Ball Bearing (C)	Roulement à billes (C)	6G466201	6G466201	6G467101
20	6H444501	Rotor Nut	Ecrou de cloche	6H705201	6H705201	6H730901
21	6H415501	Collar (A)	Collier (A)	6H415501	6H415501	6H504902
22	6H022701	Screw (A)	Vis (A)	6H022701	6H022701	6H022701
23	6H443204	Rotor	Cloche	6H413509	6H413509	6H640203
24	6H443301	Bail Trip Lever Spring	Ressort du levier de déclenchement	6H413601	6H413601	6H413601
25	6H443401	Bail Trip Lever	Levier de déclenchement	6H413701	6H413701	6H640401
26	6H417701	Screw (B)	Vis (B)	6H417701	6H417701	6H417701
27	6H443601	Ball Spring Shaft	Axe de ressort de pick-up	6H414101	6H414101	6H640601
28	6H576101	Bail Spring Plate	Plaque de ressort de pick-up	6H576101	6H576101	6H576101
29	6H442401	Bail Spring	Ressort de pick-up	6H545701	6H545701	6H640701
30	6H414301	Bail Spring Holder	Support ressort de pick-up	6H414301	6H414301	6H414301
31	6H443704	Cover (C)	Couvercle (C)	6H414007	6H414007	6H640803
32	6H443801	Cover (A)	Couvercle (A)	6H414601	6H414601	6H640902
33	6H431301	Screw (C)	Vis (C)	6H431301	6H431301	6H431301
34	6H414406	Bail Arm	Bras de pick-up	6H414406	6H414406	6H533805
35	6H431201	Screw (D)	Vis (D)	6H431201	6H431201	6H431201
36	6H697701	Screw (E)	Vis (E)	6H697701	6H697701	6H697701
37	6H415401	Collar (B)	Collier (B)	6H415401	6H415401	6H415401
38	6H415201	Collar (C)	Collier (C)	6H415201	6H415201	6H415201
39	6G686703	Line Roller	Galet de pick-up	6G686703	6G686703	6G686703
40	6H415201	Collar (D)	Collier (D)	6H415201	6H415201	6H415201
41	6H687802	Bail Assembly	Ensemble Arceau du pick-up	6H687802	6H687802	6H641002
42	6H431201	Screw (F)	Vis (F)	6H431201	6H431201	6H431201
43	6H444301	Cover (B)	Couvercle (B)	6H415101	6H415101	6H641302
44	6H431301	Screw (G)	Vis (G)	6H431301	6H431301	6H431301
45	6H601101	Cover Retainer	Clips de couvercle	6H601101	6H601101	6H640001
46	6H596501	Screw (H)	Vis (H)	6H596501	6H596501	6H596501
47	6H601001	Washer (C)	Rondelle (C)	6H601001	6H601001	6H639801
48	6H600901	Washer (D)	Rondelle (D)	6H600901	6H600901	-
49	6H519303	Cover (D)	Couvercle (D)	6H519303	6H519303	6H642504
50	6H412601	Roller Clutch	Roulement à aiguilles	6H412601	6H412601	6G314501
51	6H615501	Spacing Sleeve	Manchon	6H615501	6H615501	6H639601
52	6G997301	Screw (I)	Vis (I)	6G997301	6G997301	6H624901
53	6H442201	Bearing Retainer (C)	Rondelle de retenue du roulement à billes (C)	6H442201	6H442201	6H509101
54	6G467301	Ball Bearing (D)	Roulement à billes (D)	6G467301	6G467301	6G522801
55	6H596401	Collar (E)	Collier (E)	6H596401	6H596401	6H649001
56	6H629201	Main Shaft	Axe principal	6H596001	6H596001	6H639101
57	6H596301	Stabilizer Bar	Entretroise	6H596301	6H596301	6H639301
58	6H766001	Body	Bâti	6H759501	6H759501	6H763901
59	6H595501	Anti-Reverse Cam	Came du cliquet anti-retour	6H595501	6H595501	6H639001
60	6H595401	Anti-Reverse Lever	Commande de l'anti-retour	6H595401	6H595401	6H595401
61	6H697801	Anti-Reverse Cam Spring	Ressort de came du cliquet anti-retour	6H697801	6H697801	6H697801
62	6H598102	Rear Cover	Couvercle arrière	6H598102	6H598102	6H640102
63	6H598201	Screw (J)	Vis (J)	6H598201	6H598201	6H598201
64	6H595701	Washer (E)	Rondelle (E)	6H595701	6H595701	6G644201
65	6H768401	Oscillating Gear	Roue d'oscillation	6H727901	6H727901	6H545301
66	6H770601	"O" Ring (A)	Anneau torique (A)	6H770601	6H770601	6B853101
67	6H129200	Washer (F)	Rondelle (F)	6H129200	6H129200	6G522100
68	6G469002	Ball Bearing (E)	Roulement à billes (E)	6G469002	6G469002	6G467102
69	6G997001	Screw (K)	Vis (K)	6G997001	6G997001	6H463401
70	6G670501	"O" Ring (B)	Anneau torique (B)	6G670501	6G670501	6G645301
71	6Z020719	Pinion Gear + Drive Gear	Pignon / Roue de commande	6Z020653	6Z020653	6Z020493
72	6G467301	Ball Bearing (F)	Roulement à billes (F)	6G467301	6G467301	6G523403
73	6H759701	Side Cover	Couvercle	6H759701	6H759701	6H764101
74	6H597701	Screw (L)	Vis (L)	6H597701	6H597701	6H597701
75	6G613400	Washer (G)	Rondelle (G)	6G613400	6G613400	6G645601
76	6H597801	Screw (M)	Vis (M)	6H597801	6H597801	6H645701
77	6H763501	Handle Assembly	Manivelle	6H759801	6H759801	6H764201
78	6G522701	Ball Bearing (G)	Roulement à billes (G)	6G522701	6G522701	6G431002
79	6G472401	Bearing Retainer (D)	Rondelle de retenue du roulement à billes (D)	6G472401	6G472401	6G525101
80	6F721001	Collar (F)	Collier (F)	6F721001	6F721001	6F721202
81	61608101	Washer (H)	Rondelle (H)	61608101	61608101	61608101
82	6H613302	Handle Screw	Vis de manivelle	6H613302	6H613302	6H641802
83	-	Collar (G)	Collier (G)	-	-	6H640301
84	-	Clutch Cam Retainer	Verrou de came d'embrayage	-	-	6H665001
85	-	Clutch Cam	Came d'embrayage	-	-	6F641401