

**Daiwa**

COMMITTED TO TOTAL QUALITY

SPINNING REEL

**EMCAST Plus 4500/5000**

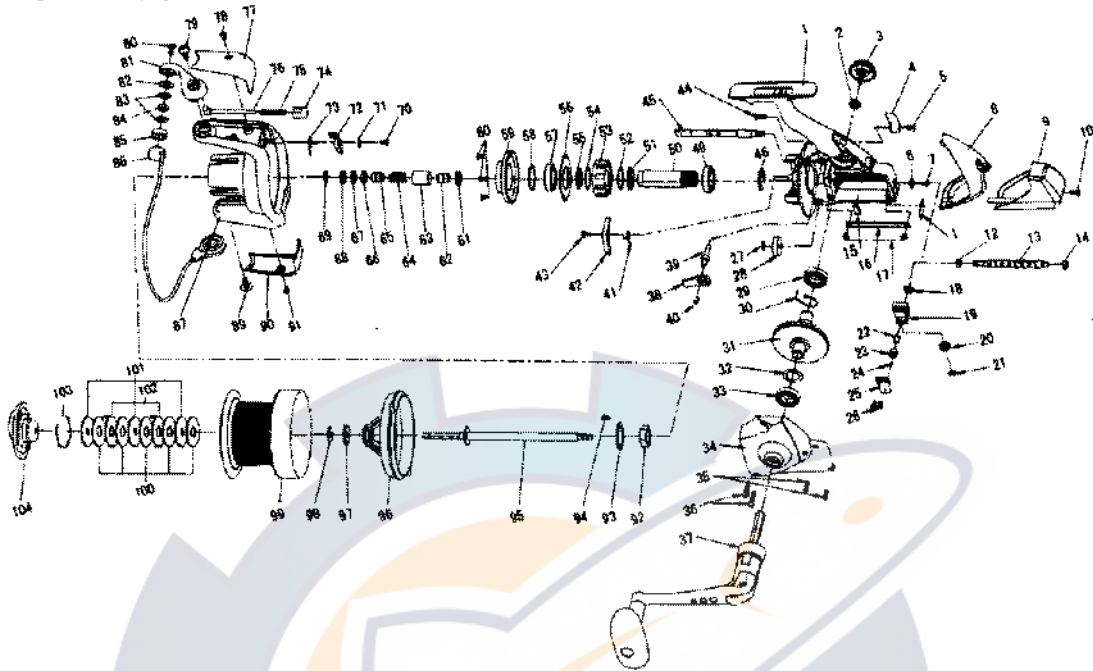

Key No.	Parts No.	Parts Name	Key No.	Parts No.	Parts Name
1	W36-0011	BODY	57	W42-8201	BALL BEARING G
2	W36-0101	HANDLE WASHER	58	W36-6501	BALL BEARING RET WASHER
3	W36-0201	HANDLE SCREW	59	W36-5601	BEARING RET
4	W36-0301	A/R LEVER	60	W36-5701	BEARING RET SCREW
5	W36-0401	A/R LEVER SCREW	61	W36-5801	BALL BEARING H
6	W36-0502	BALL BEARING RET	62	W36-5902	BALL BEARING COLLAR A
7	W36-0601	BALL BEARING SCREW	63	W36-6001	SPACING SLEEVE
8	W36-0702	REAR COVER A	64	W36-6101	MAIN SHAFT SPRING A
9	W36-0802	REAR COVER B	65	W36-6202	BALL BEARING COLLAR B
10	W36-0901	REAR COVER SCREW A	66	W36-5801	BALL BEARING I
11	W36-1002	WORM SHAFT RET A	67	W36-6301	BALL BEARING WASHER A
12	W36-1101	WORM SHAFT BUSH	68	W36-6402	BALL BEARING WASHER B
13	W36-1202	WORM SHAFT	69	W36-6501	MAIN SHAFT SPRING B
14	W36-1302	BALL BEARING A	70	W36-6601	BAIL TRIP LEVER SCREW
15	W36-1401	A/R CAM SPRING	71	W31-1801	BAIL TRIP LEVER WASHER
16	W36-1502	STABILIZER BAR	72	W36-6802	BAIL TRIP LEVER
17	W36-1601	STABILIZER BAR SCREW	73	W36-6901	BAIL TRIP LEVER SPRING
18	W36-1701	BALL BEARING B	74	W36-7001	BAIL SPRING HOLDER
19	W36-1802	OSC SLIDER	75	W36-7101	BAIL SPRING
20	W36-1901	BALL BEARING C	76	W36-7202	BAIL SPRING SHAFT
21	W36-2001	BEARING RET B	77	W36-7302	BAIL SPRING COVER
22	W36-2102	OSC PAWL	78	W36-7401	BAIL SPRING COVER SCREW
23	W36-2202	OSC PAWL COLLAR	79	W36-7501	BAIL ARM SCREW
24	W36-2301	OSC PAWL WASHER	80	W36-7601	LINE ROLLER SCREW
25	W36-2402	OSC SLIDER COVER	81	W36-7701	BAIL ARM
26	W36-2501	OSC SLIDER COVER SCREW	82	W30-6201	LINE ROLLER WASHER B
27	W36-2601	WORM SHAFT RET B	83	W30-6101	LINE ROLLER WASHER A
28	W36-2702	WORM SHAFT GEAR	84	W42-9401	BALL BEARING J
29	W42-8302	BALL BEARING D	85	W36-8101	LINE ROLLER
30	W36-2901	A/R PAWL SPRING A	86	W36-8202	BAIL
31	W36-3002	DRIVE GEAR	87	W36-8302	ROTOR
32	W36-3101	DRIVE GEAR WASHER	89	W36-8401	BAIL HOLDER SCREW
33	W42-8302	BALL BEARING E	90	W36-8502	BAIL HOLDER COVER
34	W38-3202	SIDE COVER	91	W36-8601	BAIL HOLDER COVER SCREW
35	W36-3301	SIDE COVER SCREW A	92	W36-8702	ROTOR NUT
36	W36-3401	SIDE COVER SCREW B	93	W36-8801	ROTOR NUT HOLD PLT
37	W36-3502	HANDLE	94	W36-8901	ROTOR NUT HOLD PLT SCREW
38	W36-3602	A/R PAWL A	95	W36-9002	MAIN SHAFT
39	W36-3702	A/R PAWL COLLAR	96	W36-9102	LINE GUARD
40	W36-3851	A/R PAWL RET	97	W36-9201	CLICK GEAR
41	W36-3901	A/R PAWL SPRING B	98	W36-9301	CLICK GEAR WASHER
42	W36-4001	A/R PAWL B	99-103	W36-9422	SPOOL
43	W36-4101	A/R PAWL B SCREW	99-103	W36-9424	SPOOL (EXTRA)
44	W36-4201	REAR COVER SCREW B	100	W36-9601	DRAG WASHER
45	W36-4302	A/R CAM	101	W36-9701	KEY WASHER
46	W36-4401	PINION RET	102	W36-9801	EARED WASHER
49	W36-4702	BALL BEARING F	103	W36-9901	DRAG WASHER RET
50	W36-4802	PINION GEAR	104	W36-9501	DRAG KNOB
51	W36-4901	PINION COLLAR			
52	W36-5001	PINION WASHER			
53	W36-5101	ROLLER CLUTCH			
54	W36-5201	ROLLER CLUTCH WASHER			
55	W36-5301	ROLLER CLUTCH COLLAR			
56	W36-5401	ROLLER CLUTCH RET			

**SPECIAL PART FOR ECP5000**

Key No.	Parts No.	Parts Name
99-103	W36-9432	SPOOL
99-103	W36-9434	SPOOL (EXTRA)