

SPINNING REEL — EX750

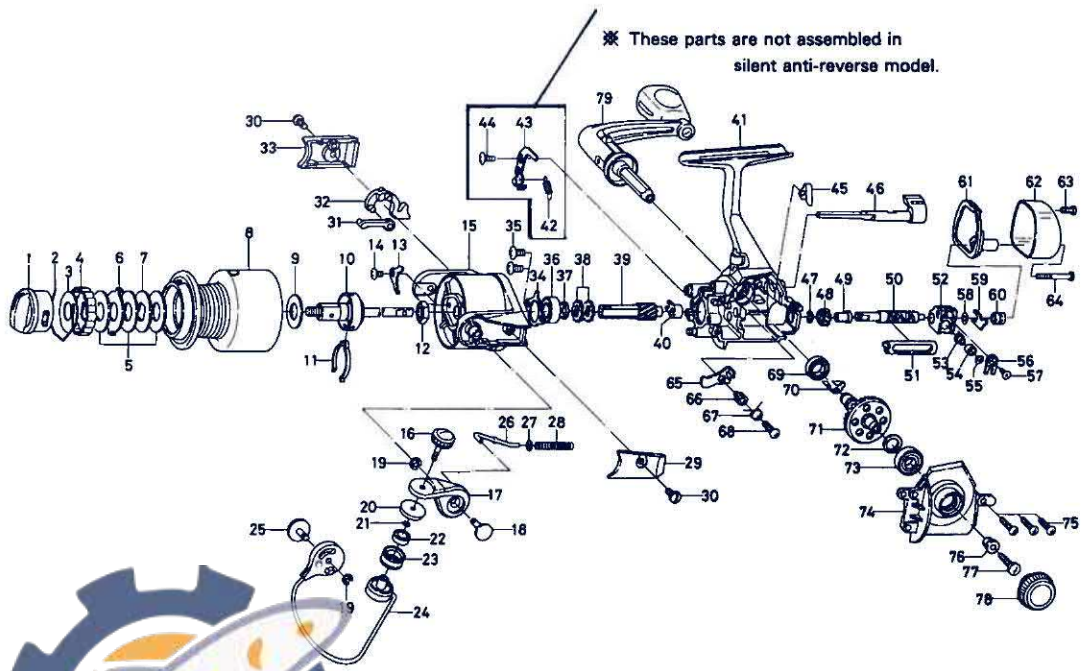

Key No. 2-8

F01-7401 Spool assembly

ReelSchematic

Key No.	Part No.	Part Name	Key No.	Part No.	Part Name
1	F01-8101	Drag knob	39	E24-4202	Pinion gear
2	F06-2601	Drag washer retainer	40	E24-3301	Pinion collar
3	F01-6001	Click plate washer	41	F01-2302	Body
4	E12-2803	Drag knob click plate	45	E26-8701	Anti-reverse cam spring
5	B36-0204	Drag washer	46	F01-2705	Anti-reverse lever
6	E15-0101	Eared washer	47	B33-9801	Worm shaft gear retainer
7	B65-2302	Key washer	48	E24-8202	Worm shaft gear
8	F01-7501	Spool assembly	49	E19-0901	Worm shaft bush
9	F06-2701	Spool washer	50	E42-6101	Worm shaft
10	F01-5501	Main shaft assembly	51	E24-4501	Worm shield cover
11	B74-7702	Spool click tear spring	52	E24-4403	Oscillating slider
12	341-9204	Rotor nut	53	E19-1202	Oscillating pawl
13	B99-5101	Rotor nut holding plate	54	E19-1301	Oscillating pawl bush
14	350-8912	Rotor nut holding plate screw	55	375-0800	Oscillating pawl washer
15	F04-9801	Rotor	56	E24-4901	Oscillating slider cover
16	F01-5001	Line roller screw	57	E15-0203	Oscillating slider cover screw
17	F01-3401	Bail arm	58	373-1300	Worm shaft washer
18	F01-3501	Bail arm screw	59	E24-5101	Worm shaft retainer
19	320-5901	Bail arm screw retainer	60	E19-1101	Worm shaft collar
20	F01-4901	Line roller collar	61	F01-6101	Water shield
21	B85-3101	"O" ring	62	F01-6201	Rear cover
22	F05-5601	Ball bearing A	63	F01-6301	Rear cover screw A
23	F06-3201	Line roller	64	F01-7201	Rear cover screw B
24	F01-3801	Bail	65	E27-1301	Anti-reverse pawl
25	F01-4501	Bail trip cam screw	66	B95-9501	Anti-reverse pawl collar
26	E11-5801	Bail spring shaft	67	B95-9602	Anti-reverse pawl spring A
27	E11-5901	Bail spring washer	68	351-6401	Anti-reverse pawl screw
28	E11-6001	Bail spring	69	F01-6401	Ball bearing C
29	F01-3601	Bail spring cover	70	E24-5301	Anti-reverse pawl spring
30	F01-3701	Bail spring cover screw	71	E24-7004	Drive gear
31	F01-4301	Bail trip plate	72	375-8502	Drive gear washer
32	F01-4401	Bail trip lever	73	636-6401	Ball bearing B
33	F01-4601	Bail trip cover	74	F01-3201	Left side cover
34	F01-3001	Bearing retainer	75	351-1101	Side cover screw
35	351-7701	Bearing retainer screw	76	501-8501	Handle collar
36	636-6401	Ball bearing B	77	F04-5001	Handle screw
37	F01-6901	Spacer	78	F01-7301	Handle screw cap
14 38	E27-1501	Anti-reverse ratchet	79	F01-5701	Handle assembly