

Please order by parts number, not key number
Veuillez indiquer le numéro de la pièce (Non "Key" No.)

Daiwa
COMMITTED TO TOTAL QUALITY
SPINNING REEL

EXCELER 4500T

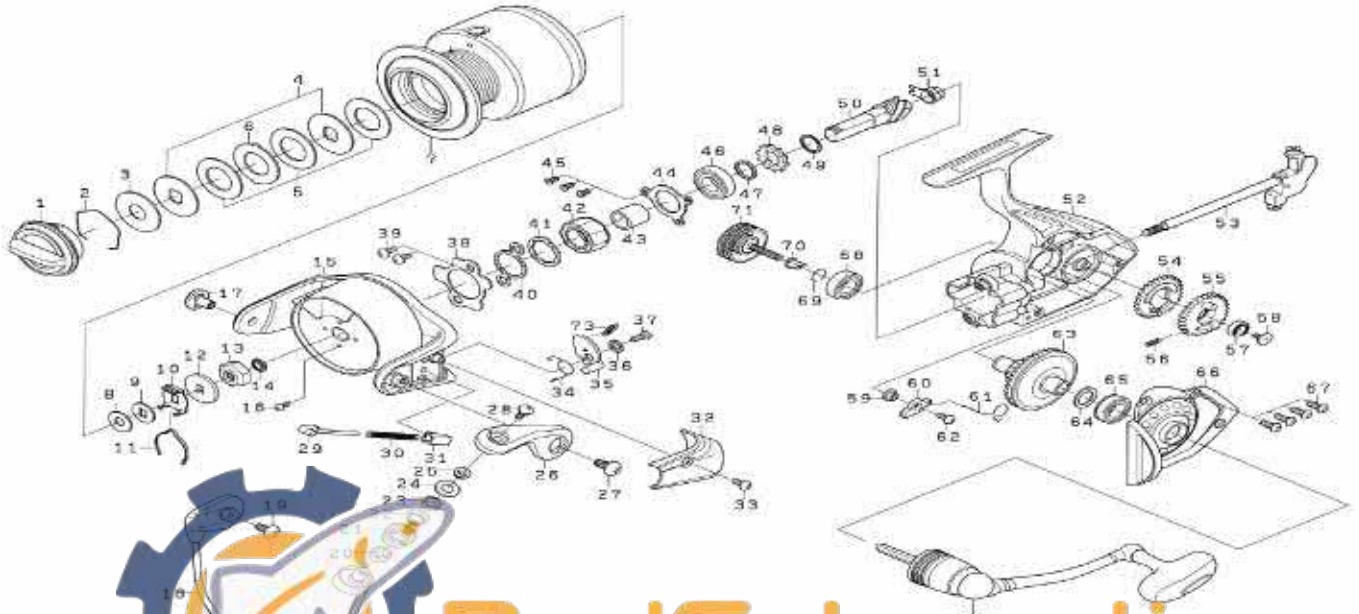

ReelSchematic

Key No. Parts No. Parts Name

1	H31-2701	Drag knob
2	F88-4001	Drag washer retainer
3	H38-0901	Drag washer (A)
4	H17-5101	Key washer
5	F69-1001	Drag washer (B)
6	G70-0701	Eared washer
8	F05-0100	Spool washer (A)
9	F05-0002	Spool washer (B)
10	H30-9501	Click leaf spring holder
11	B74-7701	Spool click leaf spring
12	F04-9901	Spool washer (C)
13	H30-9401	Rotor nut
14	G75-1201	Collar (A)
15	H24-5001	Rotor
16	G62-7701	Screw (A)
17	H24-5602	Bail holder nut
18	H37-5901	Bail assembly
19	351-6105	Screw (B)
20	H03-5502	Collar (B)
21	H24-6103	Line roller
22	G74-0601	Collar (C)
23	G37-0905	Ball bearing (A)
24	G74-0501	Packing
25	H27-1201	Collar (D)
26	H24-5401	Bail arm
27	G45-5601	Screw (C)
28	F60-8901	Screw (D)
29	H24-5301	Bail spring shaft
30	H34-5301	Bail spring
31	H27-0501	Bail spring holder
32	H24-5502	Bail spring cover
33	G20-5101	Screw (E)
34	H26-4401	Bail trip lever spring
35	H24-5901	Bail trip lever
36	375-3000	Bail trip lever washer
37	G19-3701	Screw (F)
38	H24-4202	Roller clutch retainer

Key No. Parts No. Parts Name

39	351-6101	Screw (G)
40	H24-4001	Clutch cam retainer
41	H24-7601	Clutch cam
42	G31-4501	Roller clutch
43	H17-2703	Spacing sleeve
44	H24-4501	Bearing retainer (A)
45	G55-7101	Screw (H)
46	G42-6301	Ball bearing (B)
47	H24-3901	Collar (E)
48	E26-2701	Ratchet
49	E33-9701	Washer (B)
50	H24-3801	Pinion gear
51	H24-3701	Collar (F)
52	H30-8301	Body assembly
53	H30-9601	Main shaft
54	H24-3101	Oscillating gear (A)
55	H24-3001	Oscillating gear (B)
56	G15-7401	Oscillating gear spring
57	G46-7102	Ball bearing (C)
58	H27-2201	Screw (I)
59	H24-3301	Collar (G)
60	H24-3201	Anti-reverse pawl
61	H24-4401	Spring
62	351-6401	Screw (J)
63	H24-4302	Drive gear
64	371-2800	Washer (C)
65	F24-0001	Ball bearing (D)
66	H31-3101	Side cover
67	G16-0101	Screw (K)
68	G52-2802	Ball bearing (E)
69	H04-7201	Bearing retainer (B)
70	F40-9001	Collar (H)
71	H05-1301	Handle screw
72	H32-2201	Handle assembly
73	G19-4301	Brake shoe
2~7	H30-9001	Spool assembly