

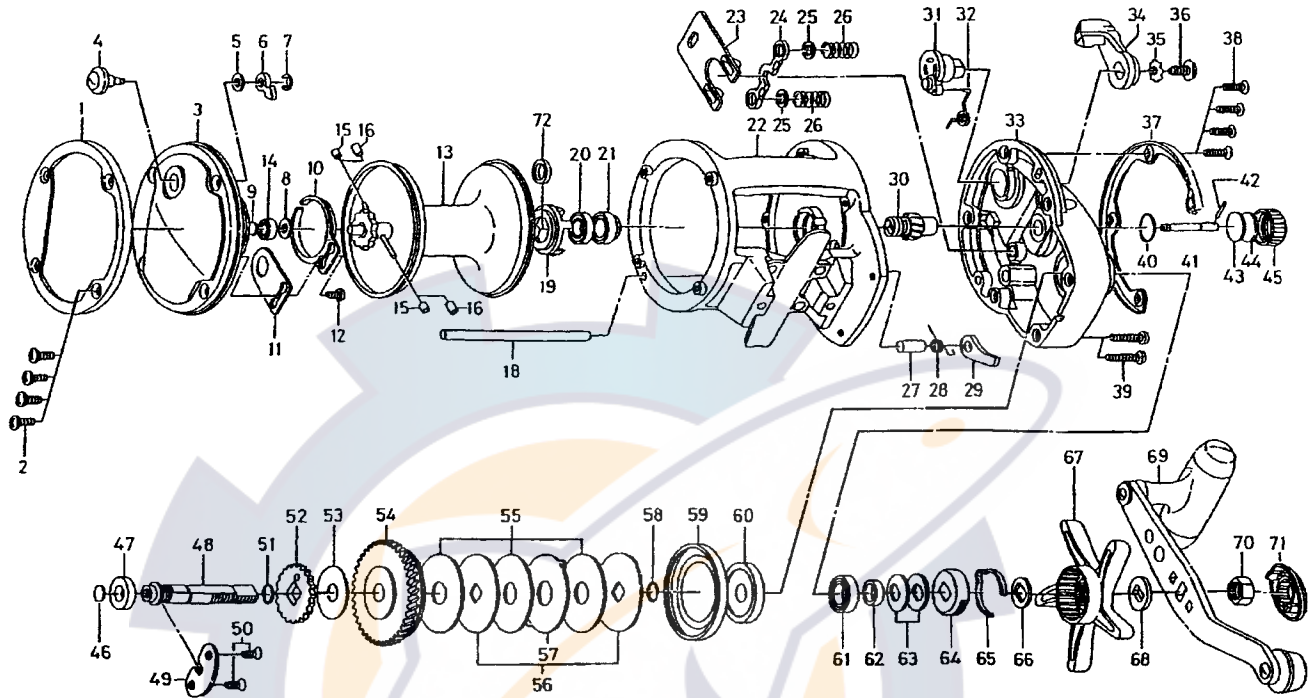

COMMITTED TO TOTAL QUALITY

CONVENTIONAL REEL

GRANDWAVE-X40SHVK / 50SHVK



Key No.	Parts No.	Parts Name	Key No.	Parts No.	Parts Name
1	F09-9402	L/S OUTER RING	42	F73-2801	PIN
2	F09-3601	L/S PLT SCREW	43	375-7501	SPACER B
3	F78-8502	L/S PLT	44	B17-5503	SPACER C
4	E36-1301	CLICK BUTTON	45	E31-5405	CAST CONTROL CAP
5	373-1602	CLICK BUTTON WASHER	46	F73-3501	DRIVE SHAFT WASHER
6	030-6222	CLICK PAWL	47	637-5702	BALL BEARING C
7	320-1402	CLICK PAWL RET	48	F73-3602	DRIVE SHAFT
8	F13-2602	SPACER A	49	F09-8401	DRIVE SHAFT RET
9	375-7411	BEARING WASHER	50	E31-6701	DRIVE SHAFT RET SCREW
10	160-7922	CLICK SPRING	51	F65-7801	O RING B
11	F13-1801	CLICK SPRING RET	52	F55-5102	A/R RATCHET
12	B83-4402	CLICK SPRING SCREW	53	F73-3701	DRIVE SHAFT WASHER B
13	F78-8601	SPOOL	54	F78-9901	DRIVE GEAR
14	637-2101	BALL BEARING A	55	F87-7501	DRAG WASHER
15	B35-2801	BRAKE COLLAR A	56	E31-7001	KEY WASHER
16	B35-2701	BRAKE COLLAR B	57	E31-7101	EARED WASHER
18	F73-6803	STABILIZER BAR	58	F65-7801	O RING C
19	F21-6201	BEARING RET	59	F73-3901	WATER SHIELD
20	636-6402	BALL BEARING B	60	F73-4001	BALL BEARING COLLAR
21	F73-3201	BUSHING A	61	B62-8201	BALL BEARING D
22	F79-1201	FRAME	62	F73-4201	COLLAR A
23	F09-7901	YOKE PLT	63	E25-3501	DRAG SPRING WASHER
24	E25-2102	YOKE	64	F47-0002	CLICK LEAF SPRING HOLDER
25	E03-7706	YOKE WASHER	65	B74-7702	CLICK LEAF SPRING
26	F93-5201	YOKE SPRING	66	F47-0101	FRICTION WASHER
27	F09-8201	A/R PAWL PIN	67	F55-0415	STAR DRAG
28	F77-4401	A/R PAWL SPRING	68	E25-3901	SPACING SLEEVE
29	F73-3401	A/R PAWL	69	F78-8001	HANDLE
30	F78-9801	PINION GEAR	70	B86-2102	HANDLE NUT
31	F09-7301	CLUTCH CAM	71	F47-1205	HANDLE NUT PLT
32	F38-5801	CLUTCH SPRING	72	F77-4701	COLLAR B
33	F09-6918	R/S PLT			
34	E42-6805	CLUTCH LEVER			
35	160-8001	CLUTCH LEVER LOCK WASHER			
36	E00-7602	CLUTCH LEVER SCREW			
37	F09-7203	R/S OUTER RING			
38	F09-3601	R/S PLT SCREW A			
39	F73-4302	R/S PLT SCREW B			
40	B05-5201	O RING			
41	F73-2701	PINION SHAFT			

**GW-X50SHVK Special Parts**

Key No.	Parts No.	Parts Name
3	F78-8202	L/S PLT
13	F78-8301	SPOOL
18	F09-9303	STABILIZER BAR
22	F79-0801	FRAME
33	F09-6917	R/S PLT