

# DAIWA BAITCASTING REEL

## LX - WN 300HS-P / H / HS

Please order by parts number, not key number  
Veuillez indiquer le numéro de la pièce (Non "Key" No.)

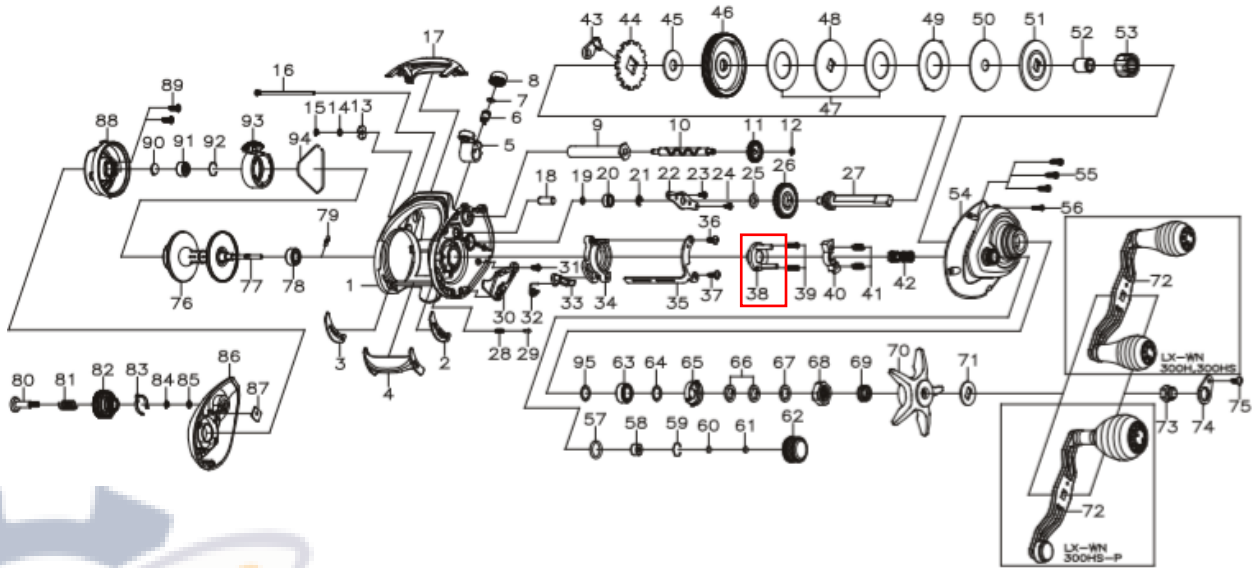

Key No	Part No	Description
1	702-2690	FRAME
2	410-4450	SPACER (A)
3	410-4460	SPACER (B)
4	090-0340	CLUTCH LEVER
5	490-1150	LINE GUIDE
6	400-2540	LINE GUIDE PAWL
7	540-3980	WASHER
8	380-7160	LINE PAWL CAP
9	270-0810	LEVEL WIND GUARD
10	470-1960	WORM SHAFT
11	240-2210	WORN SHAFT GEAR
12	200-0530	GEAR RETAINER
13	540-6060	WORM SHAFT GEAR
14	540-3930	WASHER
15	200-0530	WORM SHAFT RETAINER
16	460-4980	LONG SCREW
17	55A-1960	FRAME PLATE
18	400-2570	PIN
19	540-7250	WASHER
20	140-2030	BALL BEARING
21	200-0580	DRIBE GEAR SHAFT RETAINER
22	410-4491	PLATE
23	460-5370	SCREW
24	460-5290	SCREW
25	540-6600	WASHER
26	240-2200	OS GEAR
27	470-2510	DRAIVE SHAFT
28	510-5310	SPRING
29	400-2720	PIN
30	410-4470	PLATE
31	460-5370	SCREW
32	510-6610	KICK LEVER SPRING
33	330-3180	KICK LEVER
34	170-1510	CLUTCH CAM
35	410-4480	PLATE
36	460-1830	SCREW
37	460-8180	SCREW
38	410-4520	PLATE
39	460-4870	SCREW
40	080-0070	YOKE
41	510-6620	YOKE SPRING
42	260-2800	PINION GEAR
43	530-0860	ANTI REVERSE PAWL
44	240-4040	ANTI REVERSE RATCHET
45	540-9830	SPACER (C)
46	250-2260	DRIVE GEAR
47	540-6890	DRAG WASHER
48	540-8010	WASHER
49	540-8030	KEY WASHER
50	540-8080	DRAG WASHER
51	540-8020	TOP WASHER
52	150-2190	GEAR SHAFT COLLAR

Key No	Part No	Description
53	140-2640	ROLLER CLUTCH
54	702-2700	RIGHT SIDE PLATE
55	460-0450	SCREW
56	460-1131	SCREW
57	430-1110	O-RING
58	150-3240	BUSHING
59	430-1061	BEARING RETAINER
60	540-6850	SPACER (D)
61	540-4340	SPACER (E)
62	38A-3470	CAST CONTROL CAP
63	140-2040	BALL BEARING
64	540-1490	SPACING WASHER
65	510-5370	PLATE
66	540-6391	DRAG SPRING WASHER
67	540-9021	WASHER
68	380-3210	NUT
69	510-6130	SPRING
70	320-1480	STAR DRAG
71	540-9271	WASHER
72	702-2710	HANDLE ASSEMBLY
73	380-1810	HANDLE NUT
74	35B-0330	HANDLE NUT PLATE
75	460-5390	SCREW
76	702-2730	SPOOL AS
80	460-5571	SET PLATE SCREW
81	510-4450	SET PLATE SPRING
82	550-1980	BARKE ADJUSTING KNOB
83	510-5180	BRAKE CLICK SPRING
84	200-0530	BRAKE DIAL RETAINER (A)
85	540-5380	WASHER
86	702-2740	LEFT SIDE PLATE
87	410-1911	BRAKE DIAL RETAINER (B)
88	220-3210	SET PLATE
89	460-5460	SCREW
90	540-7190	WASHER
91	140-3310	BALL BEARING
92	430-0440	BEARING RETAINER
93	550-2060	MAGNET HOLDER
94	430-0971	MAGNET HOLDER RET RING
95	540-6340	WASHER

### LX-WN300HS-P Special Parts

Key No	Part No	Description
42	260-2820	PINION GEAR
46	250-2280	DRIVE GEAR
54	702-2880	RIGHT SIDE PLATE
72	702-2900	HANDLE ASSEMBLY

### LX-WN300HS Special Parts

Key No	Part No	Description
54	702-2870	RIGHT SIDE PLATE
72	702-2710	HANDLE ASSEMBLY