

# BAITCASTING REEL – Millionaire M35-2B/M37-2B

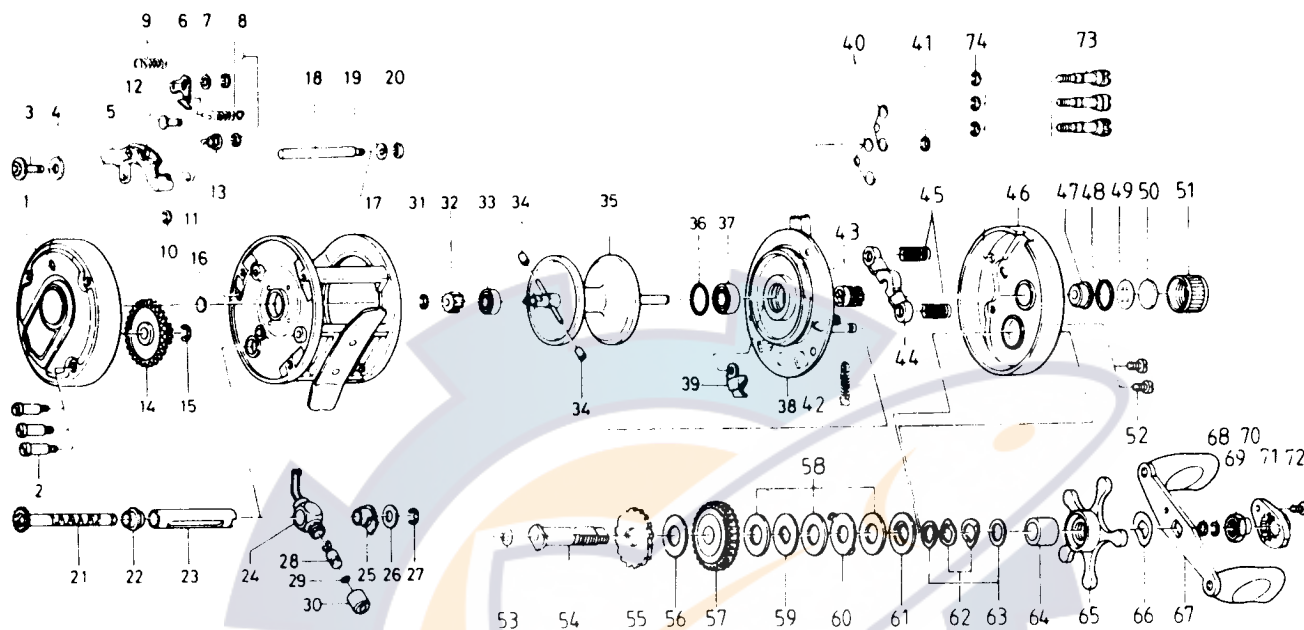

| Key No. | Parts No. | Parts Name                   |
|---------|-----------|------------------------------|
| 1       | K16-2303  | Left side plate assembly     |
| 2       | K16-9102  | Left side plate screw        |
| 3       | K16-4202  | Click button                 |
| 4       | K16-4101  | Click button washer          |
| 5       | K16-3701  | Click set plate              |
| 6       | K16-4301  | Click pawl                   |
| 7       | K16-4403  | Click pawl washer            |
| 8       | 320-5901  | Click pawl retainer          |
| 9       | K16-4501  | Click pawl spring            |
| 10      | 320-5901  | Click button retainer        |
| 11      | K16-4001  | Click set plate spring       |
| 12      | K16-3901  | Click set plate pin          |
| 13      | K16-3801  | Click pawl nut               |
| 14      | K16-3501  | Idle gear                    |
| 15      | K16-3601  | Idle gear retainer           |
| 16      | K16-4601  | Spacer A                     |
| 17      | K16-4701  | Frame assembly               |
| 18      | K16-7301  | Stabilizer bar               |
| 19      | K15-9801  | Stabilizer bar spring washer |
| 20      | 320-5901  | Stabilizer bar retainer      |
| 21      | K16-6301  | Worm shaft                   |
| 22      | K16-6801  | Worm bearing A               |
| 23      | K16-5701  | Level wind guard             |
| 24      | K16-6001  | Line guide                   |
| 25      | K16-5901  | Worm bearing B               |
| 26      | K16-4403  | Worm shaft holder washer     |
| 27      | 320-5901  | Worm shaft retainer          |
| 28      | K10-7001  | Line guide pawl              |
| 29      | K16-7101  | Line guide washer            |
| 30      | K16-7201  | Pawl cap                     |

| Key No. | Parts No. | Parts Name                |
|---------|-----------|---------------------------|
| 31      | B33-9801  | Bearing retainer          |
| 32      | K16-8801  | Spool gear                |
| 33      | K16-8701  | Bushing                   |
| 34      | K16-9001  | Brake collar              |
| 35      | K16-7601  | Spool assembly            |
| 36      | K15-8501  | "O" ring                  |
| 37      | K15-8701  | Bushing                   |
| 38      | K15-7201  | Set plate assembly        |
| 39      | K15-9501  | Anti-reverse pawl         |
| 40      | K15-8801  | Set plate spring A        |
| 41      | 320-1402  | Clutch retaining ring     |
| 42      | K15-8901  | Set plate spring B        |
| 43      | K15-9101  | Pinion gear               |
| 44      | K15-9001  | Yoke                      |
| 45      | K15-9401  | Yoke spring               |
| 46      | K15-6004  | Right side plate assembly |
| 47      | K15-6701  | Bush                      |
| 48      | K15-6601  | "O" ring                  |
| 49      | K15-6801  | Spacer B                  |
| 50      | K15-6901  | Spool tension spring      |
| 51      | K15-7002  | Cast control cap          |
| 52      | K16-0902  | Set plate screw           |
| 53      | K15-9801  | Drive shaft washer A      |
| 54      | K15-9901  | Drive shaft               |
| 55      | K16-0001  | Anti-reverse-ratchet      |
| 56      | K16-0101  | Drive shaft washer B      |
| 57      | K16-0201  | Drive gear                |
| 58      | K16-0102  | Drag washer A             |
| 59      | K16-0401  | Key washer A              |
| 60      | K16-0501  | Eared washer              |