

# MILLIIONAIRE-S250

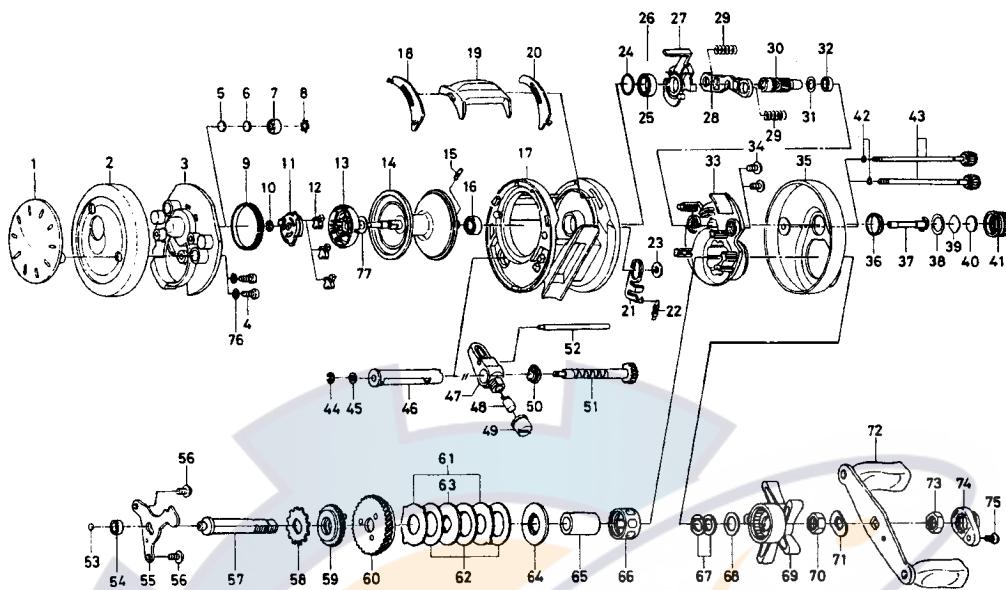

Key No.	Parts No.	Parts Name	Key No.	Parts No.	Parts Name
1	F84-7101	L/S COVER	41	F40-3003	CAST CONTROL CAP
2	F84-8101	L/S PLT	42	B85-3101	O RING B
3	F86-4601	LEFT SET PLT	43	B91-1730	R/S PLT SCREW
4	E15-7502	LEFT SET PLT SCREW	44	320-5901	WORM SHAFT RET
5	374-9103	SPACER A	45	373-1306	WORM SHAFT WASHER
6	374-9105	SPACER B	46	F84-6601	LEVEL WIND GUARD
7	G05-1801	BUSHING A	47	F86-4501	LINE GUIDE
8	F41-2301	BEARING RET	48	F96-6001	LINE GUIDE PAWL
9	F85-1601	L/S OUTER RING	49	F40-2802	PAWL CAP
10	320-5901	SHIELD PLT RET	50	F85-1301	WORM SHAFT HOLDER
11	F88-8801	SHIELD PLT	51	F84-6901	WORM SHAFT
12	F88-8901	BRAKE COLLAR	52	F87-8801	STABILIZER BAR
13	F88-8701	BRAKE ADJ KNOB	53	F64-7201	DRIVE SHAFT WASHER
14-16	F96-8301	SPOOL	54	F64-8301	BUSHING C
17	F84-8301	FRAME	55	F88-7801	DRIVE SHAFT RET
18	F84-7401	CLUTCH LEVER PLT A	56	351-7701	DRIVE SHAFT RET SCREW
19	F84-8501	CLUTCH LEVER	57	F84-6801	DRIVE SHAFT
20	F84-7301	CLUTCH LEVER PLT B	58	E32-7701	A/R RATCHET
21	F42-8801	CLUTCH TRIP PLT	59	F79-5901	DRIVE GEAR A
22	F63-9901	CLUTCH TRIP PLT SPRING	60	F79-6001	DRIVE GEAR B
23	F44-0201	CLUTCH TRIP PLT WASHER	61	F79-6101	EARED WASHER
24	F79-3401	CLUTCH CAM RET	62	F79-6201	DRAG WASHER
25	B86-1702	BALL BEARING A	63	F79-6301	KEY WASHER A
26	F96-7901	CLUTCH CAM SPRING	64	F79-6401	KEY WASHER B
27	F84-5701	CLUTCH CAM	65	F85-1501	GEAR SHAFT COLLAR
28	F84-7501	YOKE	66	F55-2701	ROLLER CLUTCH
29	F86-4101	YOKE SPRING	67	150-8901	DRAG SPRING WASHER
30	F84-5601	PINION GEAR	68	E42-5401	SPACING SLEEVE
31	F85-1901	PINION GEAR WASHER	69	F40-3203	STAR DRAG
32	G05-1901	BUSHING B	70	B43-3601	DRAG NUT
33	F84-7701	RIGHT SET PLT	71	150-9001	FRICTION WASHER
34	351-7701	SET PLT SCREW	72	F87-9301	HANDLE
35	F85-1201	R/S PLT	73	B86-2101	HANDLE NUT
36	F85-2001	COLLAR	74	E44-0004	HANDLE NUT PLT
37	F74-4101	PINION SHAFT	75	351-1801	HANDLE NUT PLT SCREW
38	171-5201	O RING A	76	B53-6104	LEFT SET PLT SCREW RET
39	B17-5402	SPOOL ADJ CAP METAL A	77	F57-4303	BRAKE ADJ KNOB WASHER
40	B17-5503	SPOOL ADJ CAP METAL B			