

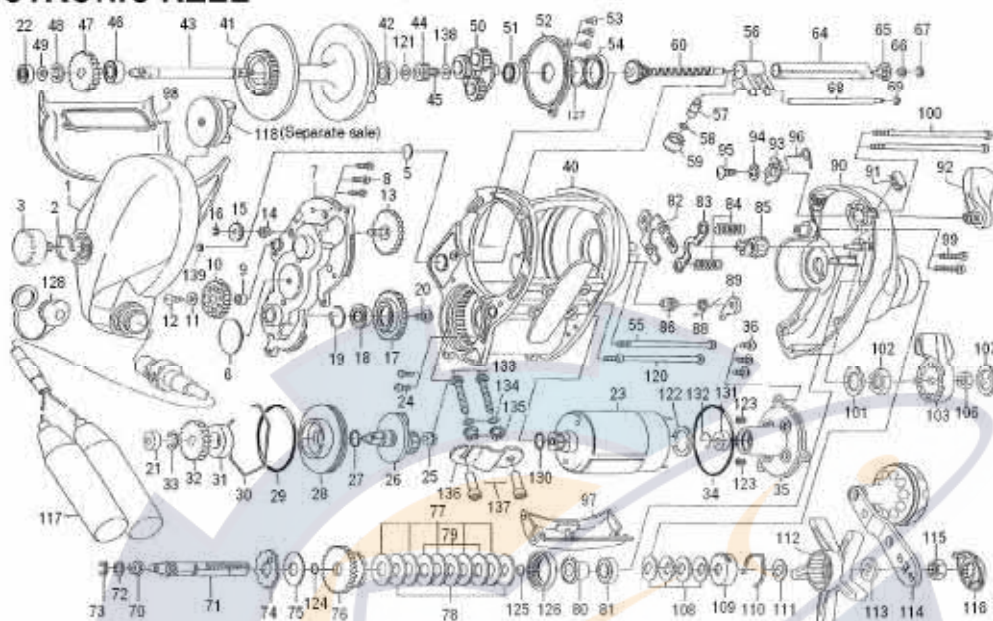

Please order by parts number, not key number

Tanacom Full 10000



Key

No.	Parts No.	Parts Name
1	G37-9906	IC MODULE L/S PLT SET
2	E03-3201	BRAKE CLICK SPRING
3	E48-9621	BRAKE ADJ KNOB
5	G22-5102	BRAKE ADJ KNOB WASHER
6	F59-2801	BRAKE DIAL WASHER
7	F59-1901	SET PLT
8	351-0901	SET PLT SCREW
9	F57-3101	IDLE GEAR A COLLAR
10	F59-2101	IDLE GEAR A
11	F57-1902	IDEL GEAR A SCREW WASHER
12	351-7705	IDLE GEAR A SCREW
13	G14-0001	IDLE GEAR C
14	F59-2501	IDLE GEAR B COLLAR
15	F59-2602	IDLE GEAR B
16	320-5901	IDLE GEAR RET
17	G22-5201	MOTOR GEAR A
18	G07-0301	BALL BEARING A
19	G07-0201	MOTOR GEAR A RET
20	353-8207	MOTOR GEAR A SCREW
21	637-5601	MOTOR GEAR C BUSHING
22	637-2102	BALL BEARING B
23	G81-1901	MOTOR
24	G38-5901	MOTOR SCREW
25	E29-2901	MOTOR GEAR B BUSHING
26	G14-1302	MOTOR GEAR B
27	F71-4801	MOTOR GEAR O RING
28	F73-9601	MOTOR CASE PLT
29	F59-5801	MOTOR CASE O RING
30	F59-5901	MOTOR CASE RING
31	F73-9701	MOTOR CASE BUSHING
32	G22-5701	MOTOR GEAR C
33	320-1611	YOKE SPRING RET
34	F59-5301	MOTOR HOLDER O RING
35	G36-2601	MOTOR HOLDER
36	351-6101	MOTOR HOLDER SCREW
40	G38-2502	FRAME
41	G81-1501	SPOOL
42	F71-3701	SPOOL BUSHING
43	G81-1701	SPOOL SHAFT
44	G12-6402	SPOOL GEAR
45	320-5901	SPOOL SHAFT GEAR RET
46	F71-3701	SPOOL BUSHING
47	G22-5701	SPOOL SHAFT GEAR

Key

No.	Parts No.	Parts Name
48	320-1611	SPOOL GEAR RET
49	B41-1702	WORM SHAFT HOLDER WASHER
50	G81-1801	MOTOR GEAR D
51	G15-6801	BALL BEARING C
52	F59-4104	SPOOL PLT
53	F20-6901	SPOOL PLT SCREW
54	F38-9102	BALL BEARING D
55	G36-3001	L/S PLT SCREW A
56	G81-2102	LINE GUIDE
57	122-0601	LINE GUIDE PAWL
58	F77-4600	LINE GUIDE PAWL WASHER
59	E35-4101	PAWL CAP
60	G83-5401	WORM SHAFT
64	G36-2801	WORM SHIELD
65	F46-7201	WORM SHAFT BUSH
66	B41-1706	WORM SHAFT WASHER
67	320-5901	WORM SHAFT RET
68	G36-2901	LEVEL WIND POST
69	B86-4101	LEVEL WIND POST RET
70	E25-2501	DRIVE SHAFT BUSH
71	F71-5302	DRIVE SHAFT
72	375-5801	DRIVE SHAFT WASHER A
73	320-7601	DRIVE SHAFT RET
74	F59-7301	A/R RATCHET
75	374-6604	DRIVE SHAFT WASHER B
76	G81-2001	DRIVE GEAR
77	B36-0209	DRAG WASHER
78	372-3833	KEY WASHER
79	B36-0302	EARED WASHER
80	G82-9001	DRAG COLLAR A
81	F71-5601	DRAG COLLAR B
82	F59-7001	YOKE PLT
83	E29-0601	YOKE
84	G47-3401	YOKE SPRING
85	F74-0201	PINION GEAR
86	F77-3001	SPRING HOLDER
88	F60-8301	A/R PAWL SPRING
89	F59-7201	A/R PAWL
90	G81-2601	R/S PLT
91	E28-6001	LINE HOLDER
92	F46-9006	CLUTCH LEVER
93	F59-7901	CLUTCH CAM

Key

No.	Parts No.	Parts Name
94	160-8001	CLUTCH LEVER WASHER
95	353-8207	CLUTCH LEVER SCREW
96	F59-8201	CLUTCH CAM SPRING
97	G37-4502	MOTOR COVER
98	G37-4802	FINGER GUARD
99	353-8705	R/S PLT SCREW A
100	G40-5901	R/S PLT SCREW B
101	F28-5901	POWER LEVER WASHER
102	F30-3102	POWER LEVER NUT A
103	F42-9701	POWER LEVER
106	342-4004	POWER LEVER NUT B
107	F43-0002	POWER LEVER COVER
108	E25-3501	DRAG SPRING WASHER
109	F47-0002	DRAG HOLDER
110	B74-7702	DRAG HOLDER LEAF SPRING
111	F47-0101	FRICTION WASHER
112	F55-0415	STAR DRAG
113	F47-0303	HANDLE COLLAR
114	G91-9201	HANDLE
115	B86-2102	HANDLE NUT
116	F47-1205	HANDLE NUT PLT
117	G86-8701	ELECTRIC POWER CORD
118	Z01-0626	INPUT ROLLER
120	G36-3101	L/S PLT SCREW B
121	371-6906	SPOOL SHAFT WASHER
122	F70-1201	MOTOR WASHER
123	G17-3401	CORD SHIELD
124	F65-7801	O RING
125	F65-7801	O RING
126	F81-7001	DRAG COLLAR SHILED
127	F68-2600	SPOOL PLT WASHER
128	F66-1002	CONNECTOR CAP
130	G48-8801	MOTOR O RING
131	F07-8301	MOTOR HOLDER BUSHING RING
132	B27-0501	BALL BEARING RET
133	F18-7601	ROD CLAMP BOLT
134	B93-7802	ROD CLAMP BOLT RET
135	F18-7801	CLAMP NUT
136	041-9901	ROD CLAMP
137	342-5301	ROD CLAMP LOCKING NUT
138	F77-4600	SPOOL GEAR WASHER
139	320-5901	BRAKE ADJ KNOB RET