

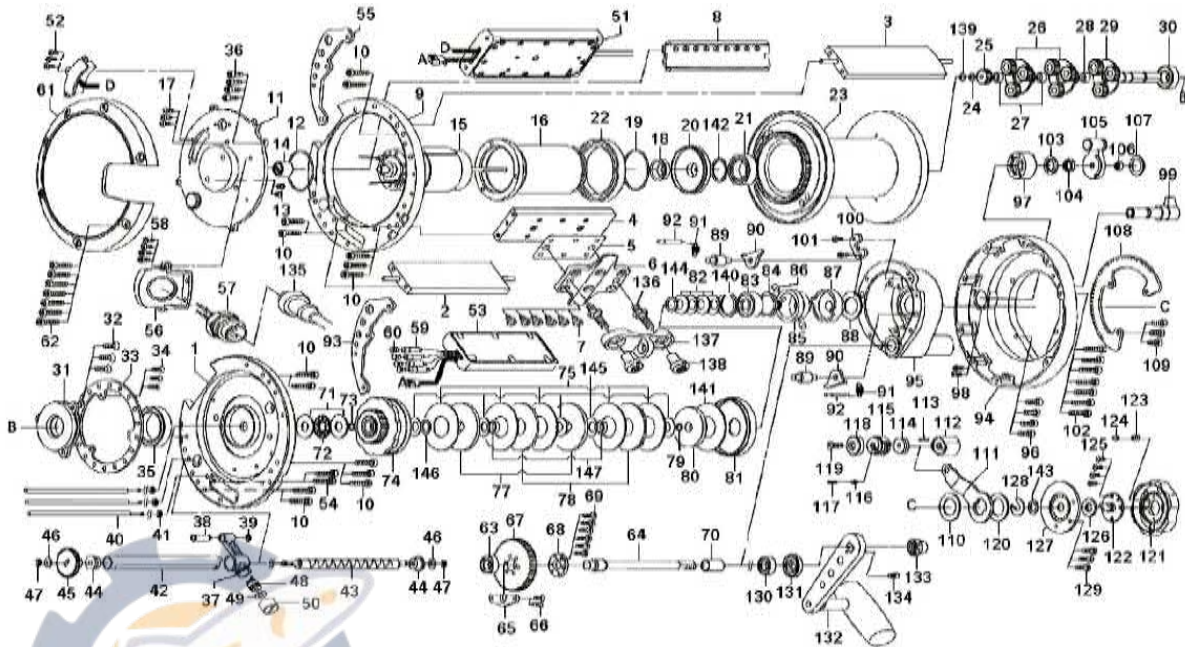

ELECTRONIC REEL

MARINE POWER 3000-12V

Please order by parts number, not key number
Veuillez indiquer le numéro de la pièce (Non "Key" No.)



Key No.	Part No.	Part Name	Key No.	Part No.	Part Name	Key No.	Part No.	Part Name
1	G43-1401	SET PLATE	49	373-2700	WASHER	97	G44-1801	POWER LEVER COLLAR
2	G43-1501	PALMING PLATE (A)	50	G43-8601	PAWL CAP	98	351-1106	SIDE COVER SCREW
3	G43-1502	PALMING PLATE (B)	51	G43-0604	IC MODULE	99	G44-2001	CLICK LEVER
4	G43-1801	STAND PLATE	52	352-2506	SCREW	100	G44-2401	CLICK LEVER RETAINER
5	G44-4401	STAND PLATE	53	G53-4101	POWER MODULE	101	351-6601	SCREW
6	G43-1901	STAND	54	G50-6301	SCREW	102	G50-6201	SCREW
7	G43-2001	STAND SCREW	55-93	G43-8901	IC MODULE PROTECTOR PLT	103	F28-5901	POWER LEVER WASHER
8	G43-2101	FINGER GUARD	56	G43-9001	RECEPTACLE HOLDER	104	G13-9601	POWER LEVER NUT A
9	G43-2201	L/S RING	57	G43-9101	RECEPTACLE	105	G44-2501	POWER LEVER
10	G50-6301	RING PLATE SCREW	58	G16-0101	SCREW	106	342-4004	POWER LEVER NUT B
11	G43-2402	LEFT SET PLATE	59	F68-2001	POWER CORD COVER (A)	107	F43-0002	POWER LEVER COVER
12-19	F59-5801	MOTOR CASE O-RING	60	F68-2101	POWER CORD COVER (B)	108	G44-3002	DRAG LEVER PLATE
13	G43-7701	MOTOR CORD COVER	61	G43-9301	L/S PLATE	109	G43-7401	SCREW
14	G43-3901	MOTOR METAL	62	G50-6201	SIDE PLATE SCREW	110	K30-0801	WASHER
15	G43-4202	MOTOR	63	G43-9402	BALL BEARING	111	G44-3401	DRAG LEVER
16	G43-4701	MOTOR HOLDER	64	G43-9501	DRIVE SHAFT	112	G44-3501	DRAG LEVER METAL
17	G43-7401	SCREW	65	G43-9601	DRIVE SHAFT RETAINER	113	G52-0401	DRAG LEVER METAL PIN
18	G43-4901	MOTOR HOLDER SHIELD	66	351-8903	SCREW	114	G44-3601	DRAG LEVER METAL WASHER
20	G50-7101	MOTOR HOLDER PLATE	67	G43-9701	DRIVE GEAR	115	G44-3701	DRAG LEVER COLLAR
21	G50-1101	BALL BEARING	68	G43-9801	DRIVE GEAR PLATE	116	F28-8001	PIN
22	G43-4801	BALL BEARING	69	351-6413	SCREW	117	G29-4201	POWER LEVER SPRING
23	G43-5301	SPOOL	70	G43-9901	DRIVE SHAFT BUSHING	118	G44-3801	DRAG LEVER CAP
24	G50-6401	SPOOL GEAR WASHER	71	G44-5601	WASHER	119	G51-5201	DRAG LEVER SCREW
25	G43-5801	SPOOL GEAR (A)	72	G44-5701	DRAG HOLDER BEARING	120	K30-0801	WASHER
26	G53-7701	SPOOL GEAR (B)	73-79	F65-7801	O-RING	121	G44-4101	PRE-SET DRAG KNOB
27	G56-1901	SPOOL BEAR BUSHING	74	G44-0001	DRAG HOLDER	122	G44-4201	PRE-SET METAL
28	G56-1801	SPOOL GEAR BUSHING	75	G44-0401	DRAG WASHER	123	K30-2601	PRE-SET DRAG SPRING
29	G43-6501	SPOOL GEAR C	77	G44-0601	KEY WASHER	124	K30-2501	DRAG PIN
30	G43-6902	BALL BEARING	78	G44-0701	EARED WASHER	125	E13-4503	SCREW
31	G43-7001	SPOOL PLATE	80	G44-0901	DRAG COLLAR	126	G44-4001	PRE-SET METAL WASHER
32	G43-7101	SPOOL PLATE SCREW	81	G44-0801	DRAG COLLAR SHIELD	127	G44-4301	COVER PLATE
33	G43-7201	CLICK PLATE	82	G44-1001	DRAG SPRING WASHER	128	K30-2201	RETAINER
34	E29-3001	SCREW	83	B88-7801	BALL BEARING	129	351-6413	SCREW
35	G43-7301	BALL BEARING	84	G56-2301	ECCENTRICK CAM SCREW	130	G43-9402	BALL BEARING
36	G43-7401	SCREW	85	G56-2201	SLEEVE	131	G44-4501	DRIVE SHAFT CAP
37	G43-7601	LEVEL WIND	86	G50-0701	ELECTRIC CAM PIN	132	G51-6601	HANDLE
38	G43-7801	LEVEL WIND COLLAR	87	G44-1101	ECCENTRICK CAM	133	G44-5101	HANDLE NUT
39	F67-3501	RETAINER	88	K30-0801	WASHER	134	G21-8201	SCREW
40	G43-8001	LEVEL WIND POST	89	G44-1201	A/R PAWL PIN	135	F04-2805	POWER CORD
41	G27-0601	RETAINER	90	G44-1301	A/R PAWL	136	G44-5301	CLAMP BOLT
42	G43-8101	WORM SHIELD	91	G44-1401	A/R PAWL SPRING	137	K30-9201	ROD CLAMP
43	G43-8201	WORM SHAFT	92	G44-1501	A/R PAWL SPRING PIN	138	G44-5401	CLAMP NUT
44	G43-8301	WORM SHAFT BUSHING	94	G44-1601	R/S PLATE	139	375-3000	WASHER
45	G43-8401	WORM SHAFT GEAR	95	G44-1701	SID PLATE SCREW	140	G56-2401	DRAG RING
46	373-2702	WASHER	96	G43-2001	STAND SCREW	141	G56-2001	DRAG COLLAR WASHER
47	320-1402	RETAINER						
48	G43-8501	LINE GUIDE PAWL						