

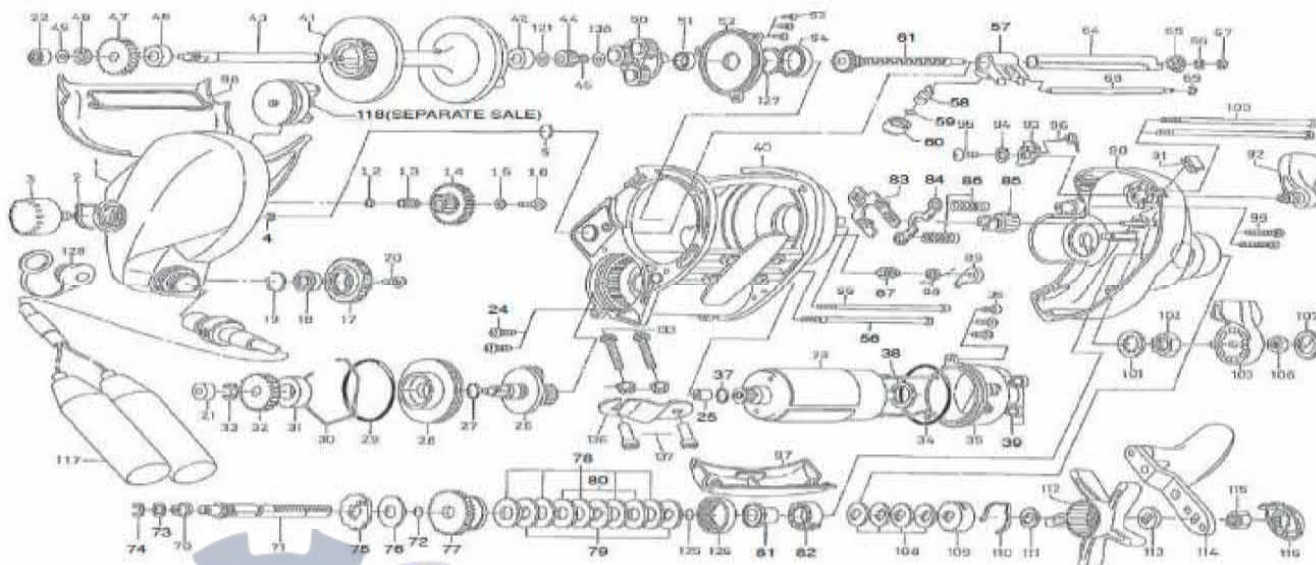

Please order by parts number, not key number  
 Veuillez indiquer le numéro de la pièce (Non "Key" No.)

# ELECTRONIC REEL

# TANACOM BULL 750



Key No.	Parts No.	Parts Name	Key No.	Parts No.	Parts Name
1	H37-7601	IC MODULE L/S PLATE SET	68	F59-6601	LEVELWIND POST
2	E03-3201	BRAKE CLICK SPRING	69	B86-4101	LEVELWIND POST RETAINER
3	E48-9621	BRAKE ADJ KNOB	70	E25-2501	DRIVE SHAFT BUSHING
4	320-5901	MECHANICAL BRAKE KNOB RETAINER	71	F71-5303	DRIVE SHAFT
5	G22-5102	MECHANICAL BRAKE WASHER	72	F65-7801	DRAG O RING
12	E09-6504	IDLE GEAR(A) WASHER	73	375-5801	DRIVE SHAFT WASHER
13	H43-9801	IDLE GEAR(A) COLLAR	74	320-7601	DRIVE SHAFT WASHER RETAINER
14	H43-9901	IDLE GEAR(A)	75	F59-7301	RATCHET
15	F57-1902	IDLE GEAR(A) SCREW WASHER	76	374-6804	DRIVE SHAFT WASHER (B)
16	351-7706	IDLE GEAR(A) SCREW	77	G81-2001	DRIVE GEAR
17	G22-5201	IDLE GEAR(B)	78	B36-0209	EARED WASHER
18	G07-0301	IDLE GEAR(B) BALL BEARING	79	372-3833	DRAG DISC WASHER
19	G07-0201	IDLE GEAR(B) RING	80	B36-0302	DRAG LIP WASHER
20	353-8207	IDLE GEAR(B) SCREW	81	G82-9001	DRAG COLLAR (A)
21	637-5601	MOTOR GEAR(A) BUSHING	82	F71-5601	DRAG COLLAR (B)
22	637-2102	SPOOL SHAFT BALL BEARING	83	F59-7001	YOKE PLATE
23	G81-0402	MOTOR	84	E29-0601	YOKE
24	F70-1101	MOTOR SCREW	85	F74-0201	PINION GEAR
25	E29-2901	MOTOR GEAR (A) BUSHING	86	G12-7001	YOKE SPRING
26	G14-1302	MOTOR GEAR (A)	87	F77-3001	SPRING HOLDER
27	F71-4801	MOTOR GEAR (A) O RING	88	F60-8301	ANTI-REVERSE PAWL SPRING
28	F73-9601	MOTOR CASE PLATE	89	F59-7201	ANTI-REVERSE PAWL
29	F59-5801	MOTOR CASE O RING	90	G81-2601	R/S PLATE
30	F59-5901	MOTOR CASE RING	91	E28-6001	LINE HOLDER
31	F73-9701	MOTOR CASE BUSHING	92	F46-9006	CLUTCH LEVER
32	G22-5701	MOTOR GEAR (B)	93	F59-7901	CLUTCH CAM
33	320-1611	MOTOR GEAR (B) RETAINER	94	160-8001	CLUTCH LEVER WASHER
34	F59-5301	MOTOR HOLDER O RING	95	353-8212	CLUTCH LEVER SCREW
35	F59-5101	MOTOR HOLDER	96	F59-8201	CLUTCH CAM SPRING
36	351-6101	MOTOR HOLDER SCREW	97	F59-6910	MOTOR COVER
37	G48-8801	MOTOR O RING	98	F59-7609	FINGER COVER
38	F70-1201	MOTOR WASHER	99	353-8705	R/S PLATE SCREW(A)
39	F71-4601	CORD SHIELD	100	F59-8301	R/S PLATE SCREW(B)
40	G98-8901	FRAME	101	F28-5901	POWER LEVER WASHER
41	G78-0603	SPOOL	102	F30-3102	POWER LEVER NUT(A)
42	F81-7101	SPOOL SHAFT BUSHING	103	F42-9701	POWER LEVER
43	G22-5601	SPOOL SHAFT	106	342-4004	POWER LEVER NUT(B)
44	G12-6402	SPOOL SHAFT GEAR (A)	107	F43-0002	POWER LEVER COVER
45	G12-6501	SPOOL SHAFT GEAR (A) RETAINER	108	E25-3501	DRAG SPRING WASHER
46	636-6403	SPOOL SHAFT BALL BEARING	109	F47-0002	DRAG HOLDER
47	G22-5701	SPOOL SHAFT GEAR (B)	110	B74-7702	DRAG HOLDER LEAF SPRING
48	320-1611	SPOOL SHAFT GEAR (B) RETAINER	111	F47-0101	DRAG HOLDER WASHER
49	B41-1700	SPOOL SHAFT GEAR (B) WASHER	112	F55-0415	STAR DRAG
50	G12-6602	MOTOR GEAR(D)	113	F47-0303	HANDLE COLLAR
51	F59-4001	MOTOR GEAR(D) BUSHING	114	G67-8101	HANDLE
52	F59-4101	SPOOL PLATE	115	B86-2102	HANDLE NUT
53	F20-6901	SPOOL PLATE SCREW	116	F47-1205	HANDLE CAP
54	F38-9102	SPOOL PLATE BALL BEARING	117	G86-8701	ELECTRIC POWER CORD
55	F55-6501	FRAME SCREW (A)	118	Z01-0626	INPUT ROLLER (SEPARATE SALE)
56	F63-9701	FRAME SCREW (B)	121	371-6906	SPOOL SHAFT BUSHING WASHER (B)
57	G81-2102	LEVELWIND	125	F65-7801	DRAG O RING
58	122-0602	LEVELWIND PAWL	126	F81-7001	DRAG COLLAR SHIELD
59	F95-0200	LEVELWIND WASHER	127	F68-2600	SPOOL PLATE WASHER
60	E35-4101	LEVELWIND NUT	128	F66-1002	CONNECTOR CAP
61	G83-4701	WORM SHAFT	133	F18-7601	CLAMP SHAFT SCREW
64	F59-6501	WORM SHIELD	135	F18-7801	CLAMP SHAFT NUT
65	F46-7201	WORM SHAFT BUSHING (R)	136	041-5601	CLAMP PLATE
66	B41-1706	WORM SHAFT WASHER	137	F18-7701	CLAMP PLATE NUT
67	320-5901	WORM SHAFT RETAINER	138	375-4100	SPOOL GEAR WASHER