

# BAITCASTING REEL PROCASTER PR-X153i

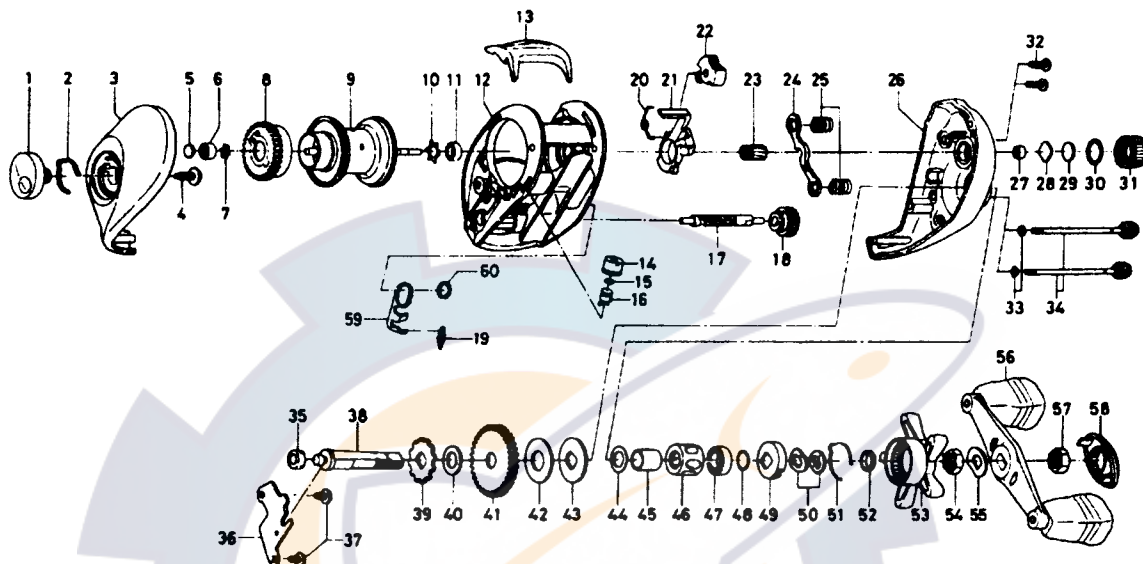

| Key No. | Parts No. | Parts Name                 | Key No. | Parts No. | Parts Name                 |
|---------|-----------|----------------------------|---------|-----------|----------------------------|
| 1       | F40-3603  | Brake, adjusting knob      | 33      | B85-3101  | "O" ring B                 |
| 2       | F03-2401  | Brake click spring         | 34      | B91-1727  | Right side plate screw     |
| 3       | F40-3303  | Left side plate            | 35      | B35-8601  | Ball bearing D             |
| 4       | B84-2102  | Brake adjusting knob screw | 36      | F43-9701  | Drive shaft retainer       |
| 5       | 374-9102  | Spacer A                   | 37      | F21-2201  | Drive shaft retainer screw |
| 6       | E08-8001  | Ball bearing A             | 38      | F41-1201  | Drive shaft                |
| 7       | F41-2301  | Bearing retainer A         | 39      | E32-7701  | Anti-reverse ratchet       |
| 8       | E23-9501  | Magnet holder              | 40      | 375-7103  | Drive shaft washer         |
| 9       | F40-8501  | Spool assembly             | 41      | F40-2501  | Drive gear                 |
| 10      | F45-0601  | Bearing retainer B         | 42      | B36-0209  | Drag washer                |
| 11      | B35-8601  | Ball bearing B             | 43      | B36-0303  | Key washer                 |
| 12      | F40-8801  | Frame assembly             | 44      | E42-5401  | Spacing sleeve A           |
| 13      | F40-2003  | Clutch lever               | 45      | F40-7901  | Gear shaft collar          |
| 14      | F40-2801  | Pawl cap                   | 46      | F40-8001  | Roller clutch              |
| 15      | 375-4101  | Line guide washer          | 47      | F05-5501  | Ball bearing E             |
| 16      | 121-4214  | Line guide pawl            | 48      | B55-3801  | Bearing washer             |
| 17      | E45-1201  | Worm shaft                 | 49      | F02-8201  | Click leaf spring holder   |
| 18      | F06-1301  | Worm shaft gear            | 50      | 150-8901  | Drag spring washer         |
| 19      | 144-2501  | Clutch trip plate spring   | 51      | F03-2401  | Click leaf spring          |
| 20      | E24-9001  | Clutch cam spring          | 52      | B97-4901  | Spacing sleeve B           |
| 21      | E23-7401  | Clutch cam                 | 53      | F40-3203  | Star drag                  |
| 22      | E24-9103  | Flipping/casting selector  | 54      | B43-3601  | Drag nut                   |
| 23      | F40-9202  | Pinion gear                | 55      | 150-9001  | Friction washer            |
| 24      | E23-7701  | Yoke                       | 56      | F40-8901  | Handle assembly            |
| 25      | E16-7101  | Yoke spring                | 57      | B43-3601  | Handle nut                 |
| 26      | F40-7810  | Right side plate           | 58      | F40-8402  | Handle nut retainer        |
| 27      | E24-8501  | Ball bearing C             | 59      | F42-8801  | Clutch trip plate          |
| 28      | B17-5401  | Spool adjusting cap metal  | 60      | F44-0201  | Clutch trip plate washer   |
| 29      | B17-5503  | Spacer B                   |         |           |                            |
| 30      | 171-5201  | "O" ring A                 |         |           |                            |
| 31      | F40-3003  | Cast control cap           |         |           |                            |
| 32      | E33-0401  | Set plate screw            |         |           |                            |