

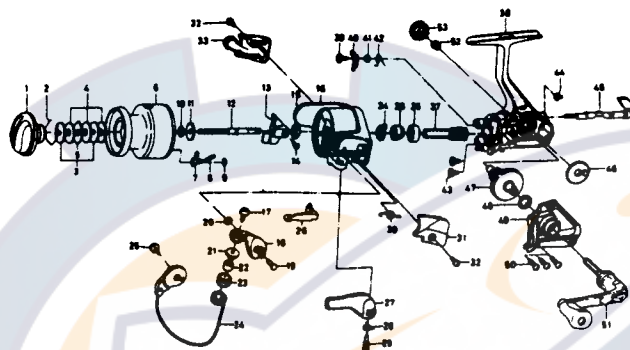

Please order by part number, not key number.

SPINNING REEL REGAL RG-X1505B/REG-X2005B



Key No.	Parts No.	Parts Name	Key No.	Parts No.	Parts Name
2-9	F33-0604	Spool assembly	31	F32-4104	Bail spring cover
1	F32-8504	Drag knob	32	E24-8101	Bail spring cover screw
2	F37-3301	Drag washer retainer	33	F32-6504	Sail trip cover
3	E46-7201	Key washer	34	F12-2101	Anti-reverse pawl spring A
4	E13-6001	Drag washer	35	E49-8501	Anti-reverse ratchet
5	373-3603	Eared washer	36	634-1301	Ball bearing
6	F33-0704	Spool	37	F12-1601	Pinion gear
7	807-5304	Click pawl	38	F41-9201	Body assembly
8	E40-3101	Click spring	39	F12-5701	Anti-reverse pawl screw
9	320-5901	Click retainer	40	F12-1901	Anti-reverse pawl
10	E46-7101	Spool washer	41	F12-3501	Anti-reverse pawl collar
11	270-6501	Click gear	42	F12-3401	Anti-reverse pawl spring B
12	E49-8401	Main shaft	43	E03-7801	Bearing retainer screw
13	F12-2301	Oscillating slider	44	F12-2001	Anti-reverse cam spring
14	351-0311	Oscillating slider screw	45	F08-5123	Anti-reverse lever
15	341-9201	Rotor nut	46	F12-2201	Oscillating gear
16	F33-1404	Rotor assembly	47	F12-1501	Drive gear
17	B67-9306	Line roller screw	48	375-8502	Drive gear washer
18	F17-3103	Bail arm	49	F19-9002	Side cover
19	E49-3501	Bail arm screw	50	E15-8602	Side cover screw
20	320-5901	Bail arm screw retainer	51	F41-9301	Handle assembly
21	F06-6301	Line roller collar	52	501-8501	Handle collar
22	F31-6801	Line roller bushing	53	B92-5006	Handle lock screw
23	E50-6001	Line roller			
24	F33-1701	Bail assembly			
25	884-2102	Bail trip cam screw			
26	E49-6401	Bail trip lever			
27	E49-3405	Trigger lever			
28	E36-9901	Trigger spring			
29	E37-0002	Trigger screw			
30	E49-6801	Bail spring			

RG-X2005 Special Parts					
Key No.	Parts No.	Parts Name	Key No.	Parts No.	Parts Name
2-9	F33-2304	Spool assembly			
16	F39-9804	Rotor assembly			
26	E49-6501	Bail trip lever			
38	F41-9202	Body assembly			
49	F19-9003	Side cover			