

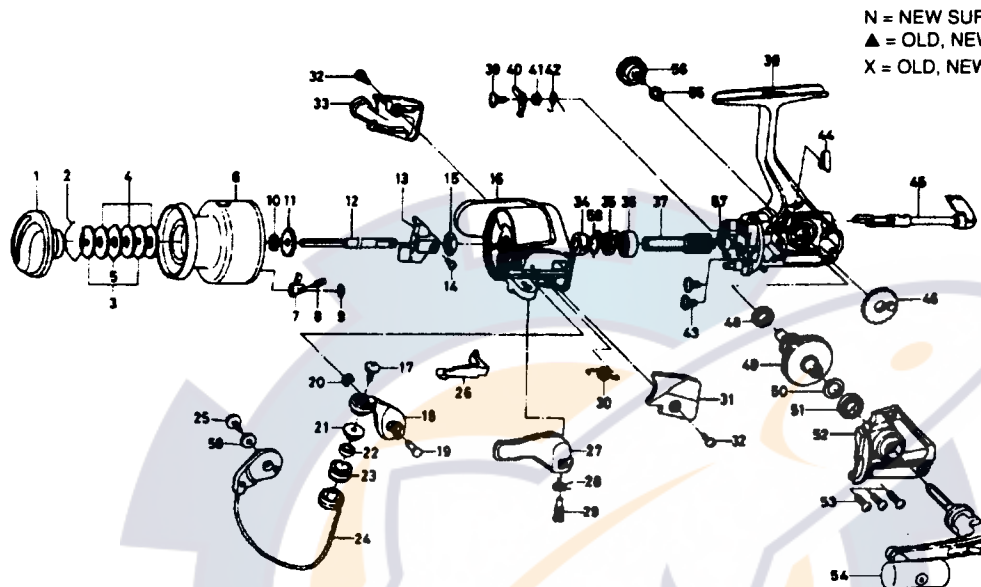

Please order by part number, not key number.

SPINNING REEL REGAL RG-Z2505BL (NEW)



N = NEW SUPPLEMENT PARTS
 ▲ = OLD, NEW INTERCHANGEABILITY
 X = OLD, NEW IS NOT INTERCHANGEABLE

Key NO.	Parts No.	Parts Name	Key NO.	Parts No.	Parts Name	
2-9	F32-5503	Spool assembly	37	X	F37-7501	Pinion gear
1	F28-0904	Drag knob	38	X	F37-8901	Body assembly
2	171-7701	Drag washer retainer	39		L00-1801	Anti-reverse pawl screw
3	E46-7201	Key washer	40	▲	F37-5001	Anti-reverse pawl
4	E13-6003	Drag washer	41		L01-4302	Anti-reverse pawl collar
5	373-3603	Eared washer	42		L00-1501	Anti-reverse pawl spring A
6	F32-5603	Spool assembly	43		E03-7801	Bearing retainer screw
7	B07-5304	Click pawl	44		E32-7801	Anti-reverse cam spring
8	E40-3101	Click spring	45		F08-5121	Anti-reverse lever
9	320-5901	Click retainer	46		E45-1301	Oscillating gear
10	E46-7101	Spool washer	48		E30-6801	Ball bearing C
11	270-6501	Click gear	49		F17-0001	Drive gear
12	▲ F38-9601	Main shaft	50		373-7800	Drive gear washer
13	E45-1401	Oscillating slider	51		631-6901	Ball bearing D
14	351-0315	Oscillating slider screw	52		F37-9202	Side cover
15	▲ F33-6102	Rotor nut	53		B00-9701	Side cover screw
16	▲ F41-0701	Rotor	54		F32-7003	Handle assembly
17	B67-9304	Line roller screw	55	▲	F40-4801	Handle collar
18	F17-9803	Bail arm	56		F03-5605	Handle lock screw
19	E49-3501	Bail arm screw	57	N	E24-3301	Pinion collar
20	320-5901	Bail arm screw retainer	58	N	F38-4701	Anti-reverse pawl spring B
21	X F40-1401	Line roller collar	59	N	F40-1001	Bail holder washer
22	F05-5601	Ball bearing A				
23	F05-8901	Line roller				
24	F32-7401	Bail assembly				
25	B84-2102	Bail trip cam screw				
26	E45-1601	Bail trip lever				
27	F18-0003	Trigger lever				
28	E36-9901	Trigger spring				
29	E41-7801	Trigger screw				
30	F12-8901	Bail spring				
31	F31-0503	Bail spring cover				
32	E24-8101	Bail spring cover screw				
33	F31-0603	Bail trip cover				
34	E49-2402	Anti-reverse ratchet				
35	N F37-5101	Spring holder				
36	L03-6601	Ball bearing B				