

# SPINNING REEL REGAL-S2505B

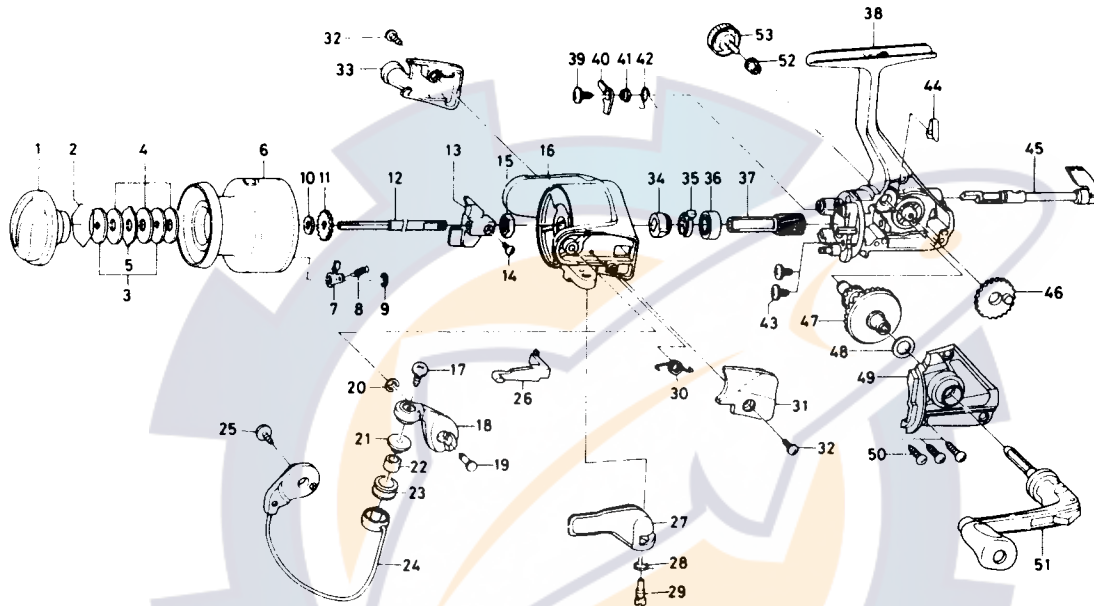

| Key No. | Parts No. | Parts Name               |
|---------|-----------|--------------------------|
| 2-9     | F32-0501  | Spool assembly           |
| 1       | F32-2101  | Drag knob                |
| 2       | 171-7701  | Drag washer retainer     |
| 3       | E46-7201  | Key washer               |
| 4       | E13-6003  | Drag washer              |
| 5       | 373-3603  | Eared washer             |
| 6       | F32-0601  | Spool assembly           |
| 7       | B07-5304  | Click pawl               |
| 8       | E40-3101  | Click spring             |
| 9       | 320-5901  | Click retainer           |
| 10      | E46-7101  | Spool washer             |
| 11      | 270-6501  | Click gear               |
| 12      | E48-4301  | Main shaft               |
| 13      | E45-1401  | Oscillating slider       |
| 14      | 351-0315  | Oscillating slider screw |
| 15      | 341-9201  | Rotor nut                |
| 16      | F32-1001  | Rotor                    |
| 17      | B67-9304  | Line roller screw        |
| 18      | F17-9802  | Bail arm                 |
| 19      | E49-3501  | Bail arm screw           |
| 20      | 320-5901  | Bail arm screw retainer  |
| 21      | F06-6301  | Line roller collar       |
| 22      | E50-5901  | Line roller bushing      |
| 23      | E50-6001  | Line roller              |
| 24      | F32-1101  | Bail assembly            |
| 25      | B84-2102  | Bail trip cam screw      |
| 26      | E45-1601  | Bail trip lever          |
| 27      | F18-0002  | Trigger lever            |
| 28      | E36-9901  | Trigger spring           |

| Key No. | Parts No. | Parts Name                 |
|---------|-----------|----------------------------|
| 29      | E37-0002  | Trigger screw              |
| 30      | F12-8901  | Bail spring                |
| 31      | F31-0501  | Bail spring cover          |
| 32      | E24-8101  | Bail spring cover screw    |
| 33      | F31-0601  | Bail trip cover            |
| 34      | E49-2401  | Anti-reverse ratchet       |
| 35      | E38-5501  | Anti-reverse pawl spring A |
| 36      | L03-6601  | Ball bearing               |
| 37      | E51-9801  | Pinion gear                |
| 38      | F32-0202  | Body assembly              |
| 39      | L00-1801  | Anti-reverse pawl screw    |
| 40      | L01-4401  | Anti-reverse pawl          |
| 41      | L01-4302  | Anti-reverse pawl collar   |
| 42      | L00-1501  | Anti-reverse pawl spring B |
| 43      | E03-7801  | Bearing retainer screw     |
| 44      | E32-7801  | Anti-reverse cam spring    |
| 45      | F08-5120  | Anti-reverse lever         |
| 46      | E45-1301  | Oscillating gear           |
| 47      | F17-0001  | Drive gear                 |
| 48      | 373-7802  | Drive gear washer          |
| 49      | F32-0302  | Side cover                 |
| 50      | B83-5002  | Side cover screw           |
| 51      | F31-9902  | Handle assembly            |
| 52      | 501-8501  | Handle collar              |
| 53      | B92-5001  | Handle lock screw          |