

SPINNING REEL

REGAL-S3505T

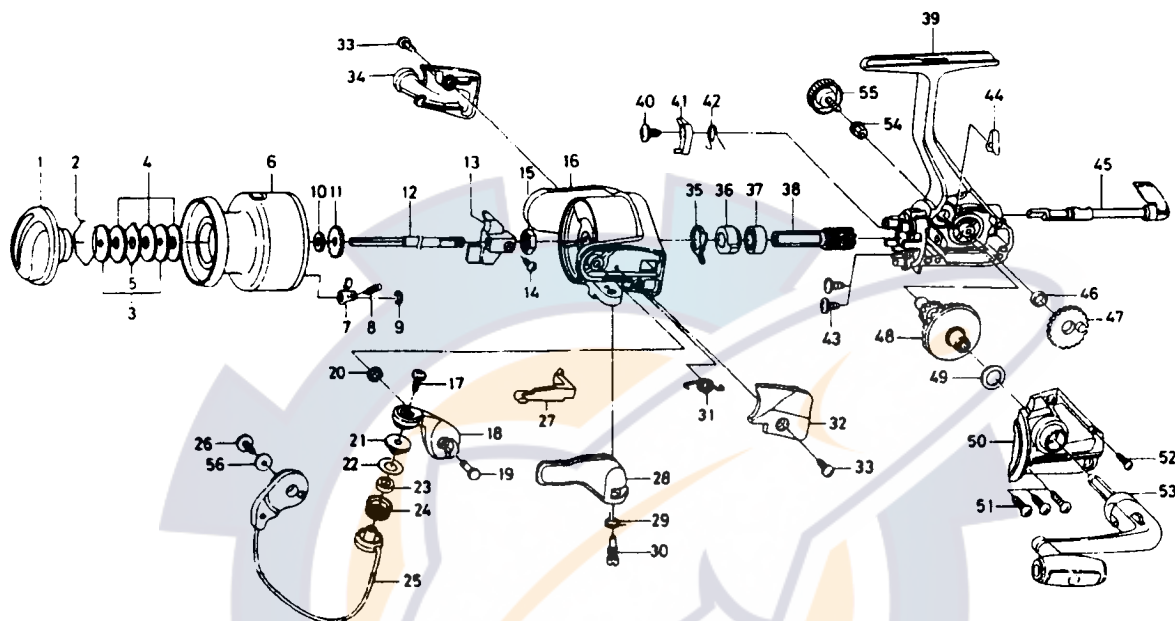

Key No.	Parts No.	Parts Name	Key No.	Parts No.	Parts Name
2-9	F49-8601	Spool assembly	32	F31-4508	Bail spring cover
1	F42-1908	Drag knob	33	E36-4201	Bail spring cover screw
2	F37-3301	Drag washer retainer	34	F31-4608	Bail trip cover
3	F09-4901	Key washer	35	E46-2001	Anti-reverse pawl spring A
4	E13-6001	Drag washer	36	F24-8901	Anti-reverse ratchet
5	373-3603	Eared washer	37	L03-6502	Ball bearing A
6	F49-8701	Spool assembly	38	E52-0101	Pinion gear
7	B07-5304	Click pawl	39	F49-8303	Body assembly
8	E40-3101	Click spring	40	E00-7101	Anti-reverse pawl screw
9	320-5901	Click retainer	41	E46-1302	Anti-reverse pawl
10	F09-4701	Spool washer	42	E46-1201	Anti-reverse pawl spring B
11	E46-2701	Click gear	43	E03-7801	Bearing retainer screw
12	F48-0002	Main shaft	44	E32-7801	Anti-reverse cam spring
13	F09-1301	Oscillating slider	45	F08-5109	Anti-reverse lever
14	352-1502	Oscillating slider screw	46	F13-1601	Oscillating gear collar
15	340-6602	Rotor nut	47	F24-6601	Oscillating gear
16	F42-1808	Rotor	48	E52-0201	Drive gear
17	B67-9309	Line roller screw	49	373-7805	Drive gear washer
18	F45-2703	Bail arm	50	F49-8403	Side cover
19	E49-3501	Bail arm screw	51	B83-5001	Side cover screw A
20	320-5901	Bail arm screw retainer	52	E15-8601	Side cover screw B
21	F44-6302	Line roller collar	53	F51-0601	Handle assembly
22	F44-6201	Line roller washer	54	F43-3501	Handle collar
23	F47-3401	Line roller bushing	55	B92-5009	Handle lock screw
24	F45-4901	Line roller	56	F40-1001	Bail holder washer
25	F50-2501	Bail assembly			
26	B84-2102	Bail trip cam screw			
27	E46-2101	Bail trip lever			
28	F18-0007	Trigger lever			
29	E36-9901	Trigger spring			
30	E41-7801	Trigger screw			
31	E12-8901	Bail spring			