

SPINNING REEL

REGAL-X3505T

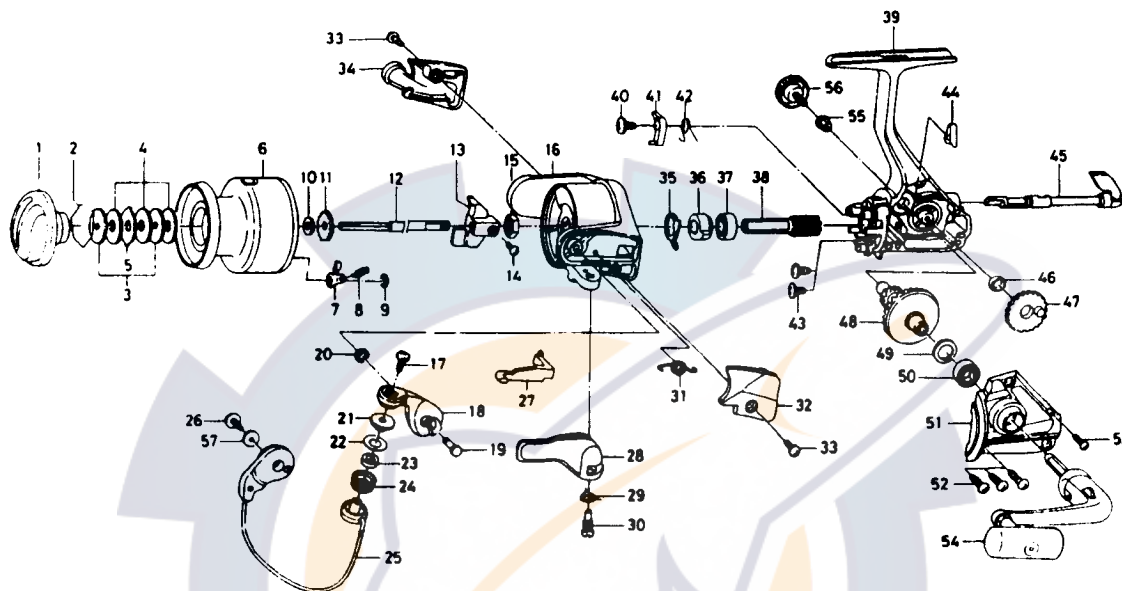

Key No.	Parts No.	Parts Name	Key No.	Parts No.	Parts Name
2-9	F49-3701	Spool assembly	30	E41-7801	Trigger screw
1	F42-1906	Drag knob	31	F12-8901	Bail spring
2	F37-3301	Drag washer retainer	32	F31-4506	Bail spring cover
3	F09-4901	Key washer	33	E24-8101	Bail spring cover screw
4	E13-6001	Drag washer	34	F31-4606	Bail trip cover
5	373-3603	Eared washer	35	E46-2001	Anti-reverse pawl spring A
6	F49-3801	Spool assembly	36	F24-8901	Anti-reverse ratchet
7	b07-5304	Click pawl	37	L03-6502	Ball bearing A
8	E40-3101	Click spring	38	E52-0101	Pinion gear
9	320-5901	Click retainer	39	F49-3502	Body assembly
10	F09-4701	Spool washer	40	E00-7101	Anti-reverse pawl screw
11	E46-2701	Click gear	41	E46-1302	Anti-reverse pawl
12	F48-0002	Main shaft	42	E46-1201	Anti-reverse pawl spring B
13	F09-1301	Oscillating slider	43	E03-7801	Bearing retainer screw
14	352-1502	Oscillating slider screw	44	E32-7801	Anti-reverse cam spring
15	340-6602	Rotor nut	45	F08-5124	Anti-reverse lever
16	F42-1806	Rotor assembly	46	F13-1601	Oscillating gear collar
17	B67-9308	Line roller screw	17	F21-6601	Oscillating gear
18	F45-2702	Bail arm	48	E52-0201	Drive gear
19	E49-3501	Bail arm screw	49	373-7805	Drive gear washer
20	320-5901	Bail arm screw retainer	50	631-6901	Ball bearing B
21	F44-6302	Line roller collar	51	F49-3602	Side cover
22	F44-6201	Line roller washer	52	B83-5002	Side cover screw A
23	F47-3401	Line roller bushing	53	E15-8602	Side cover screw B
24	F45-4902	Line roller	54	F50-4001	Handle assembly
25	F49-4301	Bail assembly	55	F43-3501	Handle collar
26	B84-2102	Bail trip cam screw	56	692-5011	Hand e lock screw
27	E46-2101	Bail trip lever	57	F40-1001	Bail holder washer
28	F18-0006	Trigger lever			
29	E36-9901	Trigger spring			