

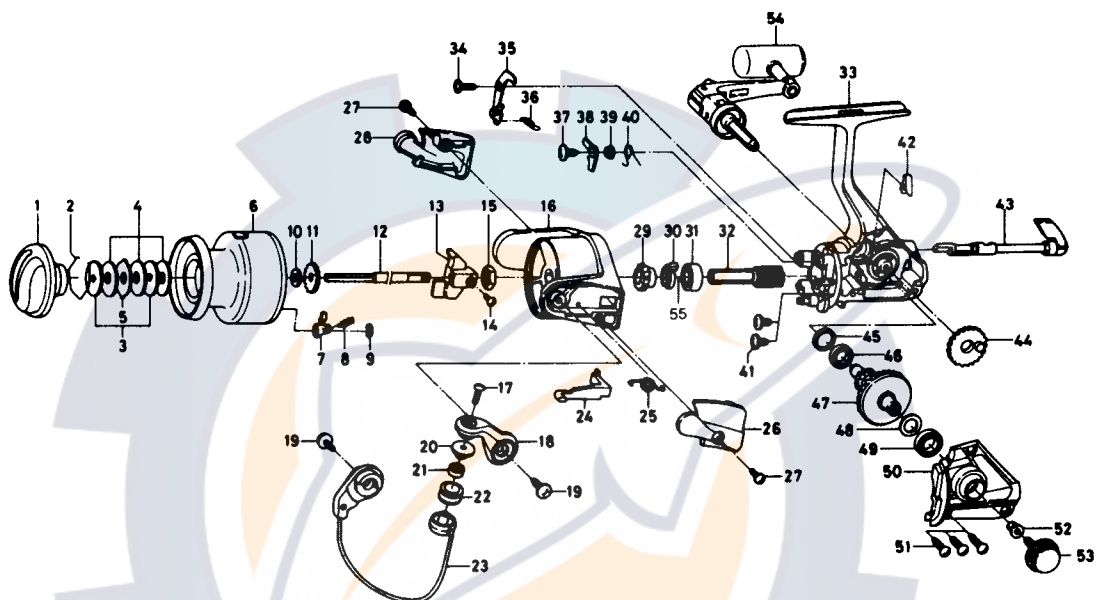

Please order by part number, not key number.

# SPINNING REEL REGAL-Z2500BL



Key NO.	Parts No.	Parts Name	Key NO.	Parts No.	Parts Name
2-9	F32-5503	Spool assembly	27	E24-8101	Bail spring cover screw
1	F28-0904	Drag knob	28	F35-2303	Bail trip cover
2	171-7701	Drag washer retainer	29	F31-1502	Anti-reverse ratchet
3	E46-7201	Key washer	30	E38-5501	Anti-reverse pawl spring A
4	E13-6003	Drag washer	31	L03-6601	Ball bearing B
5	373-3603	Eared washer	32	E51-9801	Pinion gear
6	F32-5603	Spool assembly	33	F37-8802	Body assembly
7	B07-5304	Click pawl	37	L00-1801	Anti-reverse pawl screw
8	E40-3101	Click spring	38	L01-4401	Anti-reverse pawl
9	320-5901	Click retainer	39	L01-4302	Anti-reverse pawl collar
10	E46-7101	Spool washer	40	L00-1501	Anti-reverse pawl spring B
11	270-6501	Click gear	41	E03-7801	Bearing retainer screw
12	E48-4301	Main shaft	42	E32-7801	Anti-reverse cam spring
13	E45-1401	Oscillating slider	43	F08-5121	Anti-reverse lever
14	351-0315	Oscillating slider screw	44	E45-1301	Oscillating gear
15	341-9201	Rotor nut	45	E50-5801	Bearing washer
16	F31-6303	Rotor	46	E30-6801	Ball bearing C
17	B67-9304	Line roller screw	47	F17-0001	Drive gear
18	F31-0203	Bail arm	48	373-7802	Drive gear washer
19	B84-2102	Bail arm screw	49	631-6401	Ball bearing D
20	F06-6301	Line roller collar	50	F37-9201	Side cover
21	F05-5601	Ball bearing A	51	B00-9701	Side cover screw
22	F05-8901	Line roller	52	501-8501	Handle collar
23	F32-6201	Bail assembly	53	F03-5605	Handle lock screw
24	E45-1601	Bail trip lever	54	F32-7001	Handle assembly
25	F12-8901	Bail spring	55	375-8501	Pinion washer
26	F31-0303	Bail spring cover			