

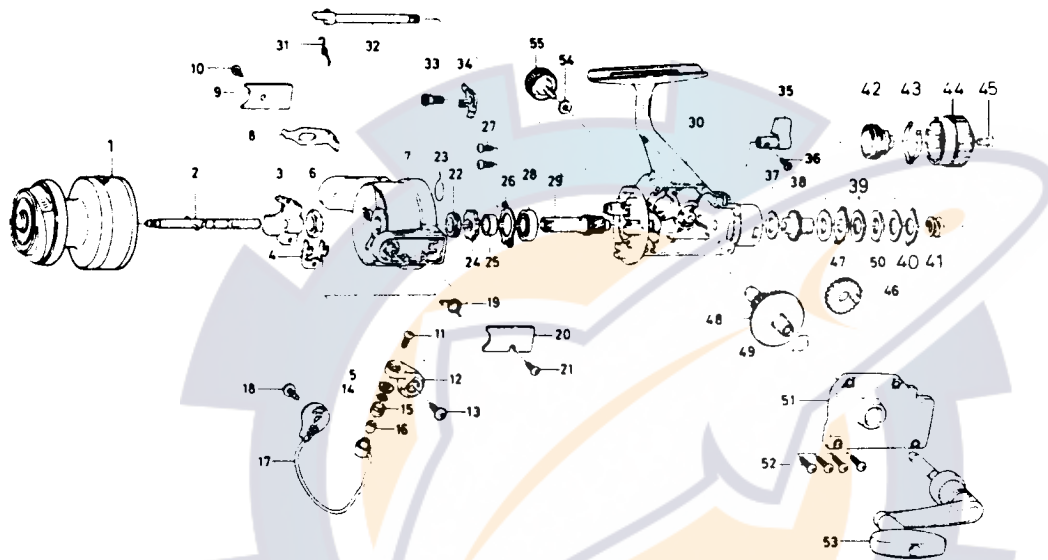

# SPINNING REEL **GS1650T/2050T**



Key No.	Parts No.	Parts Name	Key No.	Parts No.	Parts Name
1	E08-6502	Spool	34	B74-5501	Anti-reverse pawl
2	B83-9801	Main shaft	35	E08-6101	Anti-reverse lever
3	E08-7801	Oscillating slider	36	B12-8201	Anti-reverse lever screw
4	B93-7202	Oscillating slider retainer	37	B46-9505	Drag washer A
5	B97-9801	Line roller washer B	38	B76-9803	Click gear
6	B10-5701	Rotor nut	39	E14-3301	Drag washer B
7	B82-2001	Rotor	40	B83-9501	Eared washer A
8	B83-6701	Bail trip lever	41	K02-6701	Drag coil spring
9	B76-9703	Bail trip cover	42	B77-0004	Drag screw
10	B83-4402	Bail trip cover screw	43	B77-0301	Drag washer spring
11	B67-9302	Line roller screw	44	K05-1701	Drag knob
12	B68-1102	Bail arm	45	352-1107	Drag knob spring screw
13	B84-2102	Bail arm screw	46	B74-3701	Oscillating gear
14	B55-4301	Line roller washer A	47	K05-0301	Eared washer B
15	250-3921	Line roller	48	B83-6801	Drive gear
16	B45-1501	Line roller bushing	49	373-7800	Drive gear washer
17	K02-2202	Bail	50	E02-4401	key washer
18	B84-2102	Bail trip cam screw	51	K05-2402	Side cover
19	K04-9801	Bail spring	52	B83-5002	Side cover screw
20	B77-2202	Bail spring cover	53	E00-2502	Handle
21	B83-4402	Bail spring cover screw	54	B92-4902	Handle lock washer
22	501-9901	Spring holder	55	B92-5003	Handle lock screw
23	145-0901	Anti-reverse pawl spring			
24	280-9001	Anti-reverse ratchet			
25	K03-1701	Spacing sleeve			
26	B35-6301	Bearing retainer			
27	B83-4402	Bearing retainer screw			
28	B54-60C1	Ball bearing			
29	B83-6101	Pinion gear			
30	K05-2001	Body			
31	144-0321	Anti-reverse cam spring			
32	B83-6001	Anti-reverse cam			
33	B83-6301	Anti-reverse pawl screw			

GS2050T Special Parts		
1	K05-4701	Spool
7	B82-2201	Rotor
8	B83-7301	Bail trip lever
17	K02-2402	Bail
30	K05-2002	Body
51	K05-2404	Side cover
53	E00-2802	Handle