

TEAM DAIWA-S103HVLA

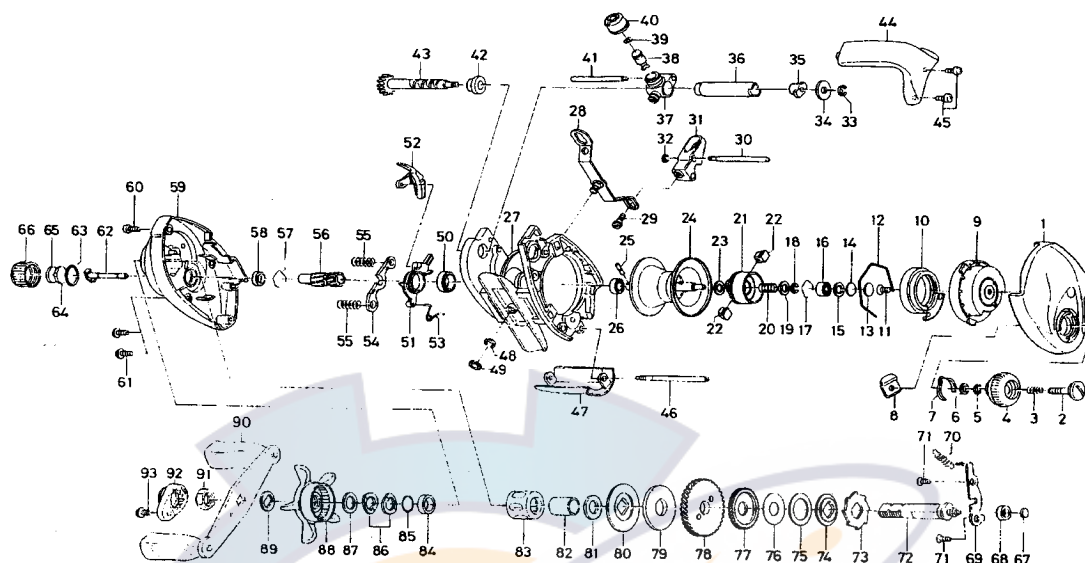

| Key No. | Parts No. | Parts Name | Key No. | Parts No. | Parts Name |
|---------|-----------|------------------------|---------|-----------|------------------------|
| 1 | F74-6701 | R/S PLT | 52 | F61-7902 | CLUTCH LEVER |
| 2 | F63-1301 | SET PLT SCREW | 53 | F68-3001 | CLUTCH CAM SPRING |
| 3 | E16-7101 | SET PLT SPRING | 54 | F59-9801 | YOKE |
| 4 | F61-3301 | BRAKE ADJ KNOB | 55 | E23-6401 | YOKE SPRING |
| 5 | B33-9801 | BRAKE DIAL RET A | 56 | F59-9901 | PINION GEAR |
| 6 | F63-7701 | BRAKE DIAL WASHER | 57 | E21-9701 | BEARING RET B |
| 7 | F05-1701 | BRAKE CLICK SPRING | 58 | F05-5601 | BALL BEARING C |
| 8 | F61-3401 | BRAKE DIAL RET B | 59 | F74-6601 | L/S PLT |
| 9 | F71-7802 | RIGHT SET PLT | 60 | 351-7801 | L/S PLT SCREW A |
| 10 | F71-7702 | MAGNET HOLDER | 61 | 351-1804 | L/S PLT SCREW B |
| 11 | B30-4001 | RIGHT SET PLT SCREW | 62 | F74-4101 | PINION SHAFT |
| 12 | B54-3201 | MAGNET HOLDER RET RING | 63 | 171-5201 | O RING |
| 13 | F57-4303 | SPACER A | 64 | B17-5401 | SPOOL ADJ CAP METAL |
| 14 | 375-7411 | SPACER B | 65 | B17-5503 | SPACER D |
| 15 | 375-7404 | SPACER C | 66 | F74-6401 | CAST CONTROL CAP |
| 16 | F57-7701 | BALL BEARING A | 67 | F57-5601 | DRIVE SHAFT WASHER A |
| 17 | E21-9701 | BEARING RET A | 68 | F64-8301 | BUSHING |
| 18-26 | Z01-1089 | SPOOL | 69 | F63-3001 | DRIVE SHAFT RET |
| 27 | F74-4303 | FRAME | 70 | F68-9501 | CLUTCH TRIP PLT SPRING |
| 28 | F75-0501 | LEVEL WIND PLT | 71 | F21-1102 | DRIVE SHAFT RET SCREW |
| 29 | F59-8701 | LINE GUIDE SCREW | 72 | F74-5401 | DRIVE SHAFT |
| 30 | F60-0501 | STABILIZER BAR A | 73 | F76-1701 | A/R RATCHET |
| 31 | F74-5601 | LINE GUIDE | 74 | E30-4701 | DRIVE SHAFT WASHER B |
| 32 | B86-4101 | STABILIZER BAR RET | 75 | E30-6101 | DRIVE SHAFT WASHER C |
| 33 | 320-5901 | WORM SHAFT RET | 76 | B96-7401 | DRIVE SHAFT WASHER D |
| 34 | 376-1801 | WORM SHAFT WASHER | 77 | E30-4801 | WORM DRIVE GEAR |
| 35 | B71-5601 | WORM SHAFT HOLDER A | 78 | F60-1301 | DRIVE GEAR |
| 36 | F60-0202 | LEVEL WIND GUARD | 79 | F02-7801 | DRAG WASHER |
| 37 | F60-0601 | LINE GUIDE PAWL HOLDER | 80 | F06-2501 | KEY WASHER |
| 38 | 121-4212 | LINE GUIDE PAWL | 81 | E42-5401 | DRAG WASHER B |
| 39 | 375-4101 | LINE GUIDE WASHER | 82 | F60-2901 | GEAR SHAFT COLLAR |
| 40 | F68-2801 | PAWL CAP | 83 | F57-3901 | ROLLER CLUTCH |
| 41 | F60-2101 | STABILIZER BAR B | 84 | F58-2501 | BALL BEARING D |
| 42 | E19-9501 | WORM SHAFT HOLDER B | 85 | B55-3801 | SPACING SLEEVE |
| 43 | F74-4201 | WORM SHAFT | 86 | 150-8901 | DRAG SPRING WASHER |
| 44 | F60-1705 | REAR COVER | 87 | E37-4801 | SPACING SLEEVE |
| 45 | 351-1001 | REAR COVER SCREW | 88 | F77-0302 | STAR DRAG |
| 46 | F60-2301 | STABILIZER BAR C | 89 | 150-9001 | FRICITION WASHER |
| 47 | F60-2202 | FRONT PLT | 90 | F74-6101 | HANDLE |
| 48 | 320-1402 | LEVEL WIND PLT RET | 91 | B43-3602 | HANDLE NUT |
| 49 | F75-0601 | LEVEL WIND PLT COLLAR | 92 | F05-4402 | HANDLE NUT RET |
| 50 | B86-1701 | BALL BEARING B | 93 | 351-1803 | HANDLE NUT PLT SCREW |
| 51 | F59-9301 | CLUTCH CAM | | | |