

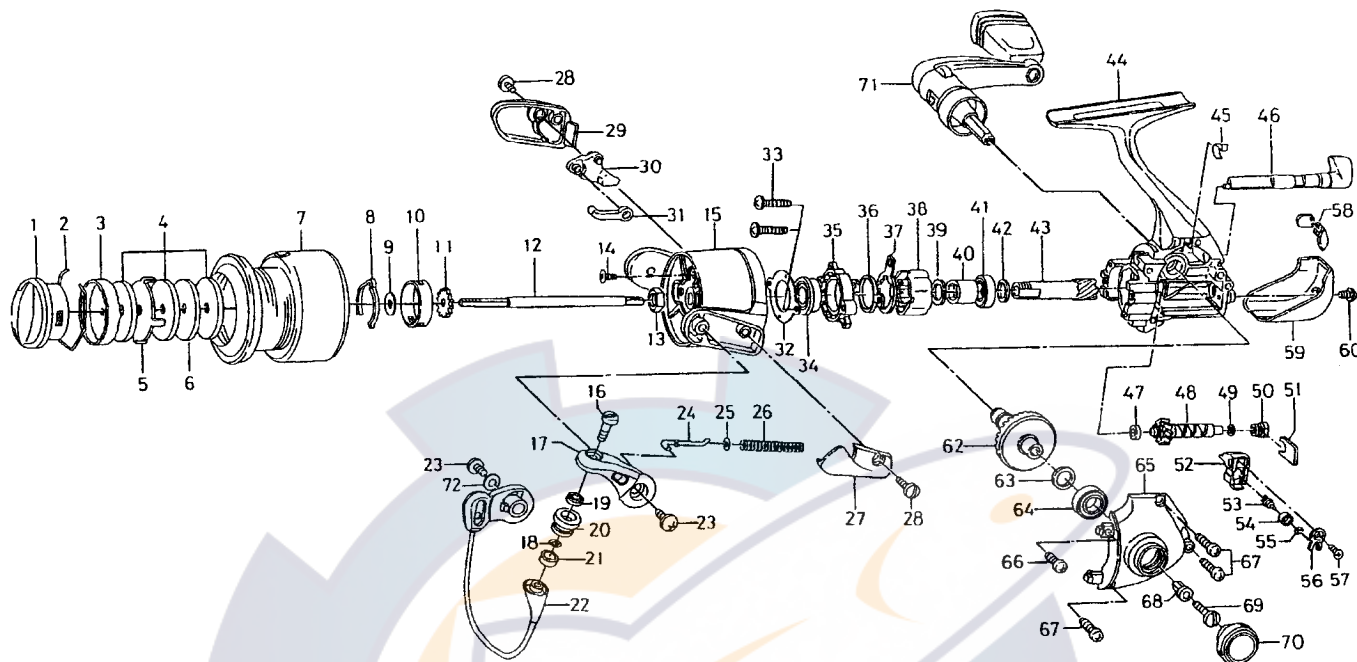

SPINNING REEL

TEAM DAIWA-S1500CU / 2000CU



| Key No. | Parts No. | Parts Name |
|---------|-----------|--------------------------|
| 2-7 | G11-7001 | SPOOL |
| 1 | F63-6902 | DRAG KNOB |
| 2 | F74-2501 | DRAG WASHER RET |
| 3 | F69-0201 | DRAG KNOB CLICK PLT |
| 4 | F69-2301 | DRAG WASHER |
| 5 | F69-0101 | EARED WASHER |
| 6 | F69-0001 | KEY WASHER |
| 8 | F70-4901 | SPOOL CLICK LEAF SPRING |
| 9 | E39-4001 | SPOOL WASHER |
| 10 | E12-2303 | CLICK LEAF SPRING HOLDER |
| 11 | E36-5301 | CLICK GEAR |
| 12 | F65-2701 | MAIN SHAFT |
| 13 | 341-9203 | ROTOR NUT |
| 14 | B55-7601 | ROTOR NUT LOCK SCREW |
| 15 | F94-5102 | ROTOR |
| 16 | F92-1701 | LINE ROLLER SCREW |
| 17 | F89-2208 | BAIL ARM |
| 18 | F89-7101 | LINE ROLLER WASHER |
| 19 | G02-0801 | BALL BEARING A |
| 20 | F92-1601 | LINE ROLLER |
| 21 | G04-7601 | LINE ROLLER COLLAR |
| 22 | F96-4003 | BAIL |
| 23 | 351-7701 | BAIL HOLDER SCREW |
| 24 | F89-2301 | BAIL SPRING SHAFT |
| 25 | E31-3901 | BAIL SPRING WASHER |
| 26 | F89-2401 | BAIL SPRING |
| 27 | F89-2603 | BAIL SPRING COVER |
| 28 | 351-1801 | BAIL HOLDER COVER SCREW |
| 29 | F90-8103 | BAIL TRIP COVER |
| 30 | F72-7201 | BAIL TRIP LEVER |
| 31 | F62-4601 | BAIL TRIP PLT |
| 32 | F92-5801 | BEARING RET A |
| 33 | E24-7402 | BEARING RET SCREW |
| 34 | F22-6701 | BALL BEARING B |
| 35 | F92-4801 | BEARING RET B |
| 36 | F67-5401 | BEARING RET C |
| 37 | F62-2201 | ROLLER CLUTCH RET |
| 38 | F62-2001 | ROLLER CLUTCH |

| Key No. | Parts No. | Parts Name |
|---------|-----------|------------------------|
| 39 | 375-8509 | ROLLER CLUTCH WASHER |
| 40 | F73-2501 | SPACING SLEEVE |
| 41 | 637-5702 | BALL BEARING C |
| 42 | F78-1002 | PINION COLLAR |
| 43 | F93-5501 | PINION GEAR |
| 44 | F98-4902 | BODY |
| 45 | F65-1901 | A/R LEVER SPRING |
| 46 | F65-1801 | A/R LEVER |
| 47 | F65-2201 | WORM SHAFT BUSH |
| 48 | F98-5001 | WORM SHAFT |
| 49 | 375-4101 | WORM SHAFT WASHER |
| 50 | F65-2301 | WORM SHAFT COLLAR |
| 51 | F65-2401 | WORM SHAFT RET |
| 52 | F65-2601 | OSC SLIDER |
| 53 | F89-1701 | OSC PAWL |
| 54 | F91-3001 | OSC PAWL BUSH |
| 55 | 375-0801 | OSC PAWL WASHER |
| 56 | F62-2901 | OSC SLIDER COVER |
| 57 | E15-0205 | OSC SLIDER COVER SCREW |
| 58 | F65-2902 | SHIELD PLT |
| 59 | F65-3102 | REAR COVER |
| 60 | E24-8101 | REAR COVER SCREW |
| 62 | F65-2801 | DRIVE GEAR |
| 63 | 375-8500 | DRIVE GEAR WASHER |
| 64 | 637-5702 | BALL BEARING D |
| 65 | F65-3007 | SIDE COVER |
| 66 | E15-7502 | SIDE COVER SCREW A |
| 67 | E13-0501 | SIDE COVER SCREW B |
| 68 | F40-4801 | HANDLE COLLAR |
| 69 | 363-8511 | HANDLE SCREW |
| 70 | F65-3503 | HANDLE SCREW CAP |
| 71 | G12-1501 | HANDLE |
| 72 | G04-7901 | BAIL HOLDER WASHER |

S2000CU Special Parts

| Key No. | Parts No. | Parts Name |
|---------|-----------|------------|
| 2-7 | G11-7201 | SPOOL |