

Please order by parts number, not key number
 Veuillez indiquer le numéro de la pièce.

Daiwa
 COMMITTED TO TOTAL QUALITY
 BAITCASTING REEL

TDPLUTON 200H

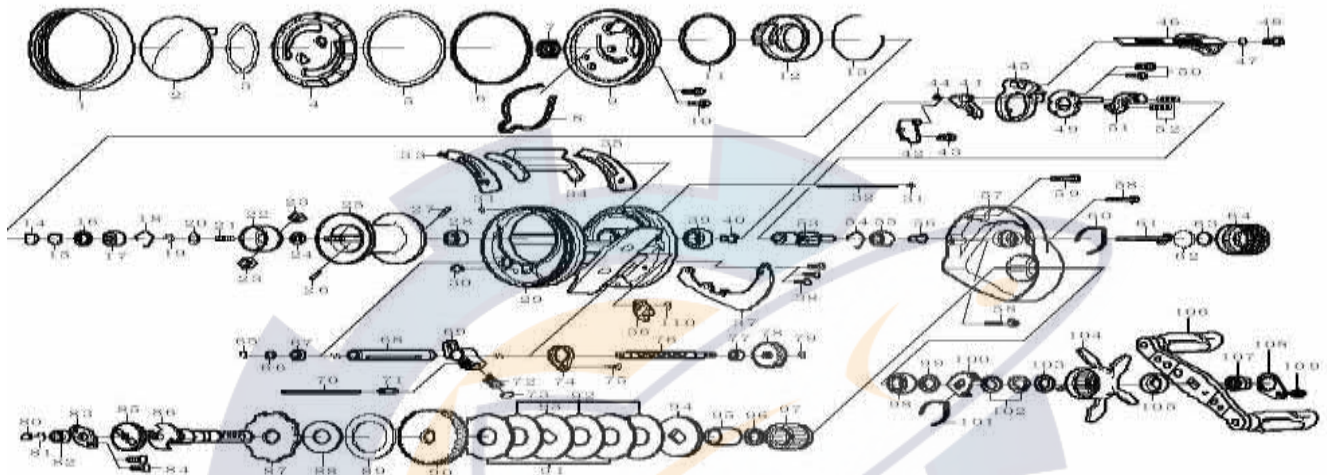

Key No.	Parts No.	Parts Name	Key No.	Parts No.	Parts Name
1	H17-5703	Left side cover	60	H16-0901	Click leaf spring (B)
2	H17-6405	Cover	61	H15-9601	Pinion shaft
3	H25-6901	Washer (A)	62	H16-1001	Spacer (F)
4	H17-6002	Dial	63	B17-5503	Spacer (G)
5	H17-5901	Washer (B)	64	H16-5702	Cast control cap
6	H17-5801	Retainer (A)	65	320-5901	Worm shaft retainer (A)
7	H17-6201	Gear (A)	66	B41-1706	Worm shaft washer
8	H17-6101	Click leaf spring (A)	67	G46-9001	Ball bearing (D)
9	H17-5502	Left set plate	68	H15-9001	Level wind guard
10	G55-7101	Screw (A)	69	H16-6501	Line guide
11	H17-6501	"O" ring (A)	70	H16-8802	Stabilizer bar (B)
12	H17-6601	Magnet holder	71	H16-8701	Line guide collar
13	H17-7101	Magnet holder retainer	72	H16-8601	Line guide pawl
14	375-7404	Spacer (A)	73	G09-9800	Line guide washer
15	375-7411	Spacer (B)	74	H15-8101	Plate (B)
16	G18-5101	Spacer (C)	75	G15-9902	Screw (H)
17	G51-1506	Ball bearing (A)	76	H15-8301	Worm shaft
18	F03-2201	Bearing retainer (A)	77	G46-9001	Ball bearing (E)
19-28	Z01-9109	Spool assembly	78	H26-9101	Worm gear
29	H27-7201	Frame assembly	79	B33-9801	Worm shaft retainer (B)
30	H29-4101	Screw (B)	80	G09-9800	Washer (D)
31	B86-4101	Retainer (B)	81	320-8002	Retainer (C)
32	H16-5501	Stabilizer bar (A)	82	G53-8003	Ball bearing (F)
33	H16-1201	Spacer (D)	83	H15-6501	Plate (C)
34	H16-5602	Clutch lever	84	E13-4501	Screw (I)
35	H16-1101	Spacer (E)	85	H26-9201	Gear (B)
36	H27-0401	Stopper	86	H23-7501	Drive shaft
37	H27-0003	Plate (A)	87	H31-2501	Clutch wheel
38	G15-9902	Screw (C)	88	H26-5101	Drive shaft washer (A)
39	G52-3403	Ball bearing (B)	89	H15-6801	Drive shaft washer (B)
40	H26-6601	Collar (A)	90	H23-7701	Drive gear
41	H16-1301	Clutch trip lever	91	H22-7301	Eared washer
42	H16-6401	Clutch plate	92	H22-7101	Drag washer
43	H29-4101	Screw (D)	93	H22-7201	Key washer (A)
44	H15-9101	Clutch cam spring	94	H23-7801	Key washer (B)
45	H15-9901	Clutch cam	95	H15-7201	Gear shaft collar
46	H15-9801	Clutch cam plate (A)	96	373-7810	Bearing washer (A)
47	H15-9201	Washer (C)	97	F55-2703	Roller clutch
48	H15-9301	Screw (E)	98	G52-3403	Ball bearing (G)
49	H26-6701	Clutch cam plate (B)	99	373-7810	Bearing washer (B)
50	B03-2904	Screw (F)	100	H15-8801	Click leaf spring holder
51	H15-9701	Yoke	101	H15-8701	Click leaf spring (C)
52	H16-0401	Yoke spring	102	150-8901	Drag spring washer
53	H23-7601	Pinion gear	103	G69-4201	Washer (E)
54	H16-0801	Bearing retainer (B)	104	H23-8603	Star drag
55	F81-1804	Ball bearing (C)	105	F85-0403	Handle collar
56	H15-9501	Collar (B)	106	H23-8001	Handle assembly
57	H26-6905	Right side plate	107	G79-3301	Handle nut
58	G04-0817	Screw (F)	108	040-3201	Handle nut plate
59	G04-0802	Screw (G)	109	353-8301	Handle nut plate screw
			110	B33-9801	Retainer (D)