

Removal of Reel Handle

Remove the reel handle by tightening the star drag as much as possible. With you left hand, pull the star drag in towards the reel body. While holding the star drag in, turn the reel handle backwards until it comes off.

To put the handle back on, hold the star drag in as before while screwing the handle on. Release the star drag. With the drag still tightened, put you thumb on the spool and check to see if the handle is firmly seated. If not, pull the star drag in again and turn the handle firmly forward. Release the star drag and check again. You should feel the handle lock into place.

Care and Lubrication

Your new Johnny Morris Signature Series reel is designed to provide years of dependable service. But like any other precision machine, periodic cleaning and maintenance is required for continued peak performance.

Reels made today require both a lightweight oil and grease to be used. Oil and grease should be used sparingly, too much can have a negative impact on reel performance. There are lightweight oils and greases made specifically for fishing reels.

Oil should be applied to all bearings, the worm gear, and the crank shaft. Grease should be applied to the drive gears, crank gears, the pinion gear, and all bushings.

We do not recommend using any multipurpose oil. Many of these oils have properties that will attract dirt and dust to the internal parts. This may cause excessive wear and reduce the life of the reel.

After each trip the reel should be checked for dirt or sand. If it has been exposed to saltwater, the spool should be removed and the entire reel rinsed with water. Dry with a soft cloth and lubricate the reel as described above.

For professional cleaning and maintenance send your reels postage prepaid to:

Outdoor World Rod & Reel Repair
2300 E. Turner, Suite M
Springfield, MO 65803
Phone (417) 873-5274 Fax (417) 973-5280

JMX 1000H(S)

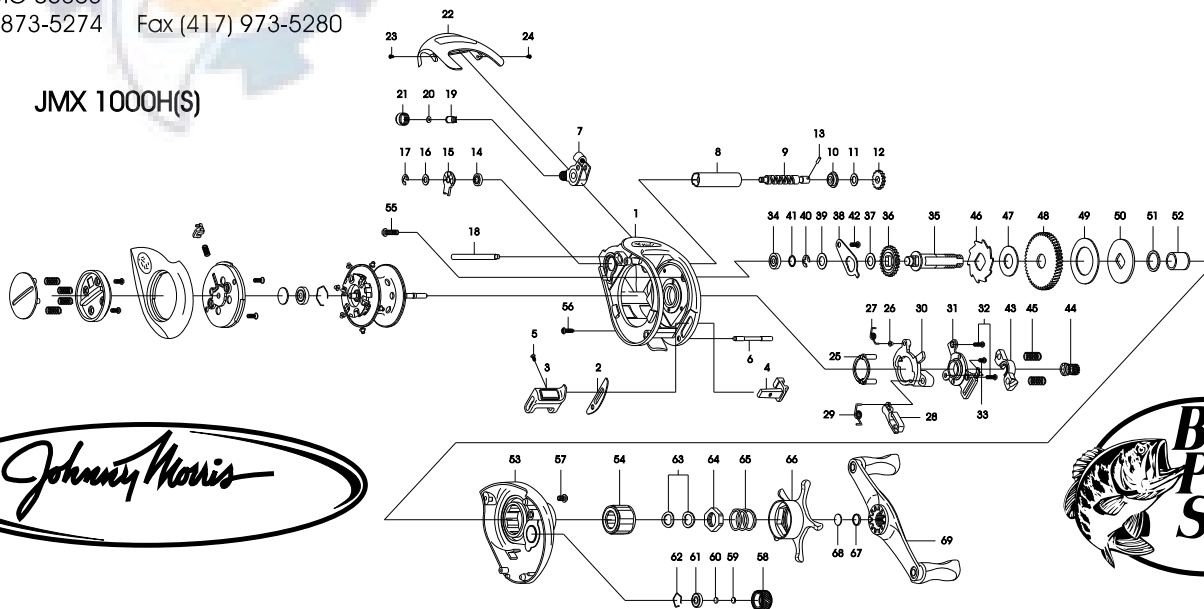

NO	PART NAME	NO	PART NAME	NO	PART NAME	NO	PART NAME	NO	PART NAME	NO	PART NAME
1	FRAME ASSEMBLY(INCL. PLATE)	16	WORM SHAFT WASHER(OPTIONAL)	31	CAM PLATE	46	RATCHET	61	BALL BEARING	76	LEFT SIDE COVER ASSEMBLY
2	CLUTCH BAR PLATE	17	E-RING	32	CAM PLATE SCREW (A)*2	47	RATCHET WASHER	62	BEARING RETAINER	77	LOCK PIN
3	CLUTCH BAR ASSEMBLY	18	PILLAR	33	CAM PLATE SCREW (B)	48	DRIVE GEAR	63	DRAG SPRING WASHER(*2)	78	LOCK PIN SPRING
4	CLUTCH LINK	19	LINE GUIDE PAWL	34	BALL BEARING	49	DRAG WASHER (B)	64	DRAG NUT	79	SPOOL COVER
5	CLUTCH BAR SCREW	20	SPACER(OPTIONAL)	35	CRANK SHAFT	50	DRAG WASHER (D)	65	STAR DRAG SPRING	80	SPOOL COVER SCREW(*2)
6	CLUTCH BAR SUPPORT	21	PAWL CAP	36	IDLER(I)	51	SLEEVE WASHER(OPTIONAL)	66	STAR DRAG ASSEMBLY	81	SPOOL SPACER(A)
7	LINE GUIDE ASSEMBLY	22	HOOD	37	IDLER(I) WASHER (A)	52	SLEEVE	67		82	
8	LINE GUIDE PIPE	23	HOOD SCREWS	38	BEARING PLATE	53	RIGHT SIDE COVER ASSEMBLY	68		83	
9	WORM SHAFT	24	HOOD SCREWS B	39	IDLER(I) WASHER (B)	54	ONE WAY CLUTCH	69	HANDLE ASSEMBLY(INCL. 48B)		
10	WORM SHAFT BUSHING (A)	25	YOKE HOLDER	40	E-RING	55	RIGHT SIDE COVER SCREW (A)	70	SPOOL ASSEMBLY(INCL. 18B)		
11	IDLER(S) WASHER(OPTIONAL)	26	CLUTCH SPRING BUSHING	41	CRANK SHAFT SPACER(OPTIONAL)	56	RIGHT SIDE COVER SCREW (B)	71	BRAKE COLLAR(WHITE)*4		
12	IDLER(S)	27	CLUTCH SPRING	42	BEARING PLATE SCREW	57	RIGHT SIDE COVER SCREW (C)	72	LEVER PLATE		
13	WORM SHAFT PIN	28	RETURN PAWL	43	PINION YOKE	58	CAST CONTROL CAP ASSEMBLY	73	LEVER PLATE SPRING(*4)		
14	BALL BEARING	29	RETURN PAWL SPRING	44	PINION GEAR	59	TENSION WASHER	74	LOCK LEVER		
15	WORM SHAFT BUSHING (B)	30	CLUTCH CAM	45	PINION YOKE SPRING(*2)	60	SPOOL SPACER (B)	75	LOCK LEVER SCREW(*2)		

One-Year Limited Warranty

Bass Pro Shops will repair or replace (at our discretion) any Johnny Morris Signature Series baitcast reel which proves to be defective in workmanship or materials within one year from the date of the original date of purchase. You must save your dated sales receipt for warranty validation. This warranty gives you specific legal rights, and you may have other rights which vary from state-to-state.

For reels purchased through our catalogs or Bass Pro Shops online:

For reel replacement only: Return your reel **postage prepaid** to the Return Center address listed on your receipt along with your dated sales receipt.

For reel repair only: Return your reel **postage prepaid with a copy of your dated sales receipt as proof of purchase and warranty validation to the Outdoor World Rod & Reel address listed above.**

For reels purchased through Outdoor World/Sportsman's Warehouse retail locations:

For reel replacement only: Return your reel (**postage prepaid if sending by mail**) to the store from which it was purchased along with your dated sales receipt.

For reel repairs only: Return your reel **postage prepaid with a copy of your dated sales receipt as proof of purchase and warranty validation to the Outdoor World Rod & Reel address listed above.**

This warranty does not cover lost parts, malfunctions or damage due to abuse, accidents, normal wear, or cleaning and re-lubrication required due to the owners' failure to provide reasonable and necessary maintenance.

Repairs needed to your reel due to abnormal use, modification, or reels past the one-year warranty period are available for a reasonable charge, providing the reel is returned **postage prepaid**, from Outdoor World Rod & Reel repair.