

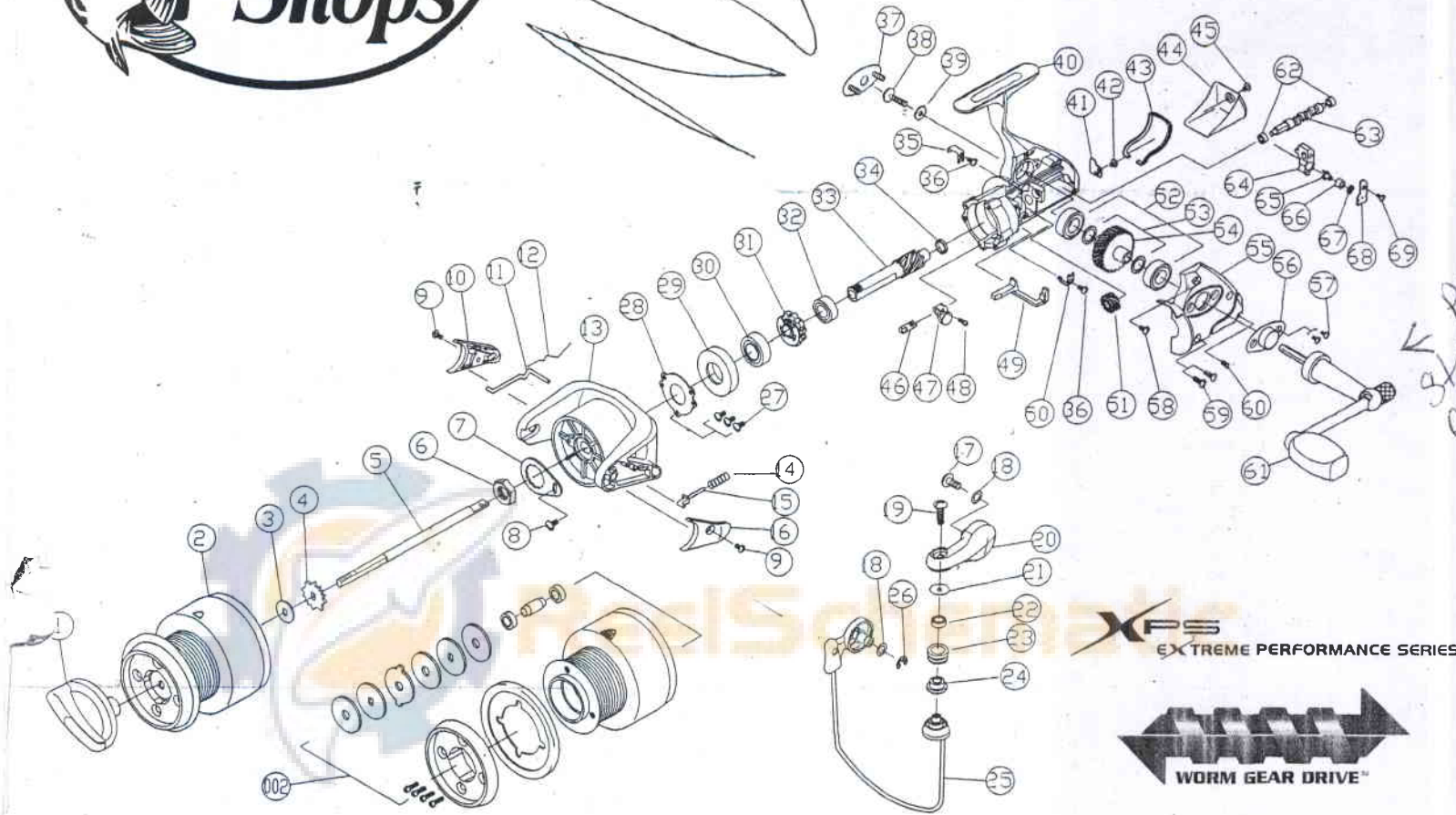

Johnny Morris
SIGNATURE SERIES

on handles & worm gear



No.	NAME	No.	NAME	No.	NAME
1	Drag Knob Assembly	28	B/B Cover Plate	55	Body Cover
2	Spool Assembly (incl. 2 Ball Bearings)	29	B/B Holder	56	Handle Dust Cover
3	Spool Adj. Washer	30	Pinion Gear Ball Bearing	57	Handle Dust Cover Screw
4	Click Gear	31	One-Way Bearing Assembly	58	Body Cover Screw (A)
5	Main Shaft	32	Pinion Gear Ball Bearing	59	Body Cover Screw (B)
6	Rotor Nut	33	Pinion Gear	60	Body Cover Screw (C)
7	Rotor Nut Lock Plate	34	Pinion Gear Bushing	61	Handle Assembly
8	Rotor Nut Lock Plate Screw	35	Stopper Spring	62	Worm Shaft Ball Bearings (2)
9	Rotor Cover Screw	36	Stopper Lever Spring Screw	63	Worm Shaft
10	Kick Lever Cover	37	Dust Cover	64	O/S Slider
11	Kick Lever	38	Handle Screw	65	Pawl
12	Kick Lever Spring	39	Handle Screw Washer	66	Pawl Bushing
13	Rotor	40	Body	67	Pawl Washer
14	Bail Spring	41	Worm Shaft Cover	68	O/S Slider Cover
15	Bail Spring Shaft	42	Worm Shaft Cover Screw	69	O/S Slider Cover Screw
16	Bail Spring Cover	43	Body Packing		
17	Bail Arm Screw	44	Body Cap		
18	Arm Lever Washer	45	Body Cap Screw		
19	Line Slider Screw	46	Stopper Cam		
20	Bail Arm	47	Stopper Lever		
21	Bail Washer	48	Stopper Lever Screw		
22	Line Roller Ball Bearing	49	Stopper		
23	Line Roller	50	Stopper Lever Spring		
24	Line Slider Bushing	51	Worm Gear		
25	Bail Assembly	52	Drive Gear Ball Bearings (2)		
26	Bail Holder E-Clip	53	Drive Gear Adj. Washer		
27	B/B Cover Plate Screws (3)	54	Drive Gear		

OWNER'S MANUAL

Johnny Morris
SIGNATURE SERIES

JMX10FA / JMX20FA / JMX30FA / JMX40FA
SPINNING REEL

XPS
EXTREME PERFORMANCE SERIES



Thank you for selecting the Johnny Morris Signature Series spinning reel. We believe we have developed one of the best spinning reels on the market at an affordable price, and the only spinning reel worthy of the Johnny Morris name.

This reel boasts some exciting features, such as our Worm Gear Drive™ oscillation system. This new oscillation system is powered by strong, lightweight Duraluminum drive gears to provide smooth-as-silk gear feel. Our new Worm Gear Drive is housed in a strong, durable die-cast metal body. 9 stainless steel ball bearings further add to the reel's smoothness, while our PowerLock™ instant anti-reverse system virtually eliminates any backward movement of the reel handle- allowing for rock-solid hooksets. The forged aluminum spool with Titanium-coated spool lip is supported on the spool shaft by two stainless steel ball bearings to further enhance the six-disk drag performance. A balanced rotor rounds out our slim profile spinning reel finished off in a great-looking smoke chrome exterior.

REEL SPECIFICATIONS

Model	Weight (oz.)	Gear Ratio	Line Capacity Lb. Test.Yds.	Line Recovery (Inches per turn)
JMX10FA	10.7	5.2:1	4/170, 6/125, 8/110	23.7
JMX20FA	11.0	5.2:1	6/195, 8/150, 10/130	26.1
JMX30FA	13.3	5.0:1	8/170, 10/140, 12/110	26.4
JMX40FA	14.2	5.0:1	8/220, 10/200, 15/110	28.9

Performance Features & Operational Instructions

Worm Gear Drive™ Oscillation System

The powerful spool oscillation of this reel is controlled by an extra-wide, lightweight Duraluminum main gear driving the sturdy brass pinion gear. This pinion gear in turn drives the worm gear, controlling the spool oscillation. The extra-wide main gear ensures proper gear alignment is maintained.

Titanium-Coated Ball Bearing Line Roller

The oversized line roller is designed to spin as the line is reeled in. The line roller has a special groove in it to reduce line twist. We've added a stainless steel ball bearing inside the line roller to reduce rotational friction and heat build-up in the line.

PowerLock™ Instant Anti-Reverse System

The PowerLock Instant Anti-Reverse system is a one-way clutch bearing that keeps the reel from having any backward handle movement. This gives you better lure presentation control, more precise control when fighting fish, and a smoother feel.

One-Piece Die-Cast Metal Frame and Side Cover

The frame and side cover of the Johnny Morris Signature Series spinning reel are made of super-strong die-cast metal. This ensures proper alignment of the gears and spool shaft, even under the load of fighting a fish.

Forged Aluminum Spool w/ Dual Ball Bearing Support

The spool is forged from lightweight aluminum and fitted with a friction reducing Titanium-coated spool lip for increased casting distance.

The spool is designed with a dual, stainless steel ball bearing support system. These two ball bearings provide optimum support for the spool on the spool shaft. This keeps the spool in perfect alignment with the spool shaft and enhances the performance of the smooth, six-disk drag system.

You will find it easier to spool your reel with it mounted on a rod. First, open the bail, run the end of the line through the rod guides then tie it to the spool. Turn the handle to close the bail. While filling the spool, remember to keep some finger tension on the line as it is spooled on evenly. **Important-** The line must come off the filler spool the same way the bail is turning to avoid line twist. Fill the spool to within about 1/8" of the outer edge of the spool lip. **Do not overfill-** this will cause the line to coil off the spool lip and tan.

Balanced Rotor

The spool rotor has a counter-balance weight built into it for wobble-free performance. This helps increase the sensitivity of the reel.

Care & Lubrication

Your new Johnny Morris Signature Series spinning reel has been designed to provide of dependable service. But like any other precision machine, periodic cleaning and maintenance are required for continued dependability. Reels manufactured today require the use of both a lightweight oil and a grease to maintain maximum performance.

There are lightweight oils and greases specifically designed for use with fishing reels on the market. The oil should be applied to all ball bearings and the spool shaft. The grease should be applied to all gears and/or bushings.

We do not recommend using a general multipurpose oil since many of these oils actually attract dirt and dust to the internal parts. This may cause excessive wear, reducing the life of the reel.

After each trip your reel should be checked for dirt or sand. If it has been exposed to saltwater use, the spool should be removed and the reel rinsed with fresh water. Dry with a soft cloth and lubricate the reel as described above.

For professional cleaning and maintenance send your reels postage prepaid to:

Outdoor World Rod & Reel Repair
2300 E. Turner, Suite M
Springfield, MO 65803
Phone (417) 873-5274 Fax (417) 973-5280

One-Year Limited Warranty

Bass Pro Shops will repair or replace (at our discretion) any Johnny Morris Signature Series spinning reel which proves to be defective in workmanship or materials within one year from the date of the original date of purchase. **You must save your dated sales receipt for warranty validation.** This warranty gives you specific legal rights, and you may have other rights which vary from state-to-state.

For reels purchased through our catalogs or Bass Pro Shops online:

For reel replacement only: Return your reel **postage prepaid** to the Return Center address listed on your receipt along with your dated sales receipt.

For reel repair only: Return your reel **postage prepaid** with a copy of your dated sales receipt as proof of purchase and warranty validation to the Outdoor World Rod & Reel address listed above.

For reels purchased through Outdoor World/Sportsman's Warehouse retail locations:

For reel replacement only: Return your reel (**postage prepaid if sending by mail**) to the store from which it was purchased along with your dated sales receipt.

For reel repairs only: Return your reel **postage prepaid** with a copy of your dated sales receipt as proof of purchase and warranty validation to the Outdoor World Rod & Reel address listed above.

This warranty does not cover lost parts, malfunctions or damage due to abuse, accidents, normal wear, or cleaning and re-lubrication required due to the owner's failure to perform reasonable and necessary maintenance.

Repairs needed to your reel due to abnormal use, modification, or reels past the one-year warranty period are not covered.