

Trim Tab Schematic
3-year warranty

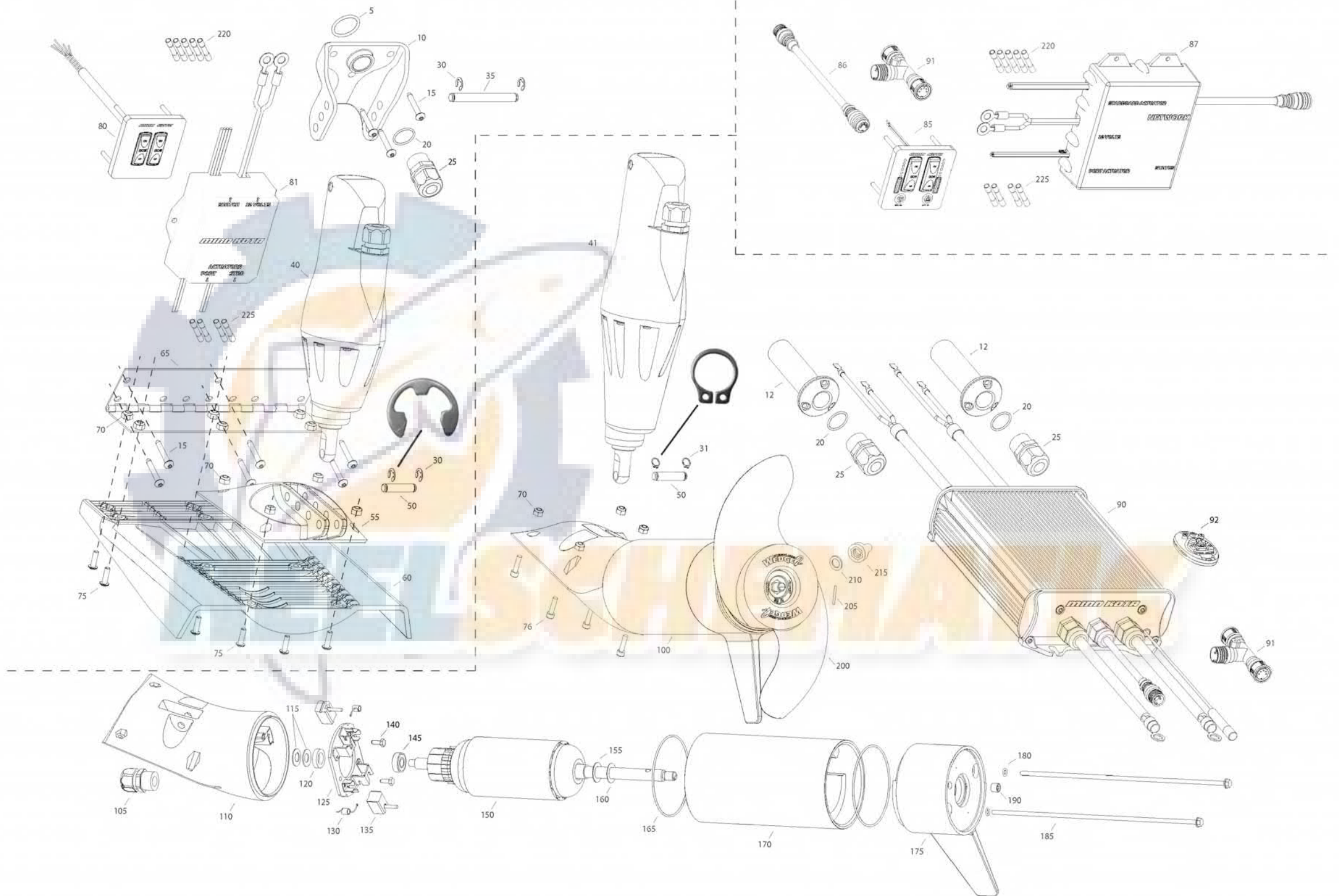

| Item | P/N | Description | Qty | Item | P/N | Description | Qty |
|------|---------|------------------------------------|-------------|------|-----------|------------------------------------|-----|
| 5 | 2374613 | O-ring, upper mount | 1 | 100 | 2397234 | Motor Assembly 80# | 1 |
| 10 | 2371906 | Bracket, mounting , transom | 1 | | 2397251 | Motor Assembly 101# | 1 |
| 12 | 2374619 | Bulkhead | 1 | 105 | 2374630 | Fitting, NPT 1/2" | 1 |
| 15 | 2373490 | Screw 1/4 - 14 x 1 1/4 | 9 | 110 | 421-333 | Brush end housing | 1 |
| 20 | 2374631 | O-ring, Sealcon | 1 | 115 | 992-010 | Spring Washer | 2 |
| 25 | 2374630 | Fitting - NPT 1/2" | 1 | 120 | 990-045 | Thrust spacer | 1 |
| 30 | 2263006 | E-ring, 5/16 ss | 4 | 125 | 2-600-233 | Brush plate assembly | 1 |
| 31 | 2373020 | Snap-ring, 5/16ss | 2 | 130 | 975-041 | Spring, brush, torsion | 2 |
| 35 | 2372640 | Pin, upper mount | 1 | 135 | 186-094 | Brush | 2 |
| 40 | 2992801 | Actuator assembly, standard | 1 | 140 | 830-029 | Screw, brush plate | 2 |
| | 2992805 | Actuator assembly, short | 1 | 145 | 140-010 | Bearing | 1 |
| 41 | 2992800 | Actuator assembly, long | 1 | 150 | 2-100-233 | Armature assembly 80# | 1 |
| 50 | 2262665 | Pin, lower mount | 1 | | 2-100-230 | Armature assembly 101# | 1 |
| 55 | 2371908 | Mount, lower | 1 | 155 | 990-051 | Washer, steel | 1 |
| 60 | 2778700 | Tab, 9x9 assembly [55-75] | 1 | 160 | 990-045 | Washer, nylatron | 1 |
| | 2778701 | Tab, 9x12 assembly [55-75] | 1 | 165 | 701-043 | O-ring, housing | 2 |
| | 2778702 | Tab, 9x18 assembly [55-75] | 1 | 170 | 2-200-333 | Center housing 80# | 1 |
| | 2778710 | Tab, 12x9 assembly [55-75] | 1 | | 2-200-330 | Center housing 101# | 1 |
| | 2778711 | Tab, 12x12 assembly [55-75] | 1 | 175 | 2-300-341 | Plain end housing | 1 |
| | 2778712 | Tab, 12x18 assembly [55-75] | 1 | 180 | 701-009 | O-ring- thru-bolts | 2 |
| 65 | 2371800 | Hinge, 9" [included in 60] | 1 | 185 | 830-094 | Thru-bolt 80# | 2 |
| | 2371801 | Hinge, 12" [included in 60] | 1 | | 830-098 | Thru-bolt 101# | 2 |
| | 2371802 | Hinge, 18" [included in 60] | 1 | 190 | 836-001 | Plug, pipe | 1 |
| 70 | 2333101 | Nut, 10-24 Nylock | as required | | | | |
| 75 | 2373406 | Screw, 10-24 x 5/8 | as required | 200 | 1378132 | Propeller kit | 1 |
| 76 | 2373423 | Screw, 10-24 X 3/4 SHCS | 4 | 205 | 2331160 | Propeller W. Wedge 2 | 1 |
| ■ | 1863700 | Trim tab rocker switch kit [80-81] | | 210 | 2091701 | Washer - prop, large | 1 |
| 80 | 2994042 | Soft rocker switch assembly | 1 | 215 | 2198401 | Anode, Nut | 1 |
| 81 | 2994077 | Basic switch control module | 1 | | | | |
| 85 | 2994056 | Indicator switch assembly | 1 | 220 | 2370739 | Adhesive filled butsplice 18-22 ga | 6 |
| | 2994057 | Auxiliary switch assembly | 1 | 225 | 2370738 | Adhesive filled butsplice 14-16 ga | 4 |
| 86 | 2373230 | Network extension cable, 5' | 1 | | | | |
| | 2373231 | Network extension cable, 10' | 1 | | | | |
| | 2373232 | Network extension cable, 25' | 1 | | | | |
| 87 | 2996517 | Indicator Switch control module | 1 | | | | |
| 90 | 2996519 | Motor control unit | 1 | | | | |
| 91 | 2370734 | Network splitter | 1 | | | | |
| 92 | 2994025 | Remote transmitter | 1 | | | | |

****NOTE TO INSTALLER:** ABYC Requirements dictate that a 15A breaker be placed in line with each individual actuator and a 30A breaker at the power lead of the Rocker Switch Control Module. These breakers must be provided by the installer. See the wiring diagram below for recommended placement.

Basic Switch Trim Tab System

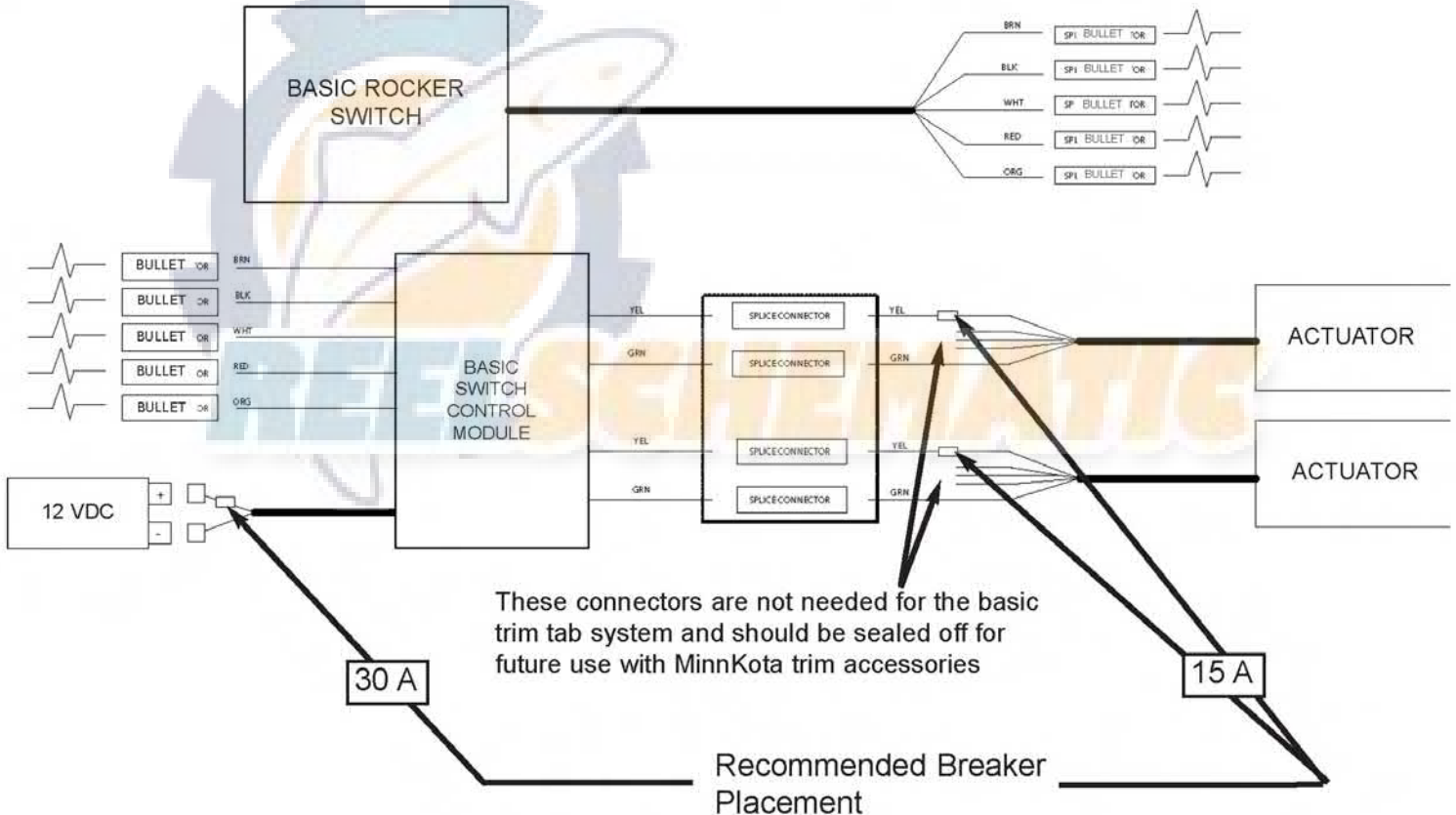

Indicator Switch Trim Tab System

****NOTE TO INSTALLER:** ABYC Requirements dictate that a 15A breaker be placed in line with each individual actuator and a 30A breaker at the power lead of the Rocker Switch Control Module. These breakers must be provided by the installer. See the wiring diagram below for recommended placement.

