

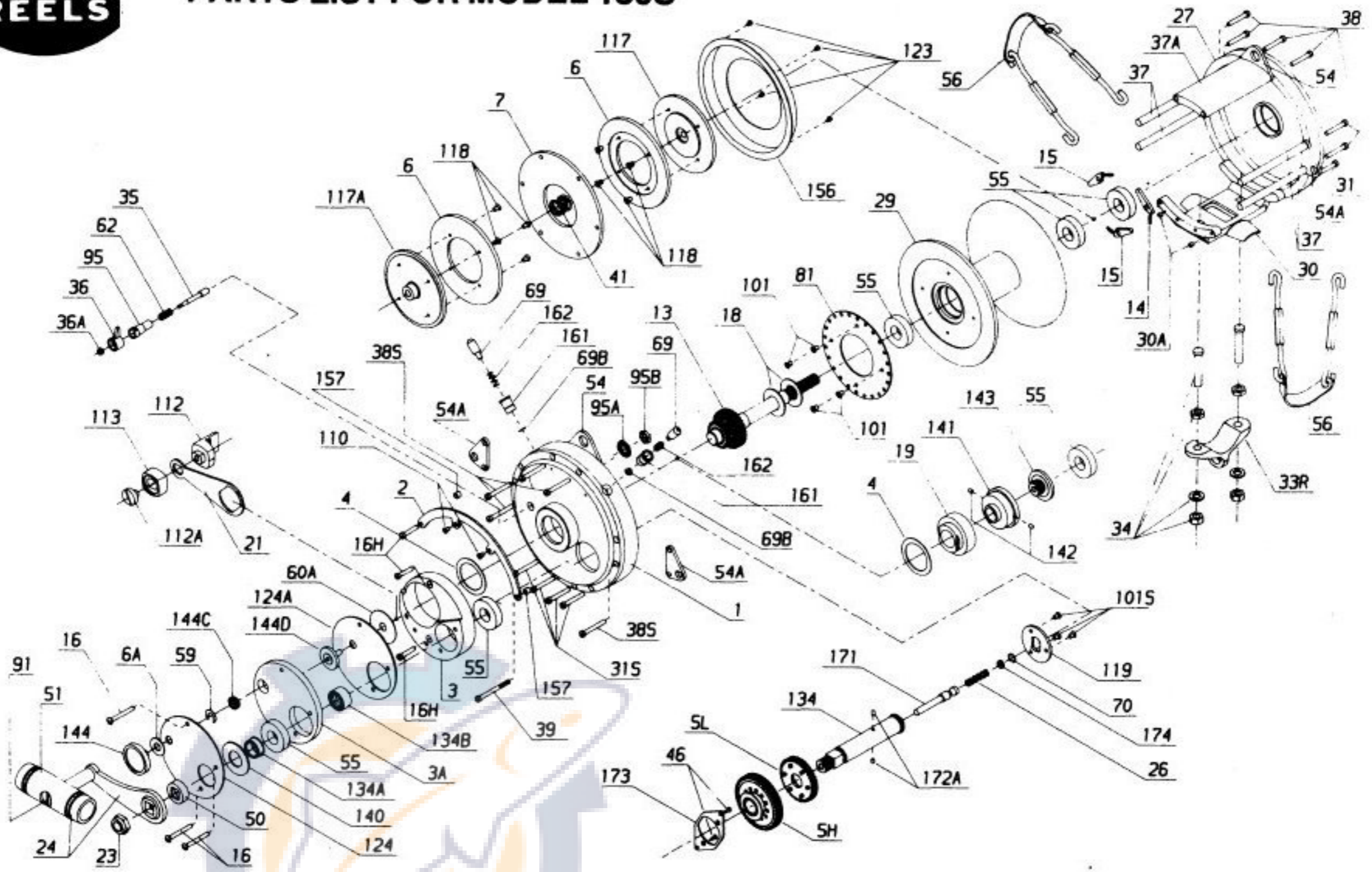

PARTS LIST FOR MODEL 130S



Penn Reel Parts list for:

KEY PART

NO.	NO.	DESCRIPTION
1	1-130S	R.S. PLATE ASSEMBLY
2	2-130	QUADRANT RING
3	3-130	BRIDGE (INNER)
3A	3A-130	BRIDGE (OUTER)
4	4-130	CAM THRUST WASHER
5H	5-130HS	MAIN GEAR HIGH SPEED
5L	5-130LS	MAIN GEAR LOW SPEED
6	6-130	DRAG WASHER
6A	6-155	SPACING WASHER
7	7A-130	METAL DRAG WASHER
13	13-130S	PINION GEAR
14	49-710	DOG SPRING
15	15-130	DOG
16	16-130	BRIDGE SCREW
16H	16H-130	BRIDGE SCREW (HIDDEN)
18	18-130	CLUTCH SPRING
19	19-130	ECCENTRIC CAM
21	21-130	ECCENTRIC CAM LEVER
23	23-130	HANDLE NUT
24	24-130	HANDLE COMPLETE
26	18-130S	GEAR STUD SPRING
27	27-130S	LEFT SIDE PLATE
29	29L-130	SPOOL
30	30-130	STAND
30A	30A-130	DOWEL TUBE
31	31-130	STAND SCREWS (4 REQ.)
31S	31-130S	STAND SCREWS (4 REQ.)
33R	33R-130	RINGED ROD CLAMP
34	34-130	ROD CLAMP SCREW W/NUTS
35	35-130S	CLICK TONGUE
36	36-50	CLICK BUTTON
36A	36-700	CLICK BUTTON NUT
37	37-130	FRAME POST
37A	37A-130S	SPACER BAR
38	38-130	POST SCREW (8 REQ.)
38S	38-130S	POST SCREW (5 REQ.)
39	39-130S	LONG QUADRANT SCREW
41	41-130	LEFT SIDE BEARING SPRING
46	46A-704	GEAR RETAINING SCREW
50	50-130S	SHIELD
51	51-130	HANDLE KNOB
54	54-130	HARNES LUG
54A	54A-130	ROD BRACE LUG
55	55-130	BALL BEARING

Model: 130S INTERNATIONAL

KEY PART

NO.	NO.	DESCRIPTION
56	56C-117	ROD BRACE COMPLETE
59	59-130	SLOTTED WASHER
60A	60A-130	BACKING WASHER
62	62-50	CLICK SPRING
69	69-130	LOCATING PIN
69B	69B-130	RETAINING RING
70	69B-130S	RETAINING RING
81	81-130	RATCHET
91	91-130	HANDLE SHAFT
95	95-130	CLICK TONGUE BUSHING
95A	95A-20	CLICK BUSHING WASHER
95B	38-710	CLICK BUSHING NUT
101	101-30	RATCHET SCREW (4 REQ.)
101S	101-130S	COUPLING PLATE SCREW (3 REQ.)
110	110-50	QUADRANT SCREW (CENTER)
112	112-130	ECCENTRIC LEVER KNOB
112A	112A-130	ECCENTRIC KNOB SCREW
113	113-130	ECCENTRIC LEVER CAP
117	117-130	DRIVE PLATE (OUTER)
117A	117A-130	DRIVE PLATE (INNER)
118	118-80S	DRIVE PLATE SCREW (8 REQ.)
119	119-130S	COUPLING PLATE
123	123-50	DRAG COVER SCREW
124	124-130	BRIDGE COVER (OUTER)
124A	124A-130	BRIDGE COVER (INNER)
134	134-130S	GEAR STUD
134A	134A-130S	INDICATOR BUSHING
134B	134B-130S	BEARING SPACING BUSHING
140	140-115	FELT WASHER
141	141-130	CAM FOLLOWER
142	142-130	CAM FOLLOWER PIN
143	143-130	ADJUSTING SCREW
144	144-130	PRESET KNOB
144C	144C-130	PRESET PINION
144D	144D-130	PRESET GEAR ASSEMBLY
156	156-130	DRAG COVER
157	157-130	QUADRANT SPACER BUSHING
161	161-130	LOCATING PIN BUSHING
162	162-130	LOCATING PIN SPRING
171	171-130S	PLUNGER
172A	172A-130S	PLUNGER PIN
173	173-130S	GEAR RETAINER
174	174-130S	GEAR STUD PLUG