



INTERNATIONAL® 975CSLD SPECIFICATIONS AND PARTS LIST

Congratulations on the purchase of your new

Penn International® baitcaster! For general

features, operating instructions, casting control

information, maintenance, lubrication and

servicing, please refer to the main International®

manual (featuring the 965). Keep this sheet

for reference to 975CSLD part numbers and

specifications. Good fishing!

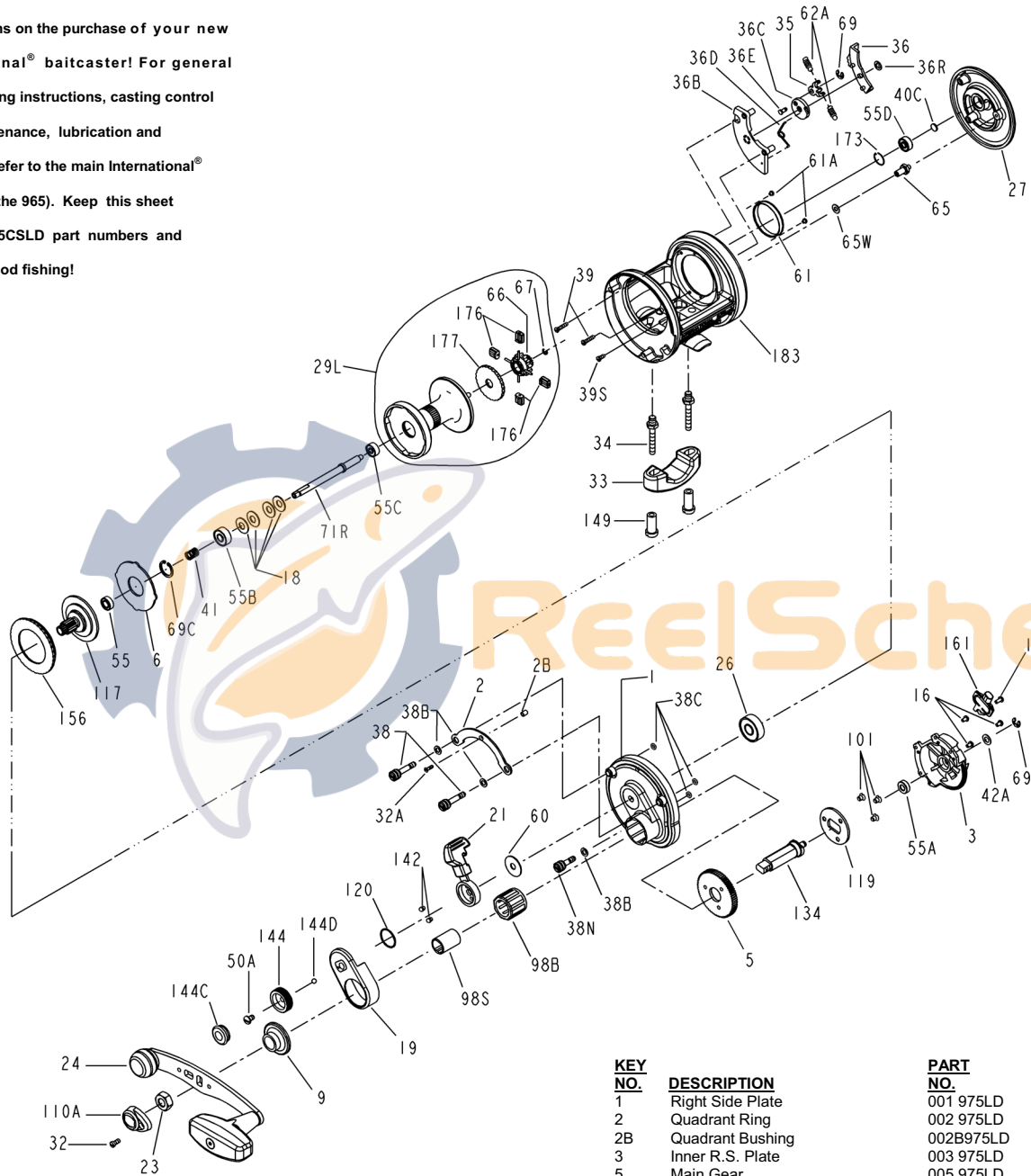

| LINE CAPACITY | GEAR RATIO | WEIGHT |
|----------------------|------------|-----------|
| 300 YDS / 15 LBS | 4.4-1 | 16.2 OZ |
| 275 METERS / 0.40 MM | | 460 GRAMS |

| KEY NO. | DESCRIPTION | PART NO. |
|---------|-----------------------------|-----------|
| 1 | Right Side Plate | 001 975LD |
| 2 | Quadrant Ring | 002 975LD |
| 2B | Quadrant Bushing | 002B975LD |
| 3 | Inner R.S. Plate | 003 975LD |
| 5 | Main Gear | 005 975LD |
| 6 | Drag Washer HT-100 | 006 975LD |
| 9 | Handle Collar | 009 975LD |
| 16 | Bridge Screws (3 req.) | 016 975LD |
| 17 | Long Bridge Screw | 017 975LD |
| 18 | Disc Clutch Spring (4 req.) | 018 975LD |

| KEY NO. | DESCRIPTION | PART NO. |
|---------|--------------------------------|-------------|
| 19 | Cam Assembly | 019 975LD |
| 21 | Eccentric Lever | 021 975LD |
| 23 | Handle Nut | 023 555 |
| 24 | Handle Assembly | 024 555 |
| 26 | R. S. Plate Bearing | 026N025 |
| 27 | Left Side Plate | 027 975 |
| 29L | Spool Assembly | 029L975LD |
| 32 | Handle Cap Screw | 032 015 |
| 32A | Quadrant Screw | 032 975LD |
| 33 | Rod Clamp | 033 113 |
| 34 | Rod Clamp Screw (2 req.) | 034 975 |
| 35 | Click Tongue | 035 965 |
| 36 | Click Button | 036 975 |
| 36B | Click Housing | 036B975 |
| 36C | Click Wheel | 036C965 |
| 36D | Click Wheel Spring | 036D965 |
| 36E | Click Tongue Pin | 036E965 |
| 36R | Retaining Ring | 036R965 |
| 38 | Take-Apart Screw (2 req.) | 038 975LD |
| 38B | Side Plate Washer (3 req.) | 038BN965 |
| 38C | Screw 'O' Ring (3 req.) | 038CN965 |
| 38N | Take-Apart Screw | 038N965 |
| 39 | L.S. Plate Screw (2 req.) | 039 965 |
| 39S | L.S. Plate Short Screw | 039S965 |
| 40C | Metal Thrust Washer | 040C310 |
| 41 | Bearing Spring | 041 975LD |
| 42A | Metal Washer | 042R965 |
| 50A | Pre-Set Knob Screw | 050 716 |
| 55 | Ball Bearing | 055 965 |
| 55A | Gear Stud Bushing | 055A965 |
| 55B | Spool Bearing | 055 116 |
| 55C | Spool Bearing | 055 113H |
| 55D | Left Side Bearing | 055 113H |
| 60 | Eccentric Washer | 060 975LD |
| 61 | Brake Drum | 061 965 |
| 61A | Brake Drum Screw (2 req.) | 043B965 |
| 62A | Click Spring (2 req.) | 062A965 |
| 65 | Idler Gear Pin | 065 965 |
| 65W | Idler Gear Washer | 065W965 |
| 66 | Spool Gear Click Ratchet | 066M965 |
| 67 | Lock Ring | 067 016S |
| 69 | Retaining Ring | 069B050 |
| 69C | Spool Retaining Ring | 069 975LD |
| 69B | Retaining Ring | 069B600 |
| 71R | Spool Spindle | 071R975LD |
| 98B | Clutch Bearing | 098B525 |
| 98S | Bearing Clutch Sleeve | 098S525 |
| 101 | Retaining Plate Screw (3 req.) | 101 050S |
| 110A | Handle Nut Cap | 110A555 |
| 117 | Drive Plate Assembly | 117 975LD |
| 119 | Retaining Plate | 119 030S |
| 120 | Eccentric O-Ring | 026R965 |
| 134 | Gear Stud | 134 975LD |
| 142 | Cam Follower (2 req.) | 142 975LD |
| 144 | Preset Knob | 144 975LD |
| 144C | Preset Knob Cap | 144C975LD |
| 144D | Preset Knob Click Ball | 144D975LD |
| 149 | Rod Clamp Nut (2 req.) | 149 045 |
| 156 | Drag Cover | 156 975LD |
| 161 | Strike Button | 161 975LD |
| 173 | L.S. Bearing Retainer | 173 965 |
| 176 | Anti-Backlash Brakes (4 req.) | 176 975LD |
| 177 | Brake Selection Knob | 177 965 |
| 183 | Frame Assembly | 183 975CSLD |