

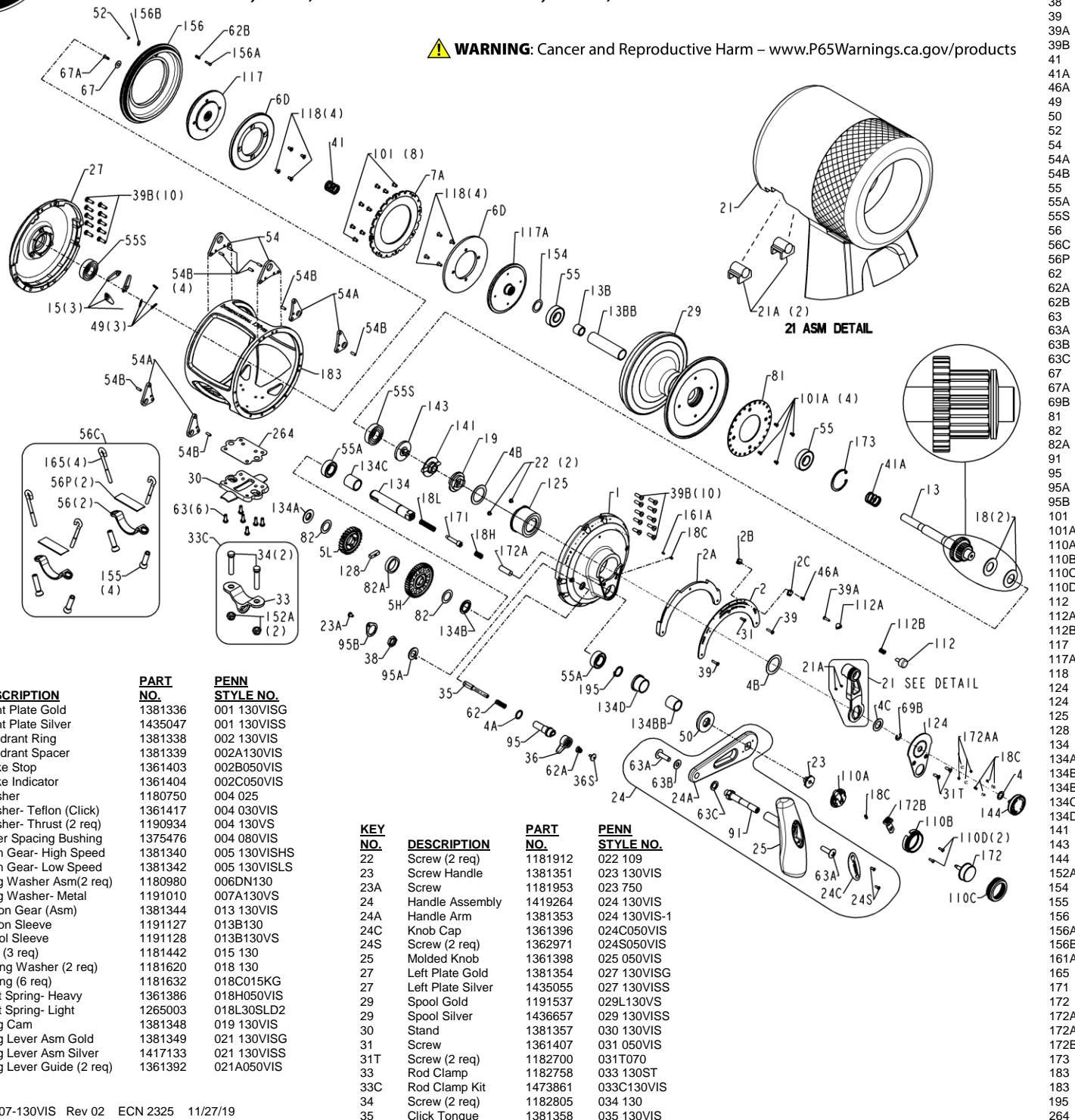

**MODELS 130VIS, Gold, 1370785 and 130VISS, Silver, 1419237**

**⚠ WARNING:** Cancer and Reproductive Harm – [www.P65Warnings.ca.gov/products](http://www.P65Warnings.ca.gov/products)



**KEY NO.**

KEY NO.	DESCRIPTION	PART NO.	PENN STYLE NO.
1	Right Plate Gold	1381336	001 130VISG
1	Right Plate Silver	1435047	001 130VISS
2	Quadrant Ring	1381338	002 130VIS
2A	Quadrant Spacer	1381339	002A130VIS
2B	Strike Stop	1361403	002B050VIS
2C	Strike Indicator	1361404	002C050VIS
4	Washer	1180750	004 025
4A	Washer- Teflon (Click)	1361417	004 030VIS
4B	Washer- Thrust (2 req)	1190934	004 130VS
4C	Lever Spacing Bushing	1375476	004 080VIS
5H	Main Gear- High Speed	1381340	005 130VISHS
5L	Main Gear- Low Speed	1381342	005 130VISLS
6D	Drag Washer Asm(2 req)	1180980	006DN130
7A	Drag Washer- Metal	1191010	007A130VS
13	Pinion Gear (Asm)	1381344	013 130VIS
13B	Pinion Sleeve	1191127	013B130
13BB	Spool Sleeve	1191128	013B130VS
15	Dog (3 req)	1181442	015 130
18	Spring Washer (2 req)	1181620	018 130
18C	Spring (6 req)	1181632	018C015KG
18H	Shift Spring- Heavy	1361386	018H050VIS
18L	Shift Spring- Light	1265003	018L30SLD2
19	Drag Cam	1381348	019 130VIS
21	Drag Lever Asm Gold	1381349	021 130VISG
21	Drag Lever Asm Silver	1417133	021 130VISS
21A	Drag Lever Guide (2 req)	1361392	021A050VIS

**KEY NO.**

KEY NO.	DESCRIPTION	PART NO.	PENN STYLE NO.
22	Screw (2 req)	1181912	022 109
23	Screw Handle	1381351	023 130VIS
23A	Screw	1181953	023 750
24	Handle Assembly	1419264	024 130VIS
24A	Handle Arm	1381353	024 130VIS-1
24C	Knob Cap	1361396	024C050VIS
24S	Screw (2 req)	1362971	024S050VIS
25	Molded Knob	1361398	025 050VIS
27	Left Plate Gold	1381354	027 130VISG
27	Left Plate Silver	1435055	027 130VISS
29	Spool Gold	1191537	029L130VS
29	Spool Silver	1436657	029 130VISS
30	Stand	1381357	030 130VIS
31	Screw	1361407	031 050VIS
31T	Screw (2 req)	1182700	031T070
33	Rod Clamp	1182758	033 130ST
33C	Rod Clamp Kit	1473861	033C130VIS
34	Screw (2 req)	1182805	034 130
35	Click Tongue	1381358	035 130VIS

**KEY NO.**

KEY NO.	DESCRIPTION	PART NO.	PENN STYLE NO.
36	Click Button	1361409	036 050VIS
36S	Screw	1361410	036S050VIS
38	Nut	1183157	038 710
39	Screw (2 req)	1229975	039 012VXS
39A	Screw	1361411	039 050VIS
39B	Screw (20 req)	1375491	039 080VISN
41	Spring	1191789	041 130VS
41A	Spring	1191792	041A130VS
46A	Screw	1183585	046A4300
49	Spring (3 req)	1183741	049 710
50	Gear Stud Shield	1448075	050 080VIS
52	E-Clip Retainer	1183840	052 910
54	Harness Lug (2 req)	1192019	054 130VS
54A	Harness Lug (4 req)	1192024	054A130VS
54B	Pin- Dowel (8 req)	1183869	054B130
55	Ball Bearing (2 req)	1183884	055 130
55A	Ball Bearing (2 req)	1183879	055 080ST
55S	Ball Bearing (2 req)	1446916	055S130
56	Rod Brace (2 req)	1184187	056 130VIS
56C	Rod Brace Kit	1457390	056C130VIS
56P	Rod Brace Pad(2 req)	1183913	056P117
62	Spring- Click Tongue	1184022	062 050
62A	Spring- Click (Conical)	1361425	062 050VIS
62B	Spring	1184029	062 545
63	Screw (6 req)	1184045	063 030T
63A	Handle Screw (2 req)	1184056	063A050
63B	Washer- Handle Screw	1361426	063B050VIS
63C	Washer- Handle Rivet	1411589	063C050VIS
67	Retaining Plate (Washer)	1184106	067 070
67A	Screw	1184111	067A070
69B	Retainer	1375493	069B080VIS
81	Click Ratchet Ring (Spool)	1184208	081 130
82	Washer- Teflon (Gears) (2 req)	1375494	082 080VIS
82A	Spacer-Teflon	1381359	082A130VIS
91	Handle Rivet	1361435	091 050VIS
95	Click Bushing	1375495	095 080VIS
95A	Washer-Click Bushing	1184311	095A050
95B	Click Retaining Plate	1184312	095B070
101	Screw (8 req)	1184406	101 130S
101A	Screw (4 req)	1184403	101 030
110A	Shift Button Base	1381360	110A130VIS
110B	Shift Button Body	1381361	110B130VIS
110C	Shift Button Retainer Ring	1381362	110C130VIS
110D	Shift Base Screw- (2 req)	1361350	110D050VIS
112	Strike Button	1375496	112 130VIS
112A	Strike Gate	1361352	112A050VIS
112B	Spring-Strike Button	1361353	112B050VIS
117	Drive Plate Asm- Outer	1184481	117 130
117A	Drive Plate Asm- Inner	1184494	117A130
118	Screw (8req)	1184513	118 080S
124	Bridge Cover Gold	1381363	124 130VISG
124	Bridge Cover Silver	1448071	124 130VISS
125	Cam Housing	1381364	125 130VIS
128	Gear Shift Key	1381365	128 130VIS
134	Gear Stud	1375499	134 080VIS
134A	Nut- Gear Stud	1265086	134A30SLD2
134B	Gear Spacer	1375500	134B080VIS
134BB	Spacer	1192321	134BB080VIS
134C	Spacer	1375501	134C080VIS
134D	Bushing	1448076	134D080VIS
141	Cam Follower	1381366	141 130VIS
143	Screw Drag	1381367	143 130VIS
144	Preset Knob	1375504	144 080VIS
152A	Clamp Nut (2 req)	1184714	152A080T
154	Shim (as required)	1184722	154 130
155	Nut- Rod Brace (4 req)	1184726	155 130
156	Drag Cover	1192354	156 130VIS
156A	Pin, Drag Cover	1184752	156A030VS
156B	Plate, Drag Cover	1184756	156B030VS
161A	Lever Click Tongue	1474317	161A130VIS
165	Hook Screw (4 req)	1184799	165 130
171	Shift Plunger (Screw)	1230659	171 012VS
172	Shift Button	1381368	172 130VIS
172A	Spacer	1375506	172A080VIS
172AA	Preset Click Pin (4 req)	1453043	172AA130VIS
172B	Shift Latch Molded	1381370	172B130VIS
173	Retainer	1192388	173 130VS
183	Frame Gold	1381371	183 130VISG
183	Frame Silver	1428279	183 130VISS
195	Retaining Ring	1184956	195 600
264	Stand Gasket	1185229	264 130ST