

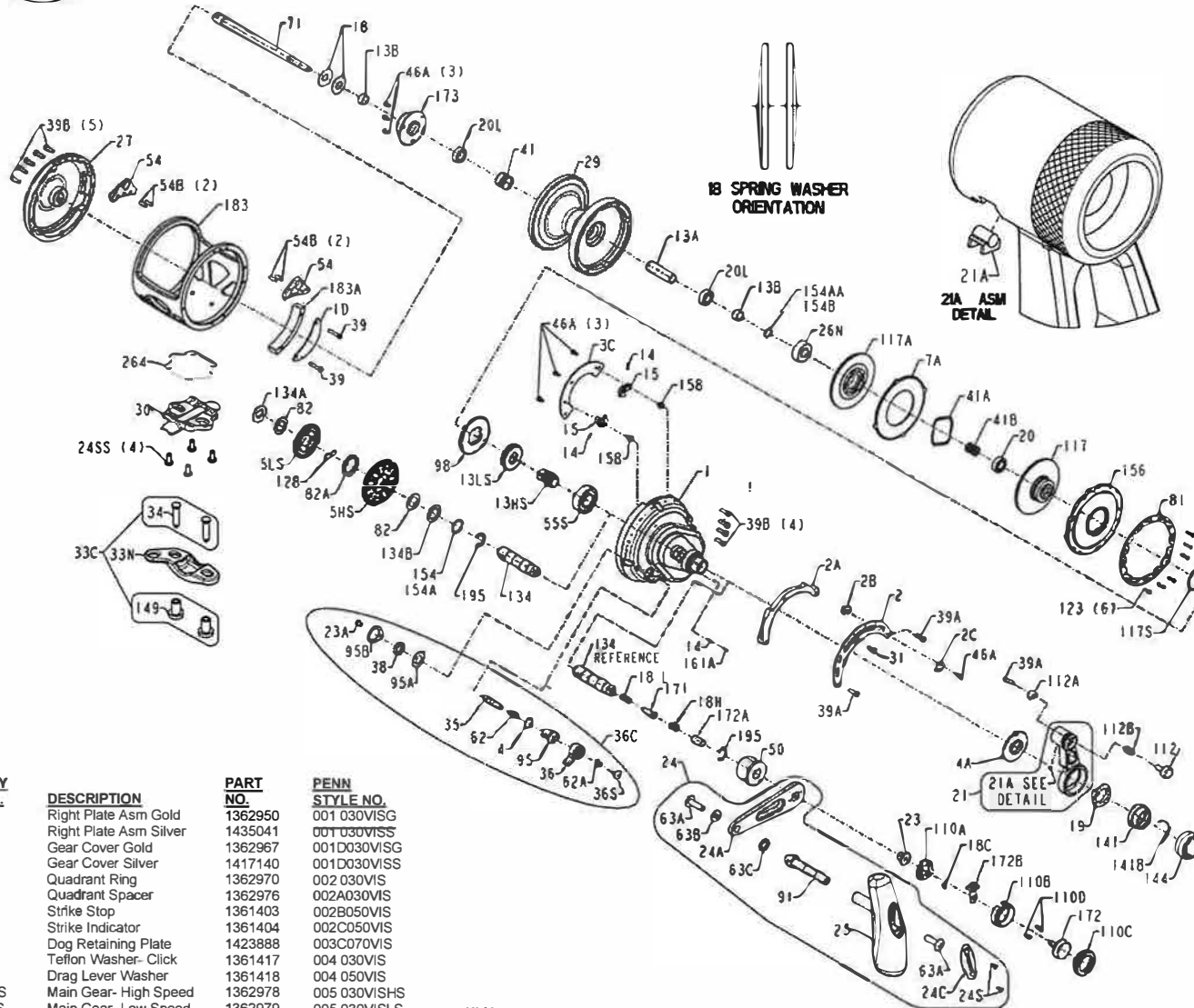

MODELS 30VISX, Gold, 1370780 and 30VISXS, Silver, 1419232



KEY NO.

KEY NO.	DESCRIPTION
1	Right Plate Asm Gold
1	Right Plate Asm Silver
1D	Gear Cover Gold
1D	Gear Cover Silver
2	Quadrant Ring
2A	Quadrant Spacer
2B	Strike Stop
2C	Strike Indicator
3C	Dog Retaining Plate
4	Teflon Washer- Click
4A	Drag Lever Washer
4A	Main Gear- High Speed
5HS	Main Gear- Low Speed
5LS	Drag Washer- Metal
7A	Spool Spacer Tube
13A	Spool Spacer (2 req)
13B	Pinion- High Speed
13HS	Pinion- Low Speed
13LS	Dog/Click Spring (3 req)
14	Dog (2 req)
15	Spring Washer (2 req)
18C	Shifter Spring
18H	Shift Spring- Heavy
18L	Shift Spring- Light

PART NO.

PART NO.	PENN STYLE NO.
1362950	001 030VISG
1435041	007 030VISS
1362967	001D030VISG
1417140	001D030VISS
1362970	002 030VIS
1362976	002A030VIS
1361403	002B050VIS
1361404	002C050VIS
1423888	003C070VIS
1361417	004 030VIS
1361418	004 050VIS
1362978	005 030VISHS
1362979	005 030VISLS
1362988	007A030VIS
1362954	013A030VISX
1361364	013B050VIS
1362955	013 030VISHS
1362956	013 030VISLS
1181406	014 535
1423959	015 070VIS
1362961	018 030VIS
1181632	018C015KG
1265002	018H30SLD2
1265003	018L30SLD2

KEY NO.

KEY NO.	DESCRIPTION
19	Drag Cam
20	Bearing
20L	Bearing (2 req)
21	Drag Lever Asm Gold
21	Drag Lever Asm Silver
21A	Drag Lever Guide
23	Screw- Handle
23A	Screw- Click Retaining Plate
24	Handle Assembly
24A	Handle Arm
24C	Knob Cap
24S	Screw-Knob Cap (2 req)
24SS	Screw- Stand (4 req)

PART NO.

PART NO.	PENN STYLE NO.
1389501	019 050VISX
1181792	020 722
1233759	020L722
1362968	021 030VISG
1417129	021 030VISS
1361392	021A050VIS
1361394	023 050VIS
1191283	023L750
1379677	024 050VIS
1361395	024 050VIS-1
1361396	024C050VIS
1362971	024S050VIS
1239042	024S252MAG2

KEY NO.

KEY NO.	DESCRIPTION
25	Molded Knob
26N	Ball Bearing
27	Left Side Plate Gold
27	Left Side Plate Silver
29	Spool Gold
29	Spool Silver
30	Stand
31	Screw- Center Quadrant
33C	Rod Clamp Kit
33N	Rod Clamp
34	Screw- Rod Clamp (2 req)
35	Click Tongue
36	Click Button
36C	Click SubAssembly
36S	Screw-Click Button
38	Nut- Click Retainer
39	Screw-Gear Cover (2 req)
39A	Screw (3 req)
39B	Screw- Left+Right Side (9 req)
41	Spring- Left Side Spool
41A	Spring- Drag Separating (Wave)
41B	Spring- Drive Plate Retaining
46A	Screw (7 req)
50	Gear Stud Shield
54	Harness Lug (2 req)
54B	Pin- Dowel (4 req)
55S	Ball Bearing
62	Spring- Click Tongue
62A	Spring- Click Button (Conical)
63A	Screw- Handle(2 req)
63B	Washer- Handle Screw
63C	Washer- Handle Rivet
71	Spindle Assembly
81	Click Ratchet Ring (Spool)
82	Washer-Teflon (Gears) (2 req)
82A	Washer- Gear Separating
91	Handle Rivet
95	Click Bushing
95A	Washer-Click Bushing
95B	Click Retaining Plate
98	Anti-Reverse Ratchet
110A	Shift Button Base
110B	Shift Button Body
110C	Shift Button Retainer Ring
110D	Shift Base Screw- (2 req)
112	Strike Button
112A	Strike Gate
112B	Spring-Strike Button
117	Drive Plate Asm- Outer
117A	Drive Plate Asm- Inner
117S	Drag Cover Seal
123	Screw- Spool Ratchet (6 req)
128	Shift Key
134	Gear Stud
134A	Nut- Gear Stud
134B	Gear Spacer
141	Cam Follower
141B	Preset Knob Click Spring
144	Preset Knob
149	Clamp Nut (2 req)
154	Gear Stud Shim (as required)
154A	Gear Stud Shim (as required)
154AA	Spool Shim 005 (as required)
154AB	Spool Shim 010 (as required)
154B	Drag Cover
156	Dog Pin (2 req)
161A	Lever Click Pin
171	Shift Plunger (Screw)
172	Shift Button (asm)
172A	Shift Spacer
172B	Shift Latch (Moulded)
173	Spool Bearing Retainer
183	Frame Gold
183	Frame Silver
183A	Frame Extension Gold
183A	Frame Extension Silver
195	Retaining Ring (2 req)
264	Stand Gasket

1418700 407-30VISX Rev 01 ECN 2356 2/24/20