

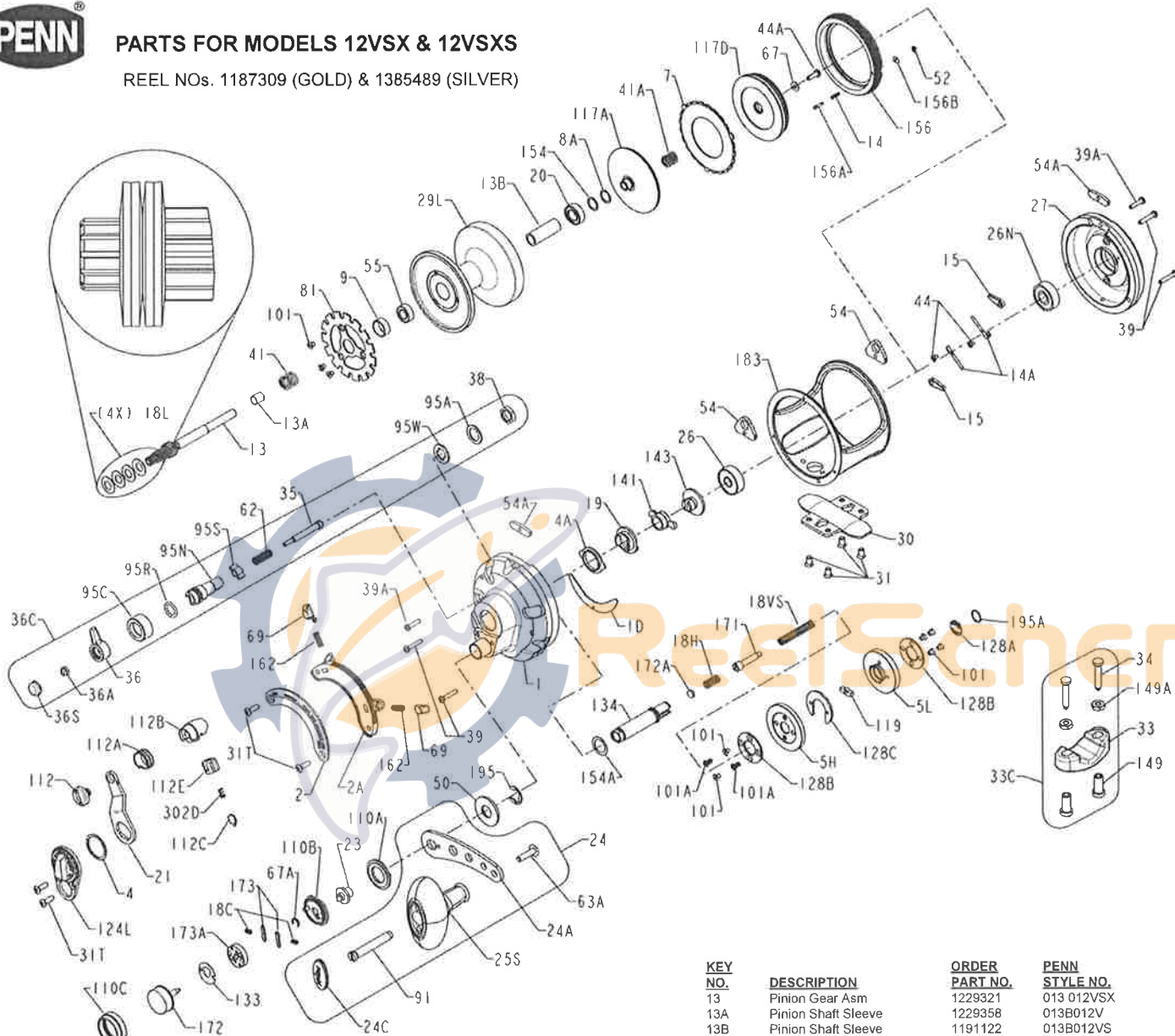

# PARTS FOR MODELS 12VSX & 12VSXS

REEL NOs. 1187309 (GOLD) & 1385489 (SILVER)



KEY NO.	DESCRIPTION	ORDER PART NO.	PENN STYLE NO.
27	L S Plate Asm (GOLD)	1237162	027 012VSX
27	L S Plate Asm (SILVER)	1390193	027 012VSXSLV
29L	Spool Assembly (GOLD)	1191528	029L012VS
29L	Spool Assembly (SILVER)	1389486	029L012VSSLV
30	Stand	1182599	030 016VS
31	8-32 Slotted Flt Hd (4 req)	1191562	031 016VS
31T	6-40 T15 Oval Hd (4 req)	1182700	031T070
33	Rod Clamp	1191592	033 016VS
33C	Rod Clamp Kit	1238449	033C012VSX
34	Clamp Screw (2 req)	1182786	034 016VS
35	Click Tongue	1182905	035 080ST
36	Click Lever	1182981	036 080ST
36A	5-40 Nut	1183014	036 700
36C	Clicker Assembly	1237165	036C012VS
36S	Click Button Cap	1183051	036S080ST
38	Click Bushing Nut	1183157	038 710
39	4-40 x .625 T10 PanHd (4 req)	1229974	039 012VS
39A	4-40 x .500 T10 PanHd (2 req)	1229975	039 012VSX
41	Drag Spring	1242832	041 012VS
41A	Drag Spring	1183329	041 109
44	3-48 Sl Pan Hd Ss (2 req.)	1183444	044 300T
44A	5-40 Sl Pan Hd	1183459	044 710
50	Gear Stud Shield	1191964	050 030VS
52	Retaining Ring	1191987	052 016VS
54	Harness Lug (2 inside 33C kit)	1230156	054 012VS
54A	Harness Lug Plug (2 req)	1230160	054A012VS
55	Ball Bearing	1237278	055L4200
62	Click Spring	1184023	062 080ST
63A	10-32 Truss Hd Screw	1192088	063A016VS
67	Pinion Retaining Washer	1192093	067 016VS
67A	Ring, Retaining	1184105	067 030VS
69	Drag Locating Pin (2 req)	1192105	069 012VS
81	Click Ratchet	1192151	081 012VS
91	Handle Rivet	1230343	091 012VSX
95A	Serrated Click Washer	1184310	095A020
95C	Click Adjustment Ring	1184313	095C080ST
95N	Click Tongue Bushing	1184314	095N080ST
95R	Click Adj. O-Ring	1184315	095R080ST
95S	Click Spring Slider	1184316	095S080ST
95W	Keyed Washer	1184317	095W080ST
101	5-40 Slotted Flthd (9 req)	1184404	101 050S
101A	5-40 T-15 Flthd (2 req)	1184403	101 030
110A	Handle Screw Locking Ring	1230438	110A012VS
110B	Shifter Base Asm	1230440	110B012VS
110C	Shift Button Retaining Ring	1230442	110C012VS
112	Drag Knob Screw (GOLD)	1192243	112 100LD
112	Drag Knob Screw (SILVER)	1389495	112 100DSLVL
112A	Drag Knob Sleeve	1192246	112A100LD
112B	Drag Lever Knob (GOLD)	1192248	112B100LD
112B	Drag Lever Knob (SILVER)	1389499	112B100DSLVL
112C	Drag Click Plate	1192712	112C030VS
112E	Drag Click Plate Housing	1192251	112E100LD
117A	Inner Drive Plate Asm	1192256	117A012VS
117D	Outer Drive Plate Asm	1192261	117D012VS
119	Shift Plate	1230530	119 012VS
124L	Bridge Cover Assembly	1230551	124L012VS
128A	Drive Plate (Inner)	1230576	128A012VS
128B	Connecting Drive Plate (2 req)	1192724	128B100LD
128C	Main Gear Connecting Plate	1230577	128C012VS
133	Retaining Plate	1230583	133 012VS
134	Gear Stud	1192306	134 012VS
141	Cam Follower	1184652	141 030VS
143	Preset Adj Screw	1184670	143 016VS
149	Rod Clamp Nut (2 req)	1184702	149 045
149A	Stand Screw Nut (2 req)	1184706	149 200
154	Shim (as required)	1192350	154 016VS
154A	Gear Sleeve Shim	1184718	154 050S
156	Drag Cover Assembly	1192351	156 012VS
156A	Drag Cover Lock Pin	1192356	156A016VS
156B	Drag Cover Lock Plate	1230626	156B012VS
162	Drag Pin Spring (2 req)	1184795	162 050
171	Plunger (Screw)	1230659	171 012VS
172	Shift Button Asm	1230660	172 012VS
172A	Spacer	1257292	172A012VS
173	Catch (2 req)	1192384	173 012VS
173A	Catch Holder	1230664	173A012VS
183	Frame Asm (GOLD)	1226451	183 012VSX
183	Frame Asm (SILVER)	1389502	183 012VSXSLV
195	Retaining Ring	1184955	195 040
195A	Retaining Ring, Spiral	1230789	195 012VS
302D	Drag Click Plate Spring	1185255	302D525MAG

KEY NO.	DESCRIPTION	ORDER PART NO.	PENN STYLE NO.
1	R S Plate Asm (GOLD)	1190802	001 012VS
1	R S Plate Asm (SILVER)	1389471	001 012VSSLV
1D	Backing Plate	1228864	001D012VS
2	Quadrant Ring	1190881	002 012VS
2A	Quadrant Ratchet	1228900	002A012VS
4	Teflon Thrust Washer	1180748	004 012LT
4A	Cam Bushing	1180752	004 030VS
5H	Main Gear, High Speed	1228985	005 012VSXHS
5L	Main Gear, Low Speed	1228986	005 012VSXLS
7	Drag Washer	1191001	007 012VS
8A	Shim (as required)	1229046	008ATS5-4
9	Spacing Sleeve	1229052	009 012VS

KEY NO.	DESCRIPTION	ORDER PART NO.	PENN STYLE NO.
13	Pinion Gear Asm	1229321	013 012VSX
13A	Pinion Shaft Sleeve	1229358	013B012V
13B	Pinion Shaft Sleeve	1191122	013B012VS
14	Drag Cover Lock Spring	1181393	014 099
14A	Dog Spring (2 req)	1191129	014 100LD
15	Dog (2 req)	1192597	015 100LD
18C	Shift Button Spring (2 req)	1181632	018C015KG
18H	Shifter Spring, Short	1181634	018H030VS
18VS	Shifter Spring, Long	1181637	018L030VS
18L	Spring Washer (4 req)	1191215	018H300LD
19	Eccentric Cam	1191220	019 016VS
20	Ball Bearing	1233759	020L722
21	Drag Lever	1191265	021 012VS
23	Handle Screw	1229458	023 012VS
24	Handle Assembly	1229468	024 012VSX
24A	Handle Blank	1233770	024 012VS-1
24C	Handle Knob Cap	1182092	024C113HN
25S	Handle Knob	1207739	025S113HN
26	Ball Bearing	1182112	026 040
26N	Ball Bearing, L.S.	1182146	026N040

1231447  
407-12VSX Rev 4  
E1801 4-16-15