

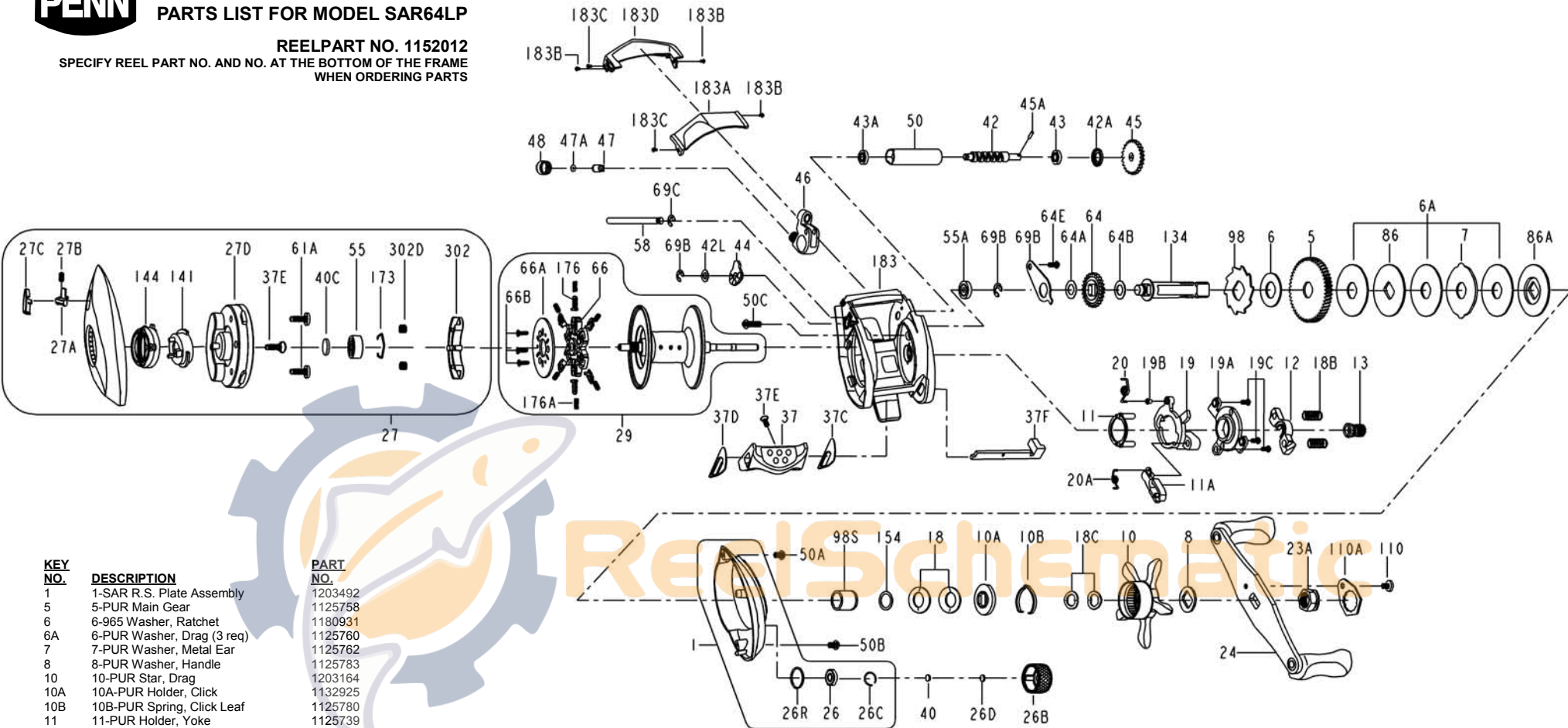

PARTS LIST FOR MODEL SAR64LP

REELPART NO. 1152012

SPECIFY REEL PART NO. AND NO. AT THE BOTTOM OF THE FRAME WHEN ORDERING PARTS



KEY NO.

DESCRIPTION

KEY NO.	DESCRIPTION	PART NO.
1	1-SAR R.S. Plate Assembly	1203492
5	5-PUR Main Gear	1125758
6	6-965 Washer, Ratchet	1180931
6A	6-PUR Washer, Drag (3 req)	1125760
7	7-PUR Washer, Metal Ear	1125762
8	8-PUR Washer, Handle	1125783
10	10-PUR Star, Drag	1203164
10A	10A-PUR Holder, Click	1132925
10B	10B-PUR Spring, Click Leaf	1125780
11	11-PUR Holder, Yoke	1125739
11A	11A-PUR Pawl, Return	1132908
12	12-PUR Yoke	1125753
13	13-PUR Pinion Gear	1125808
18	18-965 Washer, Drag Spring (2 req)	1181626
18B	18B-PUR Spring, Clutch (2 req)	1116237
18C	18C-PUR Washer, Spring (2 req)	1117208
19	19-PUR Cam, Clutch	1185751
19A	19A-PUR Plate, Clutch Cam	1125743
19B	19B-PUR Bushing, Clutch Cam	1116230
19C	19C-PUR Screw, Clutch (3 req)	1125744
20	20-PUR Spring, Torsion	1185750
20A	20A-PUR Spring, Return Torsion	1125745
23A	23A-PUR Nut, Handle	1203168
24	24-PUR Handle Assembly	1203239
26	26-PUR Bearing, R.S. Plate	1185715
26B	26B-SAR Cast Control Cap Asm	1185717
26C	26C-PUR Retainer, Bearing	1185716
26D	26D-PUR Washer, Tension	1125771
26R	26R-PUR 'O' Ring	1185714
27	27-SAR L.S. Plate Assembly	1203494
27A	27A-PUR Pin, Locking	1185763
27B	27B-PUR Spring, Push Button	1185765
27C	27C-PUR Button Assembly	1203248
27D	27D-SAR Spool Cover Asm	1185733
29	29-SAR Spool Assembly	1203496

KEY NO.

DESCRIPTION

KEY NO.	DESCRIPTION	PART NO.
37	37-SAR Clutch Bar	1185742
37C	37C-PUR Plate, R.S. Clutch Bar	1125801
37D	37D-PUR Plate, L.S. Clutch Bar	1125802
37E	37E-PUR Screw, Flat Head (2 req)	1124746
37F	37F-PUR Link, Clutch Bar	1185689
40	40-PUR Washer, Thrust	1125770
40C	40C-PUR Washer, Metal Thrust	1125797
42	42-PUR Shaft, Worm	1185691
42A	42A-PUR Bushing, R.S. Worm	1132855
42L	42L-PUR Washer, L.S. Worm	1185695
43	43-PUR Bearing, R.S. Worm	1185692
43A	43A-SAR Bearing, L.S. Worm	1204919
44	44-PUR Bushing L.S. Worm	1125734
45	45-PUR Gear, Worm	1185744
45A	45A-PUR Pin, Worm Shaft	1125733
46	46-PUR Carriage Assembly	1125804
47	47-PUR Pawl, Line Guide	1125806
47A	47A-PUR Washer, Pawl	1125736
48	48-PUR Screw, Pawl Cover	1144189

KEY NO.

DESCRIPTION

KEY NO.	DESCRIPTION	PART NO.
50	50-PUR Shield, Worm Shaft	1185693
50A	50A-PUR Screw, R.S. Plate	1187621
50B	50B-PUR Screw, R.S. Plate, F	1144207
50C	50C-PUR Screw, R.S. Frame, R	1125778
55	55-PUR Bearing, L.S. Plate	1128194
55A	55A-PUR Washer, Thrust	1185700
58	58-PUR Post, Line Guide	1204103
61A	61A-PUR Screw, Pan Head (2req)	1125822
64	64-PUR Gear, Worm Drive	1125748
64A	64A-PUR Washer	1125749
64B	64B-PUR Washer (G/Metal)	1125747
64C	64C-PUR Plate, Bearing	1125750
64E	64E-PUR Screw, Bearing Plate	1125752
66	66-PUR Holder, Brake Shoe	1187887
66A	66A-SAR Plate, Brake Holder	1187901
66B	66B-PUR Screw, Brake (3 req)	1187891
69B	69B-PUR 'E' Ring, Retaining (2req)	1124201
69C	69C-PUR 'E' Ring, Guide Post	1116226

KEY NO.

DESCRIPTION

KEY NO.	DESCRIPTION	PART NO.
86	86-PUR Washer, Keyed	1125761
86A	86A-PUR Washer, Metal Keyed Top	1125763
98	98-PUR Ratchet, Anti-Reverse	1125756
98S	98S-PUR Sleeve, Roller Clutch	1185704
110	110-PUR Screw, Handle Lock	1203262
110A	110A-PUR Plate, Handle Locking	1203263
134	134-PUR Gear Stud	1203264
141	141-SAR Cam, Cast Control Slide	1185732
144	144-SAR Cast Control Dial Asm	1203499
154	154-16VS Shim, As Needed 010"	1192350
173	173-PUR Retainer, L.S. Bearing	1104790
176	176-PUR Shoe, Brake (6 Req)	1187888
176A	176A-PUR Spring, Brake Shoe (6 Req)	1187892
183	183-SAR Frame	1203273
183A	183A-SAR Thumb Rest	1203500
183B	183B-PUR Screw, RS Thumb (3 Req)	1185747
183C	183C-PUR Screw, LS Thumb (2 Req)	1125738
183D	183D-SAR Cover, Front Frame	1203501
302	302-SAR Magnet Assembly	1185738
302D	302D-SAR Spring, Mag Asm (2 Req)	1185737