

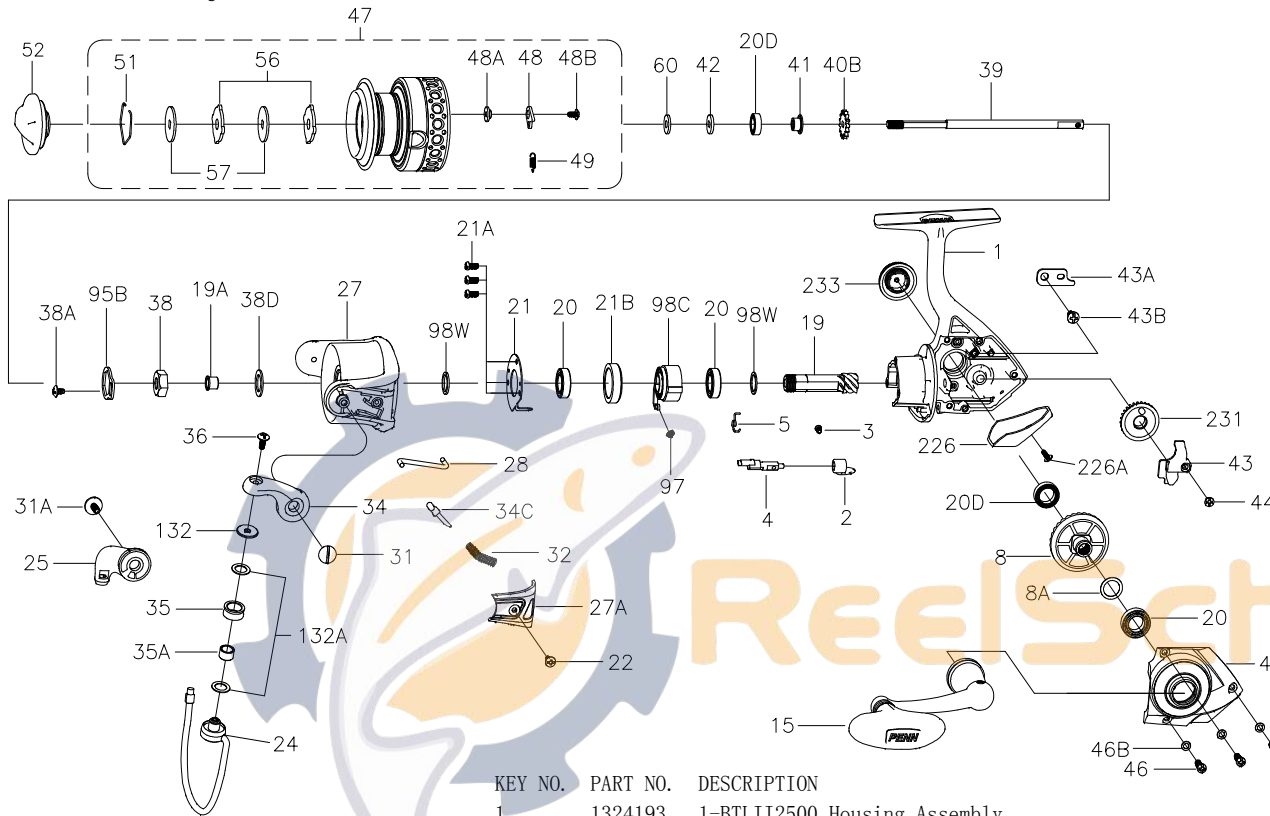

# PARTS LIST FOR MODEL BTLII2500



| KEY NO. | PART NO. | DESCRIPTION                               |
|---------|----------|---|
| 1       | 1324193  | 1-BTLII2500 Housing Assembly              |
| 2       | 1190889  | 2-2000SG A/R Lever                        |
| 3       | 1190922  | 3-2000SG A/R Lever Screw                  |
| 4       | 1313805  | 4-CFT2500 A/R Shaft                       |
| 5       | 1313806  | 5-CFT2500 A/R Spring                      |
| 8       | 1308047  | 8-CFT3000 Main Gear                       |
| 8A      | 1191028  | 8A-3000SG Shim                            |
| 15      | 1324182  | 15-BTLII2000 Handle Assembly              |
| 19      | 1364313  | 19-BTLII2500 Pinion Gear                  |
| 19A     | 1364314  | 19A-BTLII2500 Pinion Bushing              |
| 20      | 1308050  | 20-CFT3000 Ball Bearing (3 req)           |
| 20D     | 1211610  | 20D-5000BTL Housing Ball Bearing          |
| 20D     | 1211567  | 20D-2000BTL Spool Ball Bearing            |
| 21      | 1192629  | 21-2000SG Bearing Retainer                |
| 21A     | 1192644  | 21A-3000SG Bearing Retainer Screw (3 req) |
| 21B     | 1192646  | 21B-2000SG Collar                         |
| 22      | 1192658  | 22-2000SG Bail Pivot Cover Screw          |
| 24      | 1324194  | 24-BTLII2500 Bail Wire                    |

| KEY NO. | PART NO. | DESCRIPTION                             |
|---------|----------|---|
| 25      | 1313810  | 25-CFT2500 Bail Holder                  |
| 27      | 1324195  | 27-BTLII2500 Rotor                      |
| 27A     | 1324196  | 27A-BTLII2500 Bail Pivot Cover          |
| 28      | 1324197  | 28-BTLII2500 Trip Lever                 |
| 31      | 1324187  | 31-BTLII2000 Bail Arm Screw             |
| 31A     | 1324188  | 31A-BTLII2000 Bail Cam Screw            |
| 32      | 1191583  | 32-2000SG Bail Spring                   |
| 34      | 1313815  | 34-CFT2500 Bail Arm                     |
| 34C     | 1313816  | 34C-CFT2500 Pivot Arm                   |
| 35      | 1324189  | 35-BTLII2000 Line Roller                |
| 35A     | 1313818  | 35A-CFT2500 Line Roller Bushing         |
| 36      | 1251748  | 36-1000FRC Bail Stud Screw              |
| 38      | 1191727  | 38-2000SG Rotor Nut                     |
| 38A     | 1324171  | 38A-BTLII4000 Rotor Locking Plate Screw |
| 38D     | 1308070  | 38D-CFT3000 Rotor Nut Washer            |
| 39      | 1313819  | 39-CFT2500 Main Shaft                   |
| 40B     | 1191778  | 40B-2000SG Click Ratchet                |
| 41      | 1211573  | 41-2000BTL Spool Bushing                |
| 42      | 1249042  | 42-1000BTL Spool Shaft Washer           |
| 43      | 1313820  | 43-CFT2500 Crosswind Block              |
| 43A     | 1191818  | 43A-3000SG Crosswind Block Plate        |
| 43B     | 1191826  | 43B-3000SG Crosswind Block Plate Screw  |
| 44      | 1191843  | 44-3000SG Crosswind Block Screw         |
| 45      | 1324198  | 45-BTLII2500 Housing Cover Assembly     |
| 46      | 1191901  | 46-3000SG Housing Cover Screw (3 req)   |
| 46B     | 1191907  | 46B-3000SG Housing Cover Washer (3 req) |
| 47      | 1324199  | 47-BTLII2500 Spool Assembly             |
| 48      | 1211604  | 48-3000SG Click Tongue                  |
| 48A     | 1214226  | 48A-3000SG Click Tongue Washer          |
| 48B     | 1211591  | 48B-3000BTL Spool Click Screw           |
| 49      | 1211605  | 49-3000SG Click Tongue Spring           |
| 51      | 1313823  | 51-CFT2500 Drag Retaining Ring          |
| 52      | 1324192  | 52-BTLII2000 Drag Knob Assembly         |
| 56      | 1313825  | 56-CFT2500 Drag Washer (2 req)          |
| 57      | 1192041  | 57-2000SG Keyed Washer (2 req)          |
| 60      | 1192059  | 60-2000SG Thrust Washer                 |
| 95B     | 1308081  | 95B-CFT3000 Rotor Locking Plate         |
| 97      | 1192189  | 97-2000SG Clutch Spring                 |
| 98C     | 1192211  | 98C-2000SG Clutch/Sleeve Assembly       |
| 98W     | 1192229  | 98W-3000SG Upper Clutch Washer          |
| 98W     | 1204004  | 98W-3000PUR Lower Clutch Washer         |
| 132     | 1364008  | 132-BTLII2500 Roller Washer             |
| 132A    | 1192301  | 132A-2000SG Line Roller Washer (2 req)  |
| 226     | 1313827  | 226-CFT2500 Rear Cover                  |
| 226A    | 1192473  | 226A-3000SG Rear Cover Screw            |
| 231     | 1313828  | 231-CFT2500 Crosswind Gear              |
| 233     | 1211608  | 233-3000BTL Bearing Cover Assembly      |

407-BTLII2500 Rev.1 7-25-14

1338217