

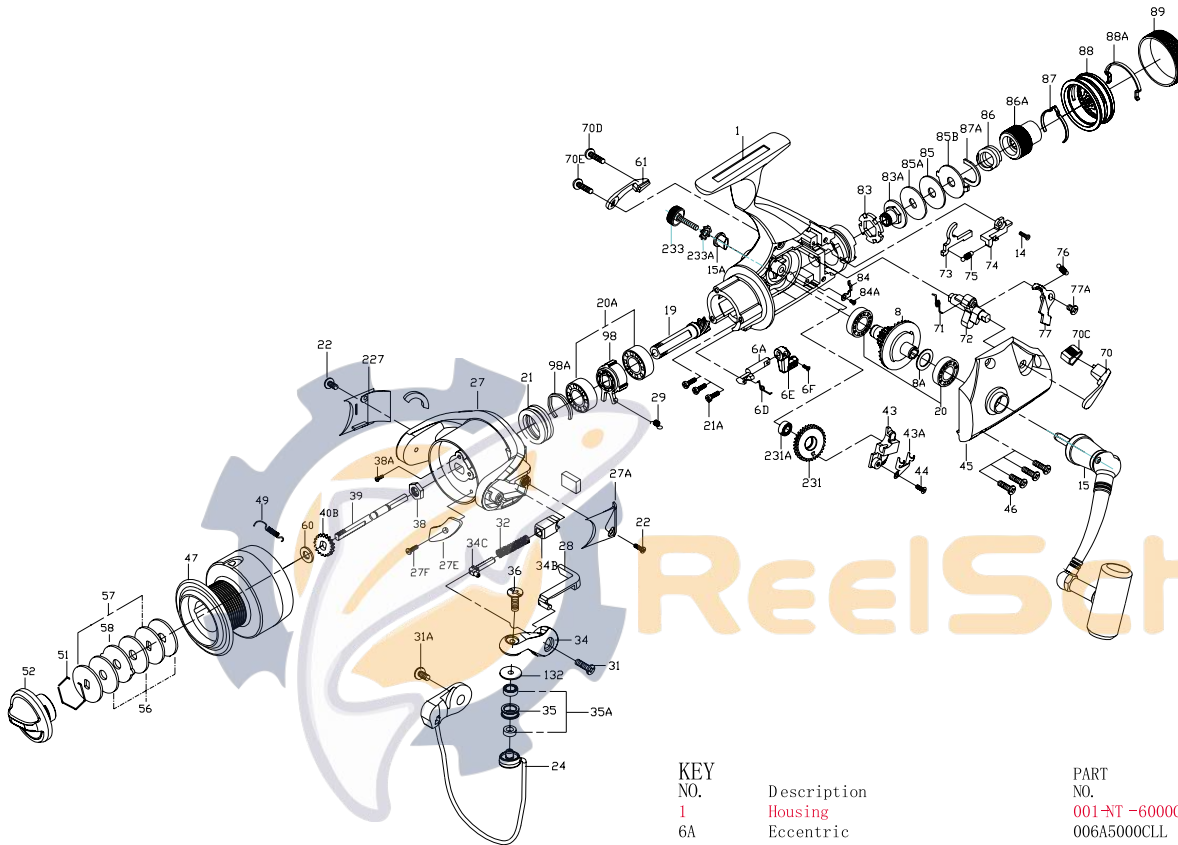

PARTS LIST FOR MODEL CLL6000



KEY

KEY NO.	Description	PART NO.
1	Housing	001-NT-6000CLL
6A	Eccentric	006A5000CLL
6D	Eccentric Spring	006D4000CLL
6E	Eccentric Lever	006E5000CLL
6F	Eccentric Lever Mounting Screw	006F5000CLL
8	Main Gear Assembly	0085000CLL
8A	Main Gear Shim	008A5000CV
14	Screw	0145000CLL
15	Handle Assembly	015N6000CV
15A	Handle Retaining Bushing	015A500CV
19	Pinion Gear	0195000CLL
20	Housing Ball Bearing (2 req.)	020500CV
20A	Pinion Ball Bearing (2 req.)	020A5000CV
21	Collar	0215000CV
21A	Bearing Mounting Screws (3 req.)	021A2000CV
22	Cover Screw (2 req.)	022500CV
24	Bail Wire	0246000CV
27	Rotor Cup	027000CV
27A	Bail Pivot Cover	027A5000CV
27E	Balance Weight	027E5000CV
27F	Balance Weight Screw	027F2000CV

KEY NO.	Description	PART NO.
28	Trip Lever	0286000CV
29	Spring	0295000CV
31	Bail Arm Screw	0312000CV
31A	Bail Wire Screw	031A2000CV
32	Bail Spring	0324000CV
34	Bail Arm	0345000CV
34B	Pivot Guide	034B5000CV
34C	Pivot Arm	034C4000CV
35	Line Roller	0352000CV
35A	Line Roller Ball Bearing (2 req)	035A2000CV
36	Bail Stud Screw	0362000CV
38	Rotor Nut	0385000CV
38A	Rotor Nut Screw	038A2000CV
39	Spool Shaft	0395000CLL
40B	Click Ratchet	040B5000CV
43	Crosswind Block	0435000CLL
43A	Spool Shaft Clip	043A5000CLL
44	Crosswind BlockScrew	0442000CV
45	Housing Cover	045-NT-6000CLL
46	Housing Cover Screws (4 req.)	0465000CV
47	Spool Assembly	0476000CLL
49	Click Spring	0492000CV
51	Retaining Ring	0512000CV
52	Drag Knob	0525000CV
56	Friction Drag Washer (3 req)	0562000CV
57	Keyed Washer (2 req)	0575000CV
58	Drag Washer Earred	0582000CV
60	Thrust Washer	0605000CLL
70	L. S. Liveline Eccentric Lever	0705000CLL
70B	R. S. Liveline Eccentric Lever	070B5000CLL
70C	(Mid) Liveline Eccentric Lever	070C5000CLL
70D	Liveline Eccentric Lever Screw	070D4000CLL
70E	Liveline Eccentric Lever Screw	070E4000CLL
71	Liveline Liveline Eccentric Spring	0714000CLL
72	Liveline Eccentric	0725000CLL
73	Liveline Plate	0735000CLL
74	Liveline Dog	0745000CLL
75	Dog Spring	0755000CLL
76	Trip Spring	0764000CLL
77	Eccentric Trip	0774000CLL
77A	Eccentric Trip Screw	077A4000CLL
83	Rear Drag Ratchet	0835000CLL
83A	Rear Ratchet Insert	083A5000CLL
84	Rear Drag Click	0845000CLL
84A	Click Spring Screw	084A4000CLL
85	Rear Drag Washer	0855000CLL
85A	Rear Keyed Washer	085A5000CLL
85B	Rear Earred Washer	085B5000CLL
86	Rear Drag Spring	0865000CLL
86A	Rear Drag Nut	086A5000CLL
87	Rear Click Spring	0875000CLL
87A	Rear Drag Retainer	087A5000CLL
88	Rear Drag Knob	0885000CLL
88A	Rear Drag Knob Retainer	088A5000CLL
89	Rear Drag Knob Grip	0895000CLL
98	Clutch Retainer	0985000CLL
98A	Clutch Clip	098A5000CLL
132	Roller Washer	1322000CV
227	Cam Cover	2275000CV
231	Crosswind Gear	2315000CLL
231A	Crosswind Gear Ball Bearing	020500CV
233	Bearing Cover	233N2000CV
233A	Handle Cap Washer	233A2000CV