

DO NOT USE THIS SHEET! SEE 407-460L-560L

PENN PARTS LIST FOR MODELS 4600L AND 5600L

NOTE: DO NOT USE THIS SHEET FOR PART IDENTITY!
 Models 4600L and 5600L Liveliners have been renamed to models **460L** and **560L** Slammer Liveliners.
 Please see sheet number **407-460L-560L** for current part number identification. Thank You.

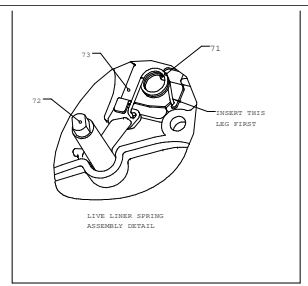
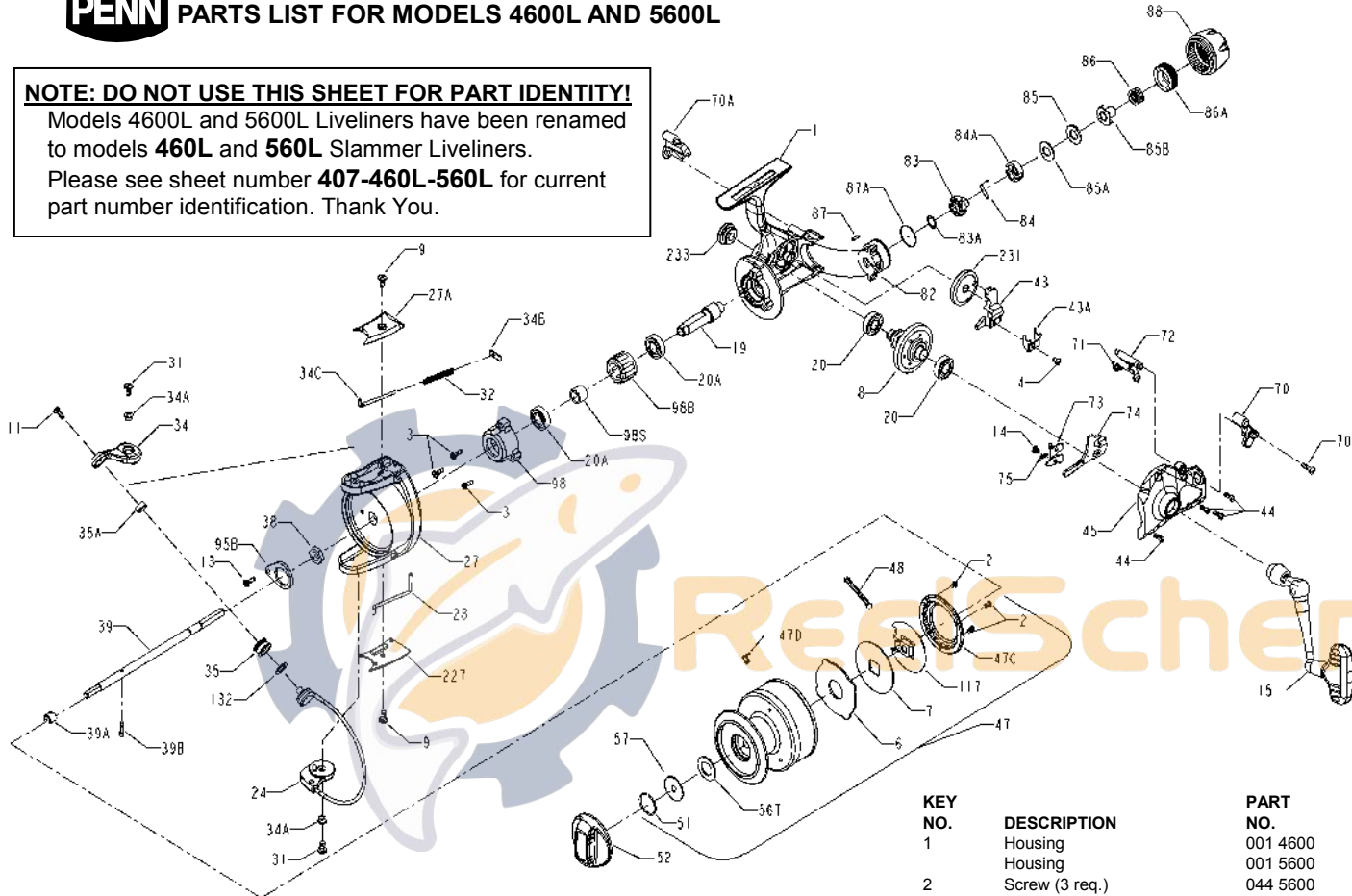

NOT ALL PARTS ARE AVAILABLE

KEY NO.	DESCRIPTION	PART NO.	KEY NO.	DESCRIPTION	PART NO.
32	Bail Spring	032 5600	70	Live Liner Eccentric Lever (Left)	070 5600
34	Bail Arm	034 5600	70A	Live Liner Eccentric Lever (Right)	070A5600
34A	Rotor Bushing (2 req.)	034A5600	70C	Screw	070C5600
34B	Pivot Plate	034B5600	71	Live Liner Eccentric Spring	071 5600
34C	Pivot Arm	034C5600	72	Live Liner Eccentric	072 5600
35	Line Roller	035 5600	73	Live Liner Plate	073 5600
35A	Ball Bearing	035A706	74	Live Liner Dog	074 5600
38	Rotor Nut	038 5600	75	Live Liner Dog Spring	075 5600
39	Spool Shaft	039 5600	82	Rear Housing	082 5600
39A	Locating Pin Clip	039A5600	83	Rear Drag Ratchet	083 5600
39B	Locating Pin	039B5600	83A	Rear Drag Ratchet Washer	083A5600
43	Crosswind Block	043N5600	84	Rear Drag Click Spring	084 5600
43A	Spool Shaft Clip	043A5600	84A	Rear Drag Click Retainer	084A5600
44	Screw (4 req.)	039 004CH	85	Rear Drag Washer	085 5600
45	Housing Cover	045 4600	85A	Rear Keyed Washer	085A5600
45	Housing Cover	045 5600	85B	Rear Eared Washer	085B5600
47	Spool (Complete)	047 4600	86	Rear Drag Spring	086 5600
47	Spool (Complete)	047 5600	86A	Rear Drag Nut	086A5600
47C	Drag Cover	047C5600	87	Rear Click Pin	087 5600
47D	Line Clip	047D5600	87A	Rear Click Pin Ring	087A5600
48	Click Tongue	048 5600	88	Rear Drag Knob	088 5600
51	Retaining Ring	051 650	95B	Rotor Locking Plate	095B070
52	Drag Knob Assembly	052 5600	98	Clutch Retainer	098 5600
56T	Drag Washer (Teflon)	056T650	98B	Bearing	098B5600
57	Drag Washer (Keyed)	057 5600	98S	Clutch Bearing Sleeve	098S5600
70	Live Liner Eccentric Lever (Left)	070 5600	117	Drive Plate	117 5600
70A	Live Liner Eccentric Lever (Right)	070A5600	132	Line Roller Washer	132 5600
70C	Screw	070C5600	227	Bail Trip Cover	227 5600
71	Live Liner Eccentric Spring	071 5600	231	Crosswind Gear	231N5600
72	Live Liner Eccentric	072 5600	233	Bearing Cover	233 5600
73	Live Liner Plate	073 5600			
74	Live Liner Dog	074 5600			
75	Live Liner Dog Spring	075 5600			
82	Rear Housing	082 5600			
83	Rear Drag Ratchet	083 5600			
83A	Rear Drag Ratchet Washer	083A5600			
84	Rear Drag Click Spring	084 5600			
84A	Rear Drag Click Retainer	084A5600			
85	Rear Drag Washer	085 5600			
85A	Rear Keyed Washer	085A5600			
85B	Rear Eared Washer	085B5600			
86	Rear Drag Spring	086 5600			
86A	Rear Drag Nut	086A5600			
87	Rear Click Pin	087 5600			
87A	Rear Click Pin Ring	087A5600			
88	Rear Drag Knob	088 5600			
95B	Rotor Locking Plate	095B070			
98	Clutch Retainer	098 5600			
98B	Bearing	098B5600			
98S	Clutch Bearing Sleeve	098S5600			
117	Drive Plate	117 5600			
132	Line Roller Washer	132 5600			
227	Bail Trip Cover	227 5600			
231	Crosswind Gear	231N5600			
233	Bearing Cover	233 5600			
1	Housing	001 4600			
1	Housing	001 5600			
2	Screw (3 req.)	044 5600			
3	Screw (3 req.)	044 710			
6	Main Drag Washer HT-100	006 5600			
7	Main Keyed Drag Washer	007 5600			
8	Gear	008 5600			
9	Screw (2 req.)	022 750			
11	Screw	036 5600			
13	Screw	063A2.5FR			
14	Screw (2 req.)	044 4400			
15	Handle (4600L) Assembly	015 460			
15	Handle (5600L) Assembly	015 560			
19	Pinion	019 5600			
20	Ball Bearing (2 req.)	020 722			
20A	Ball Bearing (2 req.)	020 6500			
24	Bail Wire	024 4600			
24	Bail Wire	024 5600			
27	Rotor Cup	027 4600			
27	Rotor Cup	027 5600			
27A	Bail Pivot Cover	027A5600			
28	Trip Lever	028 5600			
31	Screw (2 req.)	036 750			