

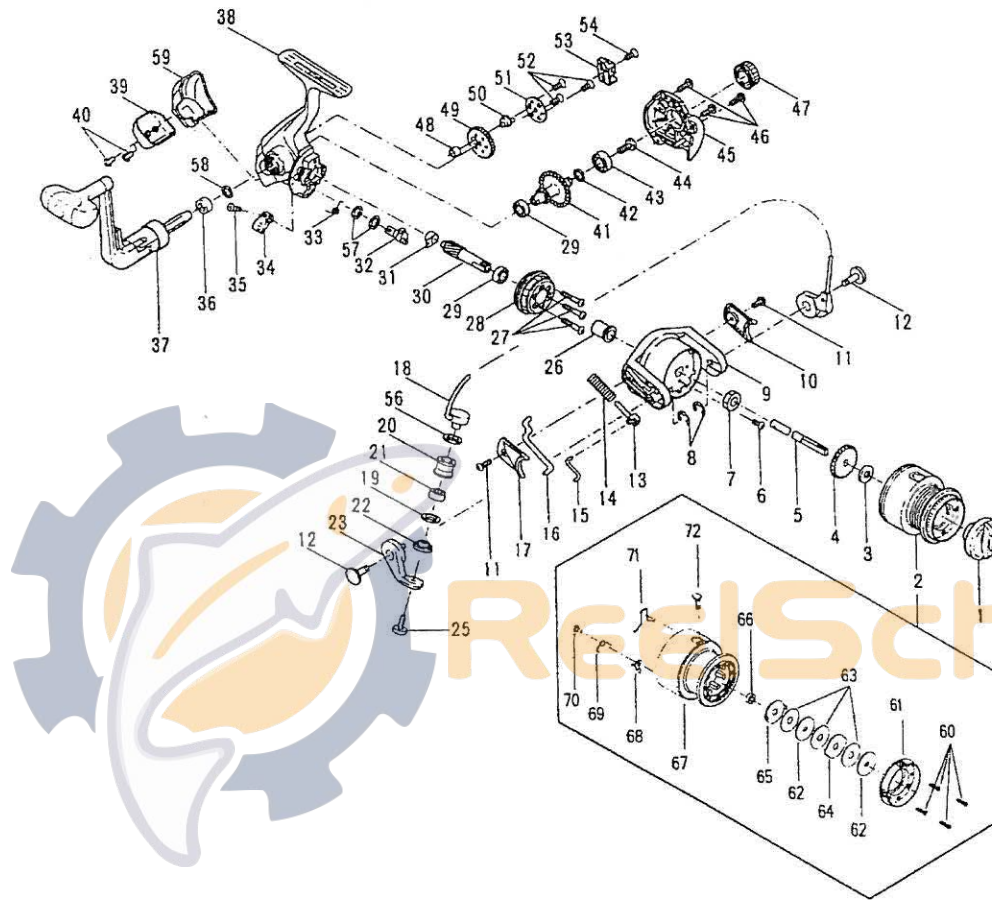

MODEL PRION 900



NOT ALL PARTS ARE AVAILABLE

PARTS LIST FOR MODEL 900

KEY NO.	PART NO.	DESCRIPTION
1	052 900	Drag Knob Asm.
2	047 900	Spool Assembly
3	060 1000	Thrust Washer
4	040B1000	Click Ratchet
5	039 900	Spool Shaft
6	038A900	Rotor Nut Lock Screw
7	038 1000	Rotor Nut
8	037 900	E-Ring (2)
9	027 900	Rotor
10	227 900	Rotor Cover 'B'
11	050 1000	Cover Screw (2)
12	031A900	Trip Arm Screw (2)
13	034B1000	Pivot Shaft

KEY NO.	PART NO.	DESCRIPTION
14	052 900	Pivot Spring
15	047 900	Pivot Arm
16	060 1000	Pivot Arm Kick Lever
17	040B1000	Rotor Cover 'A'
18	039 900	Bail Wire Assembly
19	038A900	Washer
20	038 1000	Line Roller
21	037 900	Line Roller Ball Brg.
22	027 900	Line Roller Collar
23	227 900	Bail Arm
25	050 1000	Line Roller Screw
26	031A900	Spacer
27	034B1000	Screw (3)
28	052 900	One Way Clutch
29	047 900	Ball Bearing (2)
30	060 1000	Pinion Gear
31	040B1000	Rear Pinion Bushing
32	039 900	Anti-Reverse Lever Cam
33	038A900	Anti-Reverse Lever Spring
34	038 1000	Anti-Reverse Lever
35	037 900	Lever Mtg. Screw
36	027 900	Handle Spacer
37	227 900	Handle Assembly
38	001 900	Main Body
39	001A900	Housing Protector
40	001C900	Housing Protector Screws (2)
41	008 900	Main Gear
42	008A1000	Main Gear Shim
43	055 895	Ball Bearing
44	009A1000	Handle Retaining Screw
45	002A900	Side Plate
46	046 1000	Screw (3)
47	233 900	Bearing Cover
48	231A900	Crosswind Cam Collar
49	231 900	Crosswind Gear
50	231B900	Crosswind Cam
51	231C900	Crosswind Pressure Plate
52	231D900	Crosswind Gear Screw (3)
53	043 900	Crosswind Block
54	044 900	Crosswind Block Screw
56	008A1500	Upper Roller Washer
57	028C900	Washer (2)
58	015B900	Washer
59	001B900	Housing Cover
60	051A900	Drag Cover Screw (4)
61	051 900	Drag Cover
62	057 900	Keyed Drag Washer (2)
63	006 900	Drag Washer (3)
64	058 900	Eared Drag Washer
65	058A900	Eared Drag Washer
66	035A900	Spool Ball Bearing
67	047C900	Spool (Only)
68	048 900	Click Tongue
69	048C900	Click Spring
70	048B900	Click Screw
71	047B900	Line Clip Retainer
72	047A900	Line Clip
**	047F900	Spool Flange
**	051B900	Spool Flange Screw (4)

**Not Shown