

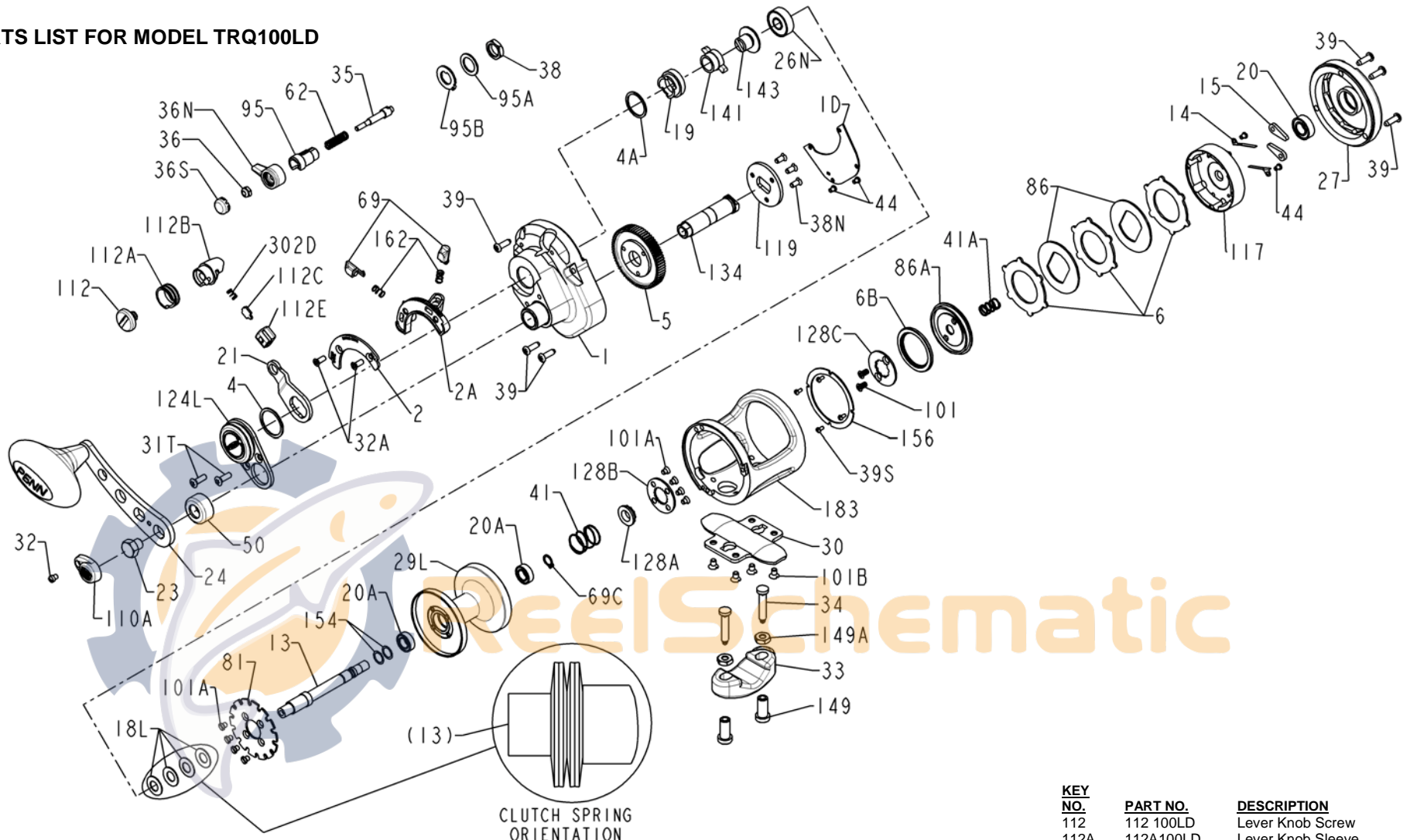

# PARTS LIST FOR MODEL TRQ100LD



KEY NO.	PART NO.	DESCRIPTION
1	001 100LD	Right Side Plate
1D	001D100T	Backing Plate
2	002 100LD	Drag Lever Quadrant
2A	002A100LD	Drag Lever Ratchet
4	004 012LT	Drag Lever Thrust Washer
4A	004 300LD	Cam Thrust Washer
5	005 100LD	Main Gear
6	006 100LD	Drag Washer (3 Req)
6B	006B100LD	Drag Engagement Washer
13	013 100LD	Pinion
14	014 100LD	Dog Spring (2 Req)
15	015 100LD	Anti-Reverse Dog (2 Req)
18L	018L300LD	Clutch Spring (4 Req)
19	019 300LD	Cam
20	020 722	Left Side Ball Bearing
20A	020 4200	Spool Ball Bearing (2 Req)

KEY NO.	PART NO.	DESCRIPTION
21	021 100LD	Drag Lever
23	023 300LD	Handle Screw
24	024 200LD	Handle Assembly
26N	026N025	Right Side Ball Bearing
27	027 100LD	Left Side Plate
29	029L100LD	Spool
30	030 016VS	Stand
31T	031T070	Screw (2 Req)
32	032 015	Handle Cap Screw
32A	032 100LD	Quadrant Screw (2 Req)
33	033 113	Rod Clamp
34	034 016VS	Rod Clamp Screw (2 Req)
35	035 100LD	Click Tongue
36	036 700	Click Button Nut
36N	036N050	Click Button
36S	036S080ST	Click Button Cap
38	038 710	Click Bushing Nut
38N	038N007	Coupling Plate Screw (3 Req)

KEY NO.	PART NO.	DESCRIPTION
39	039 300LD	Left Side Screw (6 Req)
39S	039S965	Drag Cover Screw (4 Req)
41	041 100LD	Drive Clutch Spring
41A	041A100LD	Drag Disengagement Spring
44	044 300T	Screw (4 Req)
50	050 025	Gear Stud Shield
62	062 300LD	Click Spring
69	069 012VS	Locating Pin (2 Req)
69C	069C015KG	Retaining Ring
81	081 100LD	Click Ratchet Plate
86	086 100LD	Keyed Drag Washer (2 Req)
86A	086A100LD	Drag Bushing
95	095 100LD	Click Bushing
95A	095A020	Click Bushing Washer
95AB	095AB050	Click Locking Plate
101	101 030	Mounting Screw (2 Req)
101A	101 050S	Mounting Screw (8 Req)
101B	101 080ST	Stand Screw (4 Req)
110	110A555	Handle Screw Cap

KEY NO.	PART NO.	DESCRIPTION
112	112 100LD	Lever Knob Screw
112A	112A100LD	Lever Knob Sleeve
112B	112B100LD	Lever Knob
112C	112C030VS	Click Plate
112E	112E100LD	Lever Click Housing
117	117 100LD	Drag Housing
119	119 050	Coupling Plate
124L	124L100LD	Bridge Cover Assembly
128A	128A100LD	Driver
128B	128B100LD	Drive Plate
128C	128C100LD	Driver Retainer
134	134 200LD	Gear Stud
141	141 300LD	Cam Follower
143	143 300LD	Adjusting Screw
149	149 045	Rod Clamp Nut (2 Req)
149A	149 200	Hex Nut (2 Req)
154	154 100LD	Spool Shim (2 as Required)
156	156 100LD	Drag Housing Cover
162	162 100LD	Locating Pin Spring (2 Req)
183	183 100LD	Frame
183	183 100LDE	Frame (for European models)
302D	302D525MAG	Lever Knob Spring