

# QUANTUM

## Array AR40F

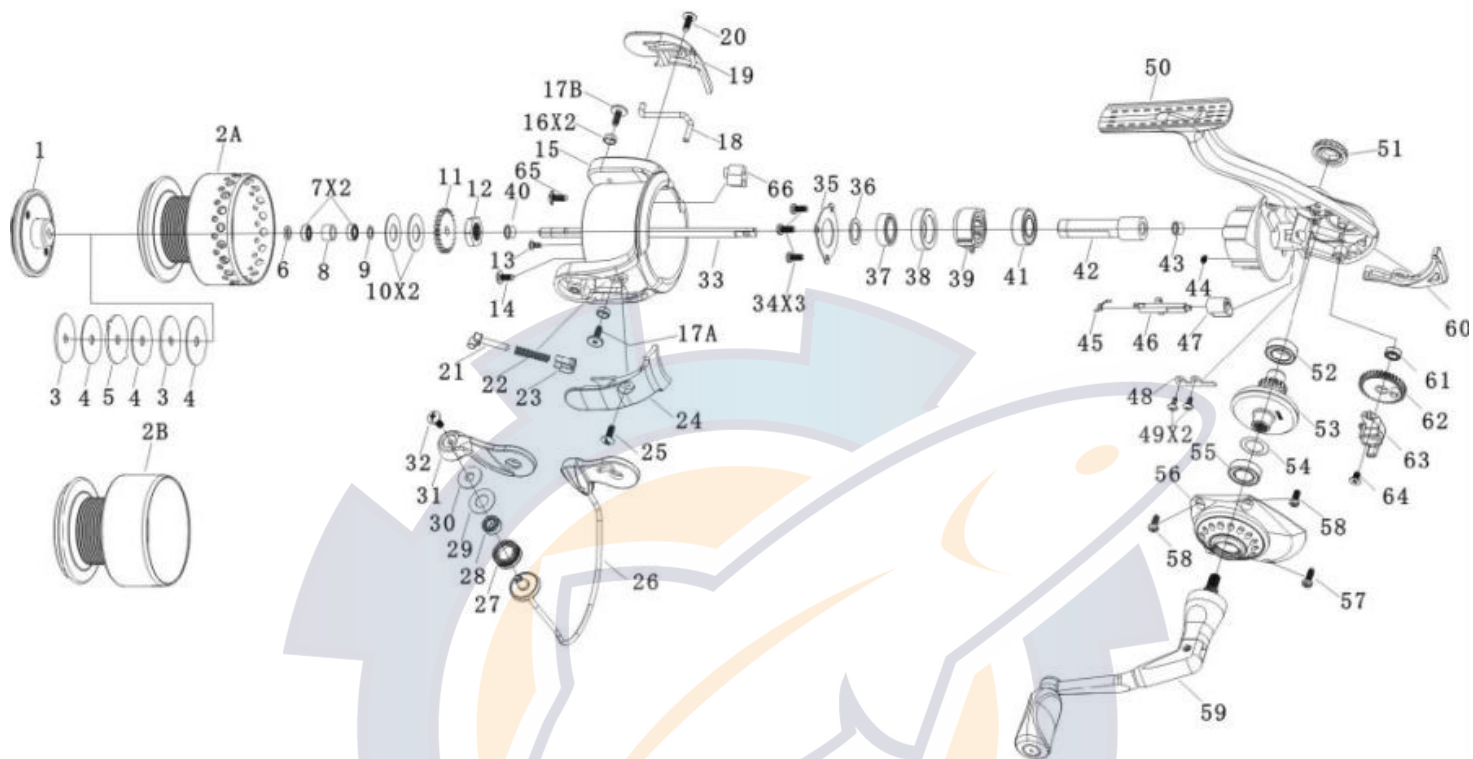

Quantum Array AR40F Part List

| Key No. | Description             | AR40F     | Key No. | Description               | AR40F     |
|---------|-------------------------|-----------|---------|---------------------------|-----------|
| 1       | DRAG KNOB ASSEMBLY      | SP332-02  | 33      | MAIN SHAFT                | SP015-01  |
| 2A      | SPOOL ASSEMBLY          | SP321-52  | 34      | STACK RETAINER SCREW      | SP057-02  |
| 2B      | SPARE SPOOL ASSEMBLY    | SP321-53  | 35      | CLUTCH STACK RETAINER     | SP040-51  |
| 3       | DRAG WASHER "A"         | RQ081-01  | 36      | ROTOR WASHER              | SP110-01  |
| 4       | DRAG WASHER "B"         | RQ033-01  | 37      | CLUTCH BEARING            | SP028-01  |
| 5       | DRAG WASHER "C"         | RQ080-01  | 38      | CLUTCH BEARING ADAPTER    | SP190-01  |
| 6       | SPOOL CLICKER RETAINER  | SP056-01  | 39      | CLUTCH ASSEMBLY           | SP063-01  |
| 7       | SPOOL BEARING           | N/A       | 40      | MAIN SHAFT BUSHING        | SP213-01  |
| 8       | SPOOL SLEEVE            | SP121-51  | 41      | PINION BALL BEARING       | UK028-01  |
| 9       | SPOOL BEARING WASHER    | PT120-01  | 42      | PINION GEAR               | SP011-01  |
| 10      | SPOOL ADJUST WASHER     | PT030-02  | 43      | PINION BUSHING            | SP141-01  |
| 11      | CLICK GEAR              | RQ037-01  | 44      | CLUTCH SPRING             | SP216-01  |
| 12      | ROTOR NUT               | SP006-01  | 45      | STOPPER CAM SPRING        | SP089-01  |
| 13      | ROTOR NUT LOCK SCREW    | SP094-01  | 46      | STOPPER CAM               | SP090-01  |
| 14      | COUNTER WEIGHT SCREW    | GU077-01A | 47      | STOPPER LEVER             | SP059-01  |
| 15      | ROTOR                   | SP009-52  | 48      | O/S SLIDER GUIDE          | SP078-01  |
| 16      | BAIL PIVOT BUSHING      | SP109-01  | 49      | SLIDER GUIDE SCREW        | RK094-01  |
| 17A     | BAIL PIVOT SCREW "A"    | SP164-01  | 50      | BODY                      | SP301-52  |
| 17B     | BAIL PIVOT SCREW "B"    | SP164-01  | 51      | HANDLE SCREW CAP ASSEMBLY | SP249-01  |
| 18      | KICK LEVER              | SP019-01  | 52      | BODY BALL BEARING         | BL157-01  |
| 19      | BAIL HOLDER SIDE COVER  | SP024-02  | 53      | DRIVE GEAR                | SQ012-01  |
| 20      | BAIL HOLDER COVER SCREW | GU077-02  | 54      | D.GEAR ADJUST WASHER      | GU105-08  |
| 21      | BAIL SPRING SHAFT       | SP031-01  | 55      | BODY COVER BALL BEARING   | BL157-01  |
| 22      | BAIL SPRING             | NO022-01  | 56      | BODY COVER                | SP123-02  |
| 23      | TRIP PIVOT              | SP113-01  | 57      | BODY COVER SCREW "A"      | SP057-02  |
| 24      | ARM LEVER COVER         | SP087-02  | 58      | BODY COVER SCREW "B"      | SP057-01  |
| 25      | A/L COVER SCREW         | GU077-02  | 59      | HANDLE ASSY               | SP318-01  |
| 26      | BAIL ASSEMBLY           | SP347-52  | 60      | BODY REAR COVER           | SP142-52  |
| 27      | LINE ROLLER             | CH004-01  | 61      | O/S GEAR BALL BEARING     | EH158-01  |
| 28      | LINE ROLLER BEARING     | GH202-01  | 62      | O/S GEAR                  | TQ053-51  |
| 29      | LINE ROLLER SLEEVE      | DH102-01  | 63      | O/S SLIDER                | SP025-01  |
| 30      | LINE ROLLER BUSHING     | CH102-01  | 64      | MAIN SHAFT SCREW          | RQ100-01  |
| 31      | ARM LEVER               | SP007-02  | 65      | COUNTER WEIGHT SCREW      | GU077-01A |
| 32      | LINE ROLLER SCREW       | AQ108-C   | 66      | ROTOR COUNTER WEIGHT      | SP148-51  |