

QUANTUM.

ST1F / SX1B

SPECIFICATIONS :

Ultra Lt. FW
 125 yds / 4 lb Line Capacity
 5.3:1 Gear Ratio
 22.9" Retrieve Rate (inches per turn)
 8.1 oz.
 Ball Bearings:
 ST1F - 5 B.B.
 SX1B - 4 B.B.

FEATURES :

Front Drag
 Tru-Balanced Rotor
 Balanced Handle
 Snapshot II (Firing Pin) Casting System
 Oversized Twist Reducer Line Roller BB
 Selective On/Off (1Stop-Self Center) A/R
 Geared (S-Curve) O/S System
 Aluminum Spool w/ holes in skirt
 Spare Graphite Spool
 Color:
 ST1F - 5 B.B.
 SX1B - 4 B.B.

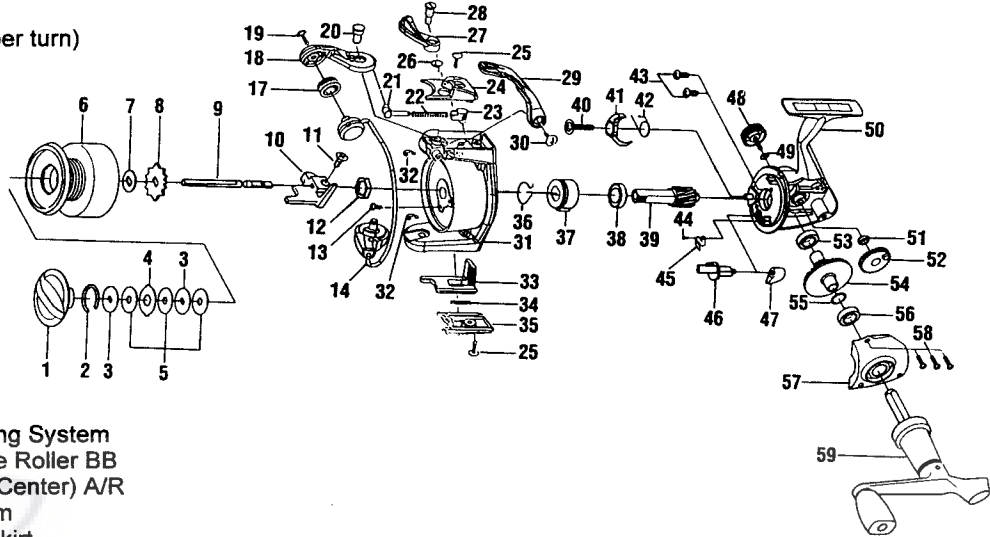

ReelSchematic

Key No.	Part No.	ST1F	SX1B	Description	Price	Key No.	ST1F	SX1B	Description	Price
1	RH332-03		RH332-04	Drag Knob Assy.		32	GH034-01	←	E-Clip	
2	RH038-01		←	Spool Retainer		33	RH019-01	←	Kick Lever	
3	RH080-01		←	Drag Washer "D"		34	KQ049-01	←	Kick Lever Spring	
4	RH081-01		←	Drag Washer "A"		35	RH024-03		Kick Lever Cover	
5	RH033-01		←	Drag Washer "B"		36	RH119-01	←	Slider Spring "A"	
6	RH321-03		RH321-04	Spool Assy.		37	RH060-01	←	Ratchet	
7	XH030-01		←	Spool Adj. Washer		38	RH028-01	←	Pinion Ball Bearing	
8	RH037-01		←	Click Gear		39	RH011-01	←	Pinion Gear	
9	RH015-01		←	Main Shaft		40	RH077-01	←	Stopper Screw	
10	RH025-01		←	Oscillator Slider		41	RH063-01	←	Stopper	
11	XH100-01		←	Main Shaft Screw		42	RH061-01	←	Stopper Spring	
12	GU006-01		←	Rotor Nut		43	RH041-01	←	Bearing Screw	
13	GU077-08		←	Rotor Nut Lck. Scrw.		44	TH146-01	←	Stopper Cam Screw	
14	RH347-03		RH347-04	Bail Assy.		45	RH089-01	←	Stopper Cam Spring	
17	BH004-02		←	Line Roller B.B.		46	RH090-01	←	Stopper Cam	
18	RH007-03		RH007-04	Arm Lever		47	TH059-01	←	Stopper Lever	
19	AQ108-01		←	Bail Screw		48	TH073-01	←	Handle Cap Screw	
20	TH051-01		←	Arm Lever Pin		49	TH105-01	←	Handle Cap Washer	
21	KQ031-01		←	Bail Spring Shaft		50	RH001-03		Body Assy.	
22	KQ049-05		←	Bail Spring		51	N/A		O/S Gear Bushing	
23	QL020-01		←	Bail Spring Holder		51	TH158-01		O/S Gear B.B.	
24	RH087-03		RH087-04	Bail Spring Cover		52	RH053-01	←	Oscillator Gear	
25	GU077-03		←	Cover Screw		53	BH027-01	←	Body B.B.	
26	NL096-01		←	Trigger Spring		54	RH012-01	←	Drive Gear	
27	RH398-01		←	Trigger Link Assy.		55	GU105-08	←	Drive Gear Adj. Wshr.	
28	TH113-01		←	Trigger Link Screw		56	BH027-01	←	Body Cvr. B.B.	
29	RH112-01		←	Trigger		57	RH023-03		Body Cover	
30	GU077-05		←	Trigger Screw		58	GU057-02	←	Body Cover Screw	
31	RH009-03		RH009-04	Rotor		59	RH318-02		Handle Assy.	

MODEL	EFFECTIVE DATE OF	
INTRODUCED : 1998	PARTS LIST/DIAGRAM: Sept. '98	DISCONTINUED : N/A

Prices subject to change without Zebco, P.O. Box 270, Tulsa, Ok. 74101; 918-831-6965 Phone or 800-FIXREEL (349-7335) FAX
 PLEASE ORDER BY PART NUMBER Prices do not include postage and handling.

